

# KEY MAP

REVISIONS			
DATE	BY	LIC. NO.	COMMENTS
7/12/10	JAM	29918	

## LEGEND

- COUNTY LINE
- MUNICIPAL BOUNDARY LINE
- ARTIFICIAL BLOCK LIMIT
- FORMER PROPERTY LINE
- STREAM & WATER LINES
- STREAM & WATER LINES (IF PROPERTY LINE)
- SHEET LIMIT LINE (ON KEY MAP)
- PIERHEAD LINE
- BULKHEAD LINE
- FLOOD HAZARD LINE
- BOUNDARIES OF SPECIAL TAXING DIST
- EASEMENT LINE
- BLOCK NUMBER (ON KEY MAP)
- BLOCK NUMBER
- TAX MAP SHEET NUMBER
- LOT NUMBER
- SCALED DISTANCE/ACREAGE
- DEED DISTANCE/ACREAGE
- CALCULATED DISTANCE

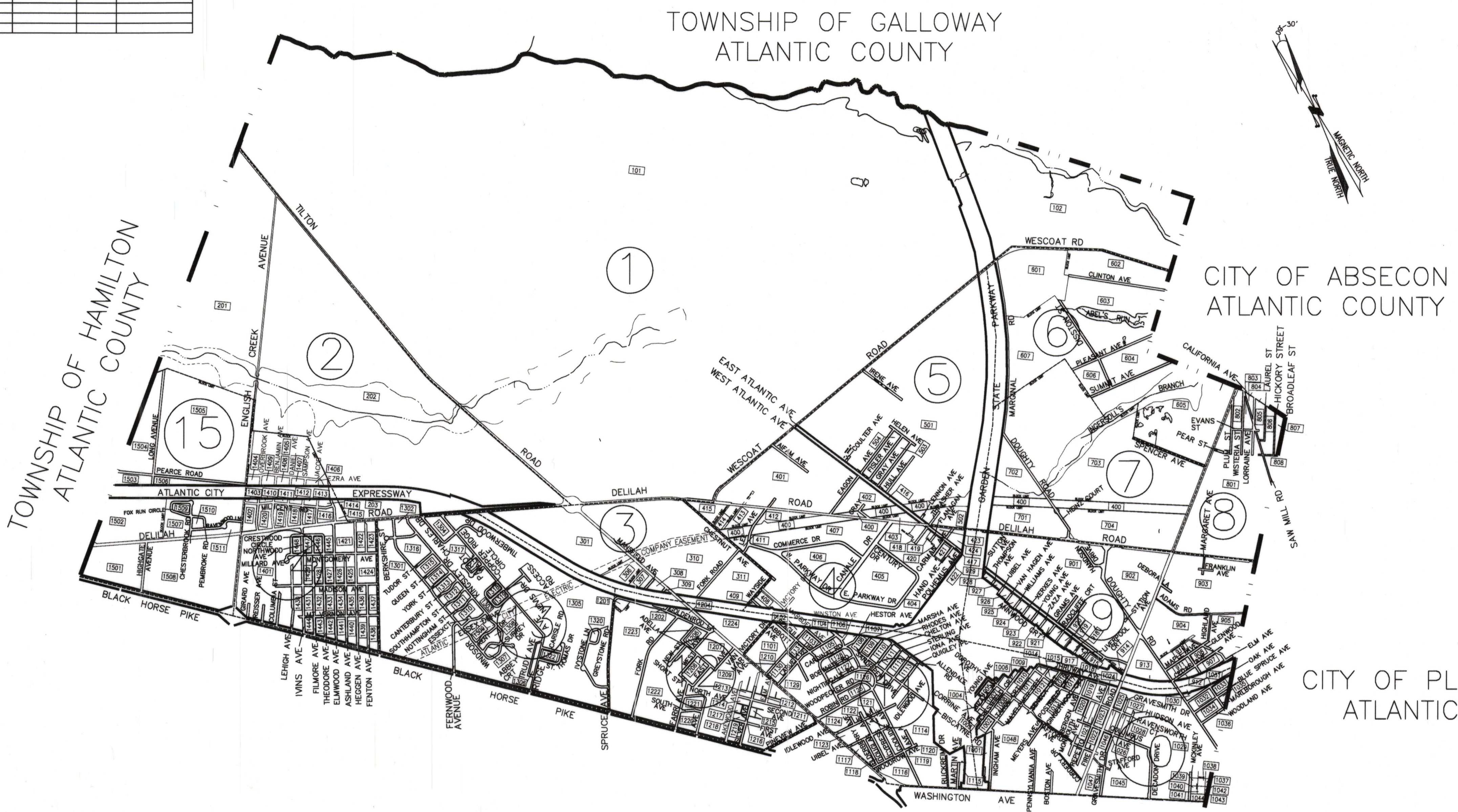

CITY OF PLEASANTVILLE  
ATLANTIC COUNTY

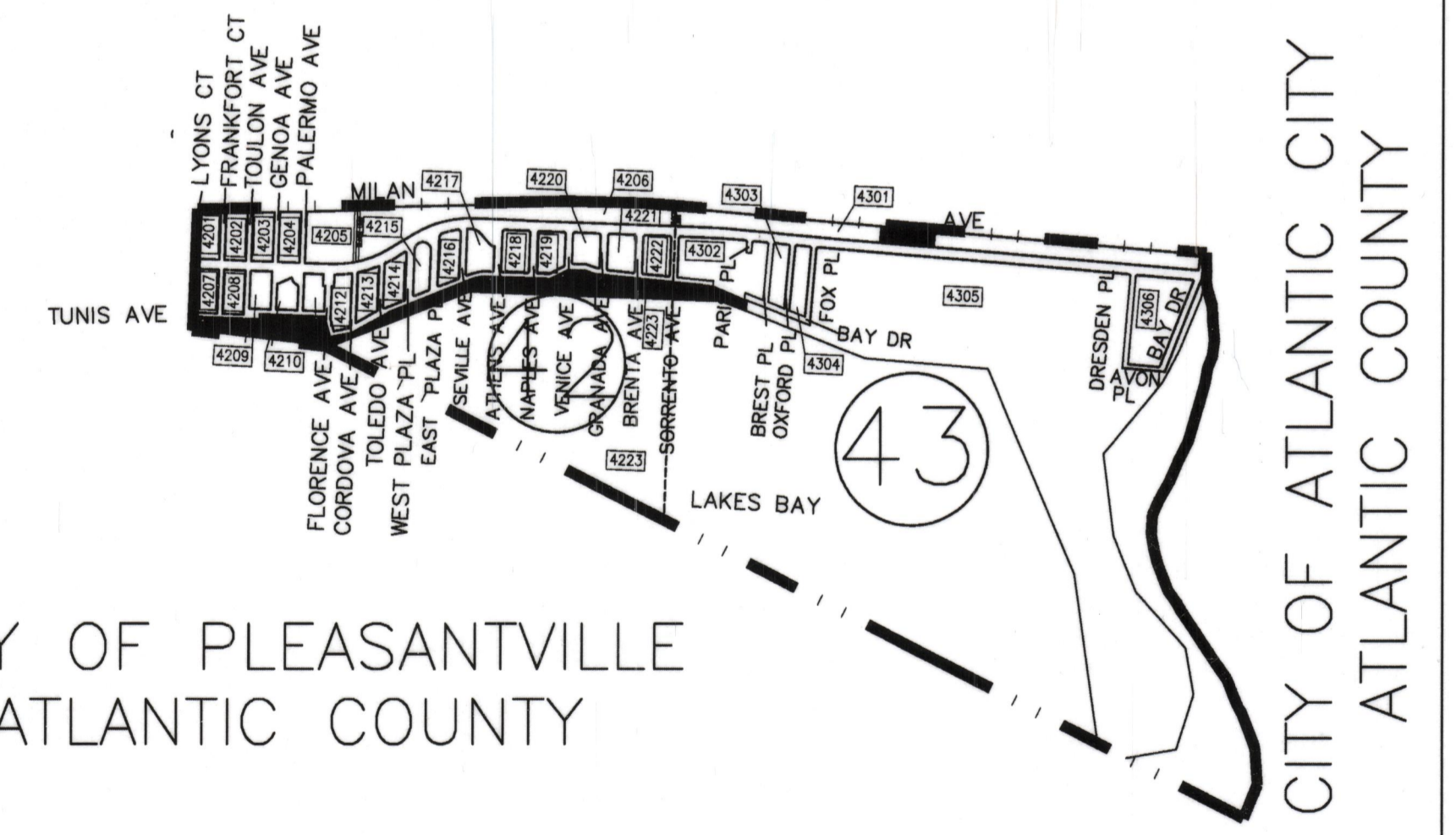

KEY MAP II

THE ORIGINAL MAP WAS MADE AND SIGNED BY CHRIS R. REHMANN, LOCENSE NUMBER 17119. IT WAS CERTIFIED BY IVAN HAFTKOWYCZ AND ASSIGNED SERIAL NUMBER 763 AND WAS DATED 8/12/1994.

I HEREBY CERTIFY THAT THIS MAP HAS BEEN REVISED UNDER MY IMMEDIATE SUPERVISION, AND COMPLIES WITH THE LAWS OF THE STATE OF NEW JERSEY.

JAMES A. MOTT, P.E. & L.S. No. 29918

THE AREAS, BOUNDARIES, AND DIMENSIONS SHOWN ON THIS MAP ARE DERIVED FROM GROUND SURVEYS, AERIAL SURVEYS AND RECORDED PLANS, MAPS, DEEDS, AND WILLS AND ARE TO BE USED FOR TAX ASSESSMENT PURPOSES ONLY.

2014



THIS SHEET HAS BEEN DRAWN USING COMPUTER AIDED DRAFTING/DESIGN (CAD/D).

TAX MAP  
TOWNSHIP OF EGG HARBOR  
ATLANTIC COUNTY, NEW JERSEY  
SCALE: 1"=1500' JANUARY 2008  
JAMES A. MOTT, PE, PLS  
PROFESSIONAL ENGINEER & LAND SURVEYOR  
NEW JERSEY LICENSE NO. 29918  
3122 FIRE ROAD  
EGG HARBOR TOWNSHIP, NJ 08234  
TO SHOW CONDITIONS AS OF JULY 12, 2010

# KEY MAP