

REVISIONS			
DATE	BY	LIC. NO.	COMMENTS
6/10/08	JAM	29918	
11/7/08	JAM	29918	
9/11/09	JAM	29918	
6/17/10	JAM	29918	
12/16/13	JAM	29918	

SHEET 29

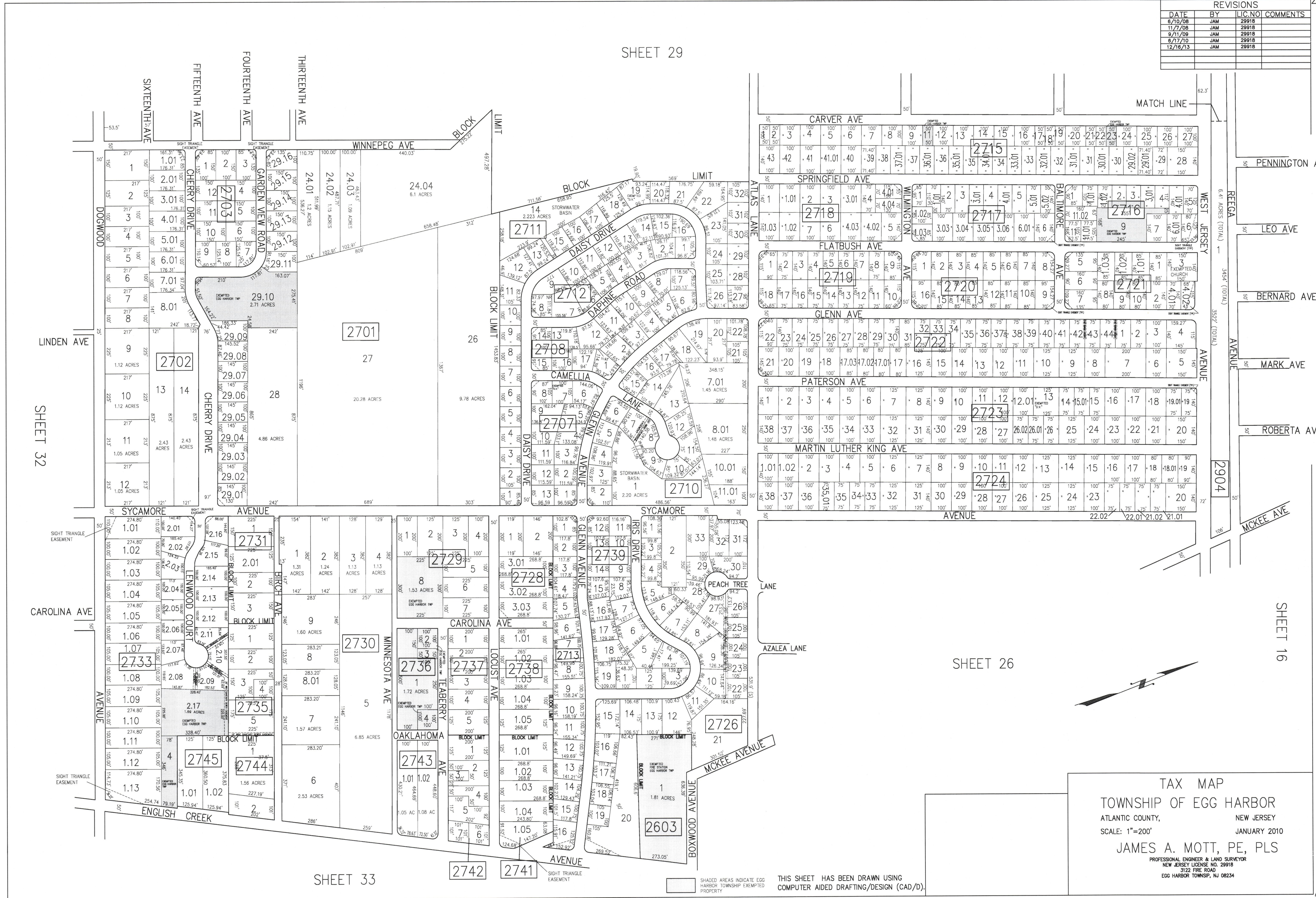

TAX MAP
 TOWNSHIP OF EGG HARBOR
 ATLANTIC COUNTY, NEW JERSEY
 SCALE: 1"=200'
 JANUARY 2010
 JAMES A. MOTT, PE, PLS
 PROFESSIONAL ENGINEER & LAND SURVEYOR
 NEW JERSEY LICENSE NO. 29918
 3122 FIRE ROAD
 EGG HARBOR TOWNSHIP, NJ 08234

THIS SHEET HAS BEEN DRAWN USING
 COMPUTER AIDED DRAFTING/DESIGN (CAD/D).

SHADED AREAS INDICATE EGG
 HARBOR TOWNSHIP EXEMPTED
 PROPERTY

SHEET 32

SHEET 33

SHEET 16

SHEET 28