

REVISIONS			
DATE	BY	LIC. NO.	COMMENTS
6/18/10	JAM	29918	
7/12/10	JAM	29918	

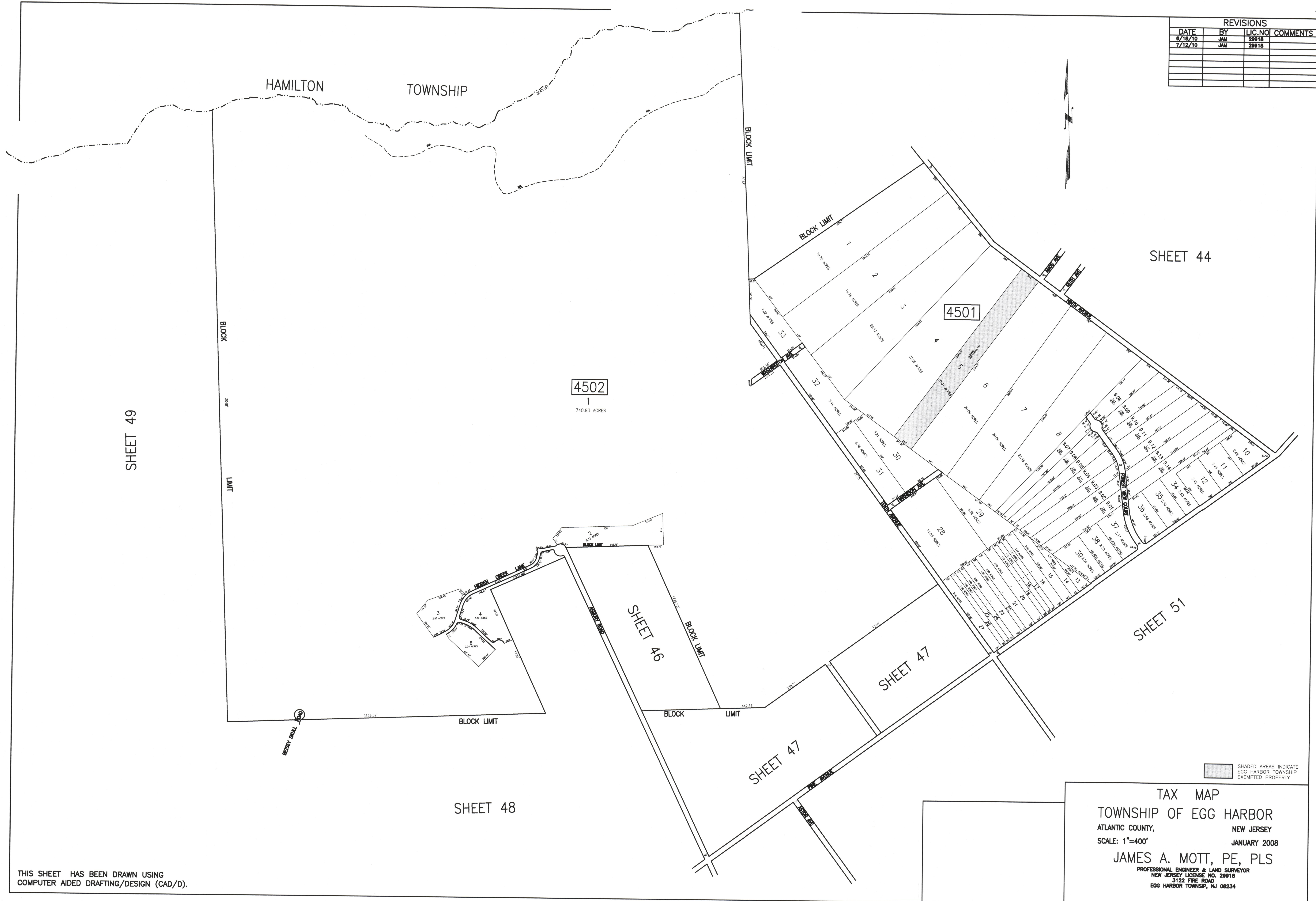

SHEET 49

SHEET 44

4502
1
740.93 ACRES

4501

SHEET 46

SHEET 47

SHEET 51

SHEET 48

THIS SHEET HAS BEEN DRAWN USING
COMPUTER AIDED DRAFTING/DESIGN (CAD/D).

SHADED AREAS INDICATE
EGG HARBOR TOWNSHIP
EXEMPTED PROPERTY

TAX MAP
TOWNSHIP OF EGG HARBOR
 ATLANTIC COUNTY, NEW JERSEY
 SCALE: 1"=400' JANUARY 2008
JAMES A. MOTT, PE, PLS
 PROFESSIONAL ENGINEER & LAND SURVEYOR
 NEW JERSEY LICENSE NO. 29918
 3122 FIRE ROAD
 EGG HARBOR TOWNSHIP, NJ 08234