

REVISIONS			
DATE	BY	LIC. NO.	COMMENTS
12/14/09	JAM	29018	
6/22/10	JAM	29018	

SHEET 55

SHEET 58

SHEET 57

SHEET 63

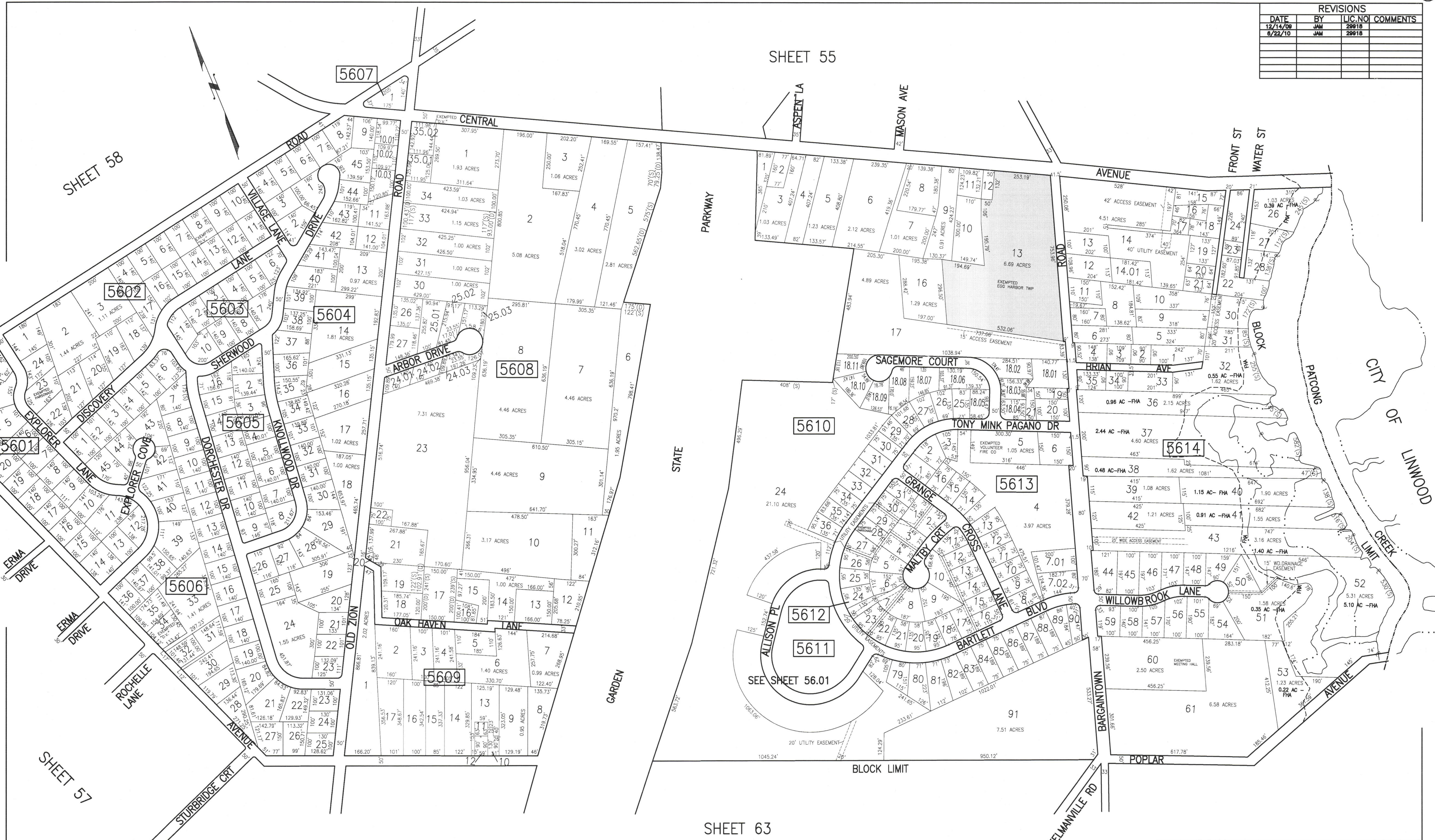

SHADED AREAS INDICATE EGG HARBOR TOWNSHIP EXEMPTED PROPERTY  
 THIS SHEET HAS BEEN DRAWN USING COMPUTER AIDED DRAFTING/DESIGN (CAD/D).

**TAX MAP**  
 TOWNSHIP OF EGG HARBOR  
 ATLANTIC COUNTY, NEW JERSEY  
 SCALE: 1"=200'  
 JANUARY 2010  
**JAMES A. MOTT, PE, PLS**  
PROFESSIONAL ENGINEER & LAND SURVEYOR  
 NEW JERSEY LICENSE NO. 29018  
 3122 FIRE ROAD  
 EGG HARBOR TOWNSHIP, NJ 08234