

REVISIONS			
DATE	BY	LIC. NO.	COMMENTS
1/22/2010	JAM	29918	
6/17/10	JAM	29918	

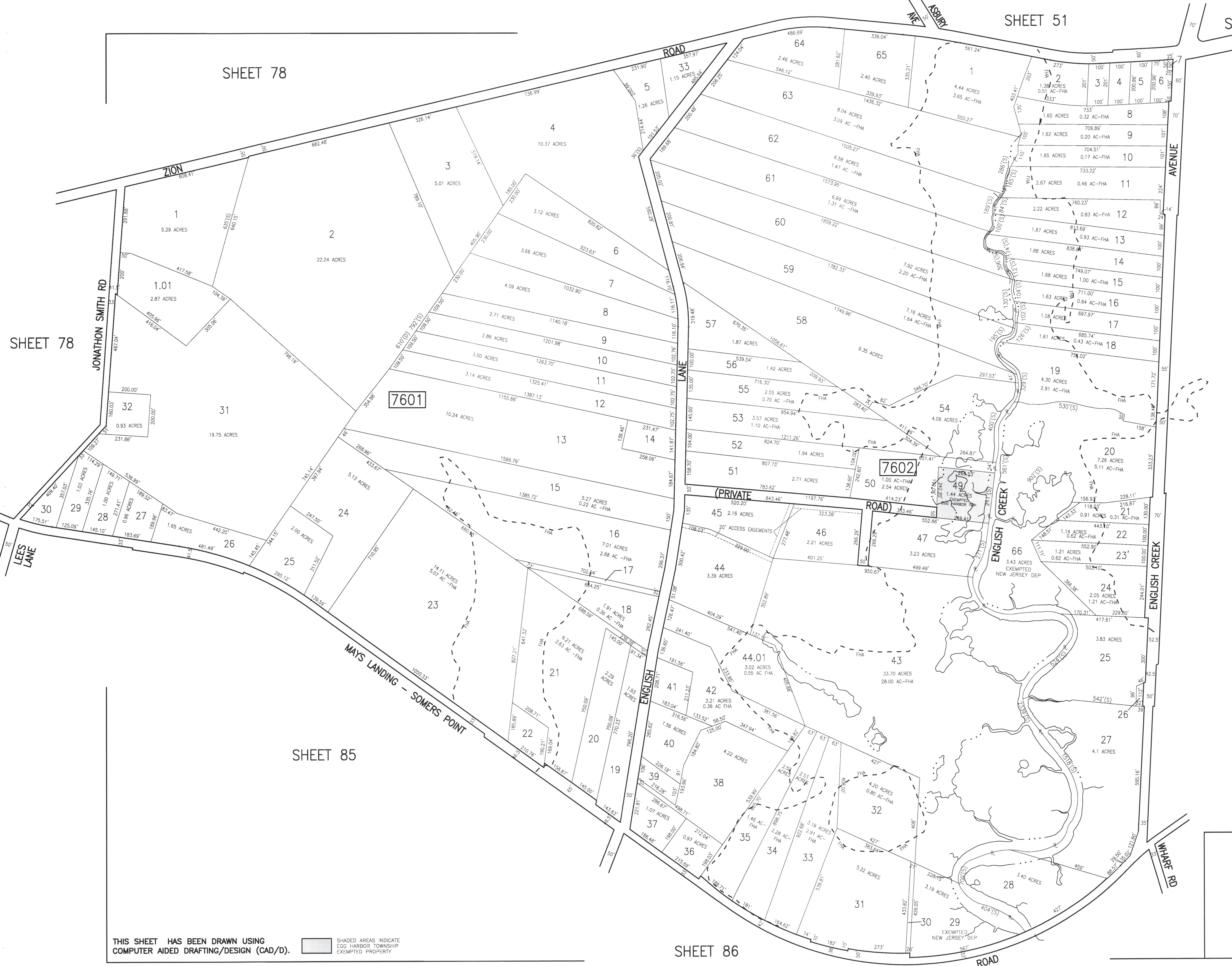

SHEET 78

SHEET 78

SHEET 74

SHEET 85

SHEET 86

THIS SHEET HAS BEEN DRAWN USING COMPUTER AIDED DRAFTING/DESIGN (CAD/D). SHADED AREAS INDICATE EGG HARBOR TOWNSHIP EXEMPTED PROPERTY

TAX MAP
 TOWNSHIP OF EGG HARBOR
 ATLANTIC COUNTY, NEW JERSEY
 SCALE: 1"=200' JANUARY 2008
JAMES A. MOTT, PE, PLS
PROFESSIONAL ENGINEER & LAND SURVEYOR
 NEW JERSEY LICENSE NO. 29918
 3122 FIRE ROAD
 EGG HARBOR TOWNSHIP, NJ 08234