

| REVISIONS | | | |
|-----------|-----|----------|----------|
| DATE | BY | LIC. NO. | COMMENTS |
| 6/17/10 | JAM | 29918 | |
| | | | |
| | | | |
| | | | |
| | | | |

SHEET 49

SHEET 50

SHEET 82

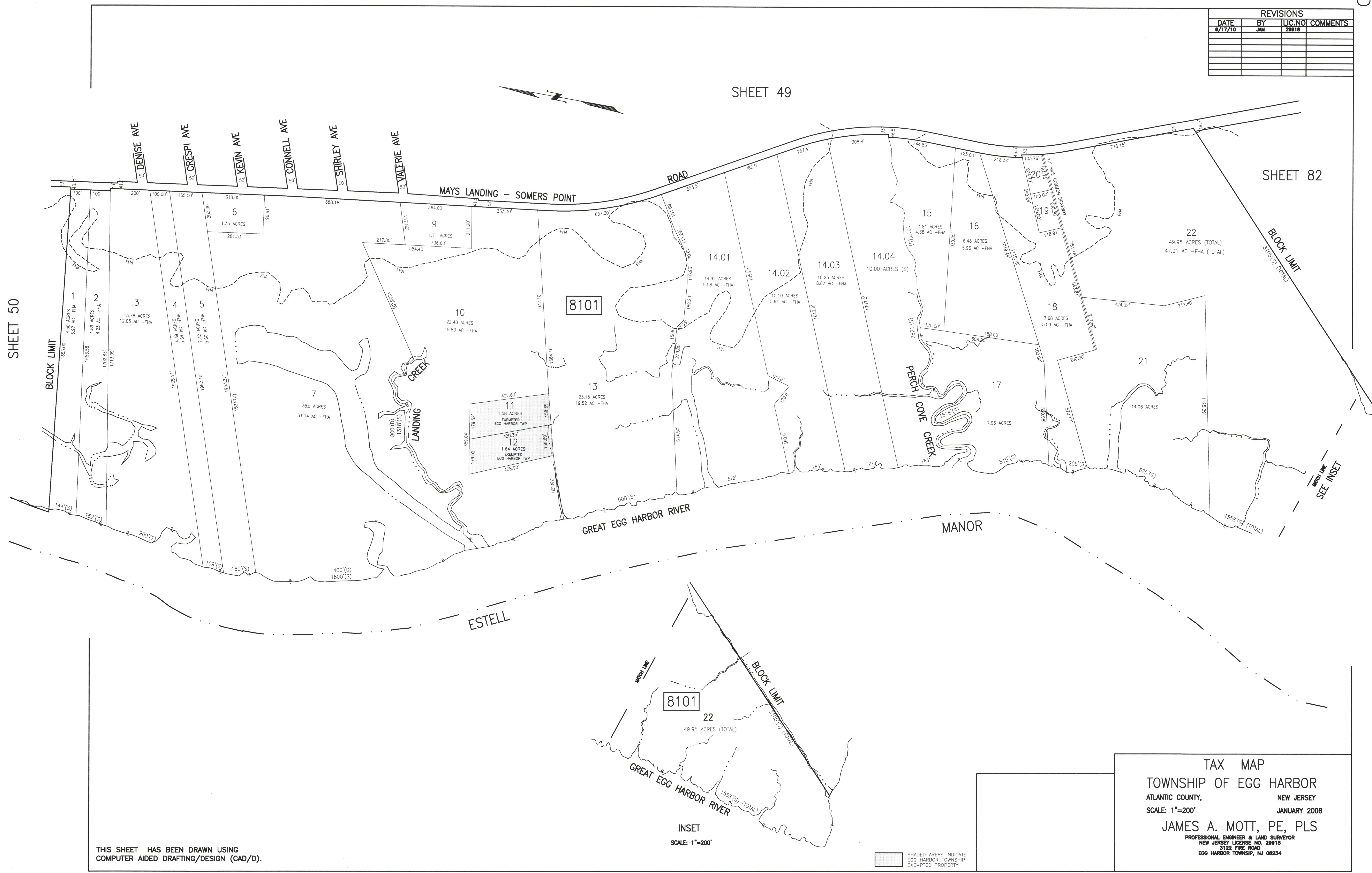

8101

8101

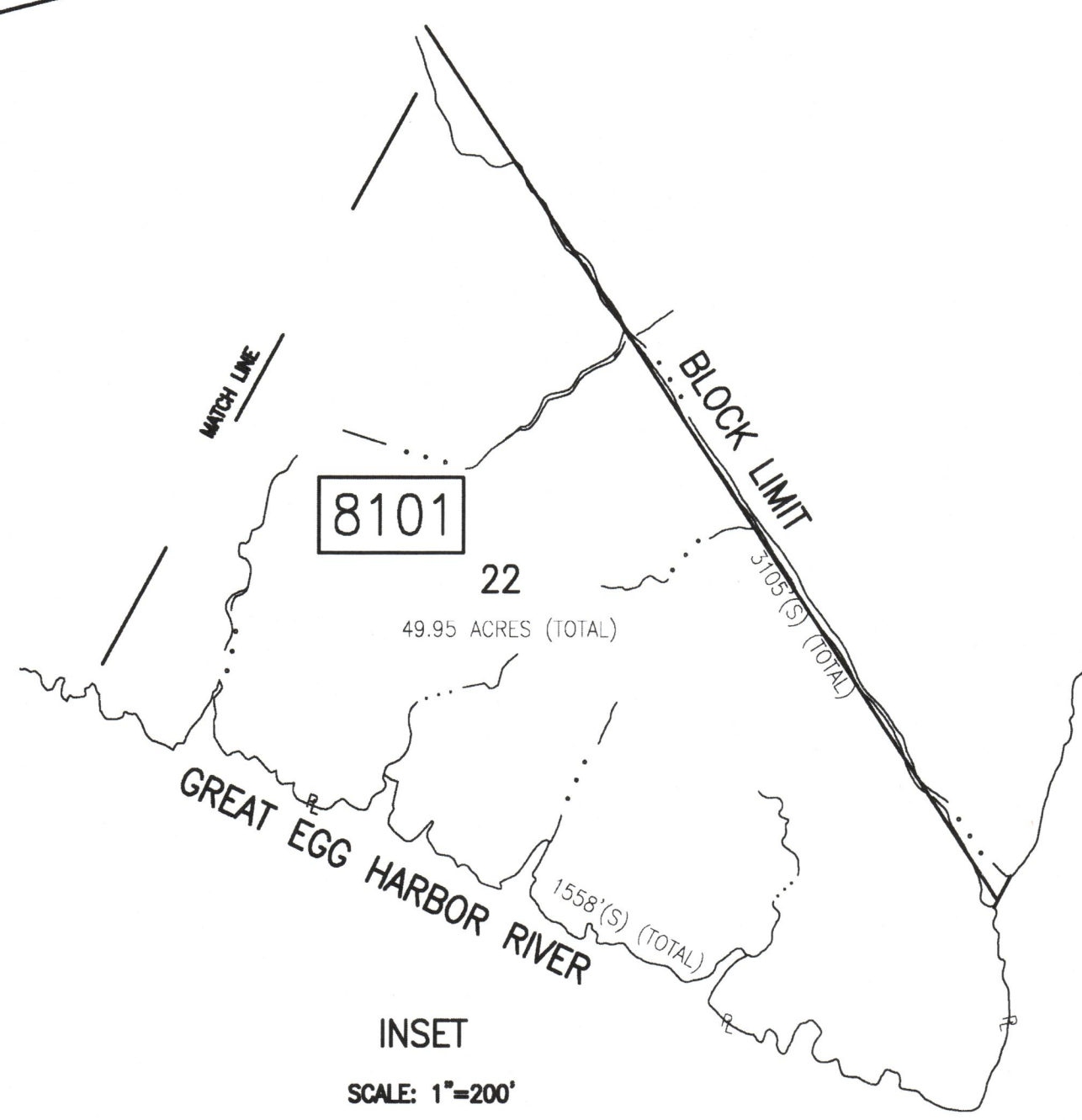

INSET SCALE: 1"=200'

THIS SHEET HAS BEEN DRAWN USING COMPUTER AIDED DRAFTING/DESIGN (CAD/D).

SHADED AREAS INDICATE EGG HARBOR TOWNSHIP EXEMPTED PROPERTY

TAX MAP
TOWNSHIP OF EGG HARBOR
 ATLANTIC COUNTY, NEW JERSEY
 SCALE: 1"=200'
 JANUARY 2008
JAMES A. MOTT, PE, PLS
 PROFESSIONAL ENGINEER & LAND SURVEYOR
 NEW JERSEY LICENSE NO. 29918
 3122 FIRE ROAD
 EGG HARBOR TOWNSHIP, NJ 08234