

| REVISIONS | | | |
|-----------|-----|----------|----------|
| DATE | BY | LIC. NO. | COMMENTS |
| 12/17/09 | JAM | 29918 | |
| 6/15/10 | JAM | 29918 | |
| 7/12/10 | JAM | 29918 | |
| | | | |
| | | | |

| LEGEND | |
|---|---------|
| COUNTY LINE | |
| MUNICIPAL BOUNDARY LINE | |
| ARTIFICIAL BLOCK LIMIT | |
| FORMER PROPERTY LINE | |
| STREAM & WATER LINES | |
| STREAM & WATER LINES (IF PROPERTY LINE) | |
| SHEET LIMIT LINE (ON KEY MAP) | |
| PIERHEAD LINE | |
| BULKHEAD LINE | |
| FLOOD HAZARD LINE | |
| BOUNDARIES OF SPECIAL TAXING DIST | |
| EASEMENT LINE | |
| BLOCK NUMBER (ON KEY MAP) | |
| BLOCK NUMBER | |
| TAX MAP SHEET NUMBER | |
| LOT NUMBER | 16 |
| SCALED DISTANCE/ACREAGE | 200'(S) |
| DEED DISTANCE/ACREAGE | 200'(D) |
| CALCULATED DISTANCE | 200' |

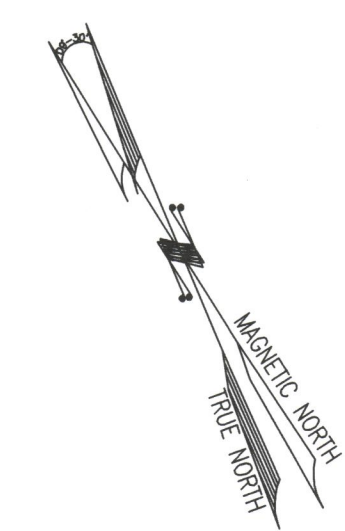

KEY MAP I

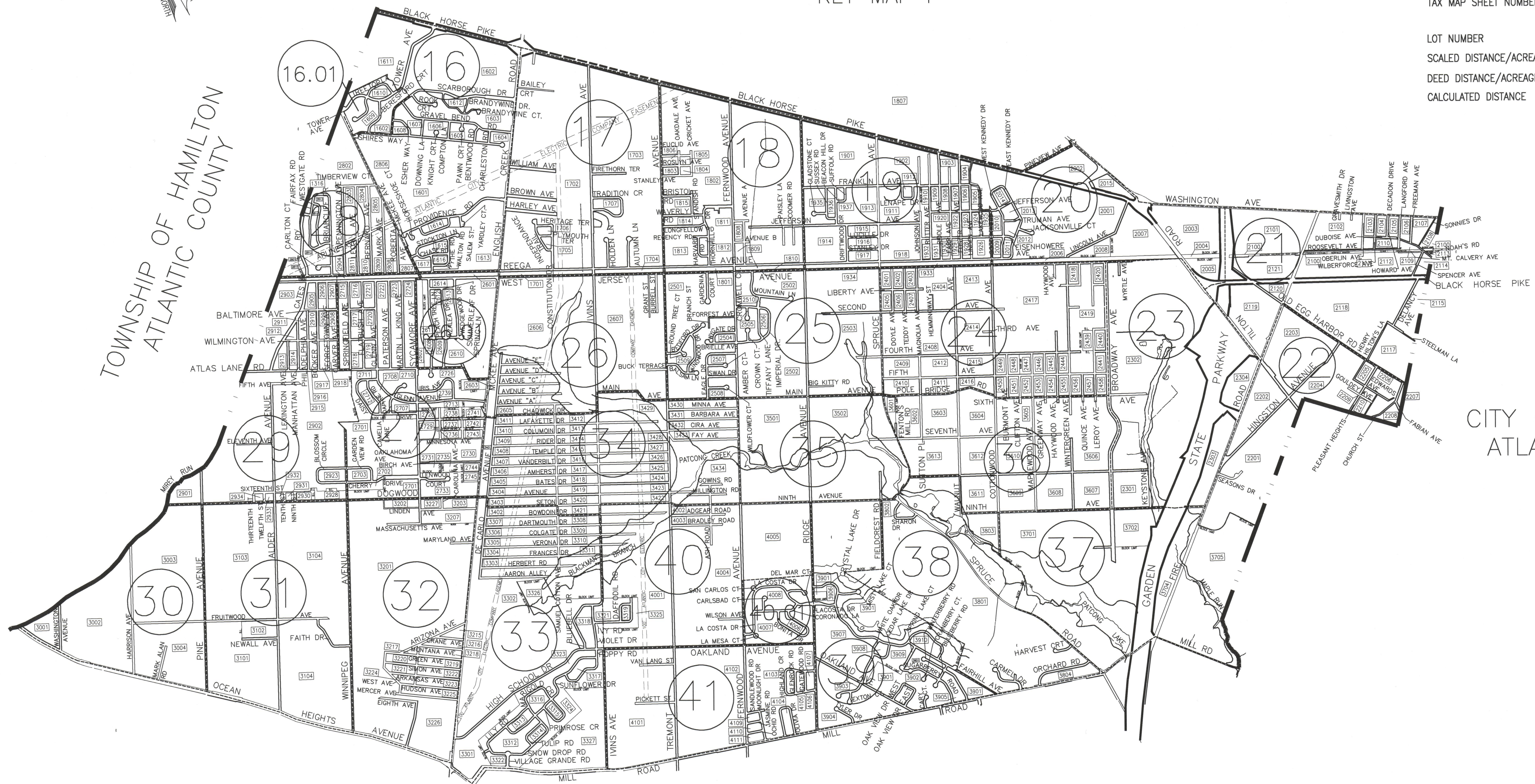

CITY OF NORTHFIELD
ATLANTIC COUNTY

THE AREAS, BOUNDARIES, AND DIMENSIONS SHOWN ON THIS MAP ARE DERIVED FROM GROUND SURVEYS, AERIAL SURVEYS AND RECORDED PLANS, MAPS, DEEDS, AND WILLS AND ARE TO BE USED FOR TAX ASSESSMENT PURPOSES ONLY.

KEY MAP III

TAX MAP
TOWNSHIP OF EGG HARBOR
 ATLANTIC COUNTY, NEW JERSEY
 SCALE: 1"=1500' JANUARY 2008
JAMES A. MOTT, PE, PLS
 PROFESSIONAL ENGINEER & LAND SURVEYOR
 NEW JERSEY LICENSE NO. 29918
 3122 FIRE ROAD
 EGG HARBOR TOWNSHIP, NJ 08234

THIS SHEET HAS BEEN DRAWN USING
COMPUTER AIDED DRAFTING/DESIGN (CAD/D).