

REVISIONS			
DATE	BY	LIC. NO.	COMMENTS
6/17/10	JAM	29918	

TAX MAP  
 TOWNSHIP OF EGG HARBOR  
 ATLANTIC COUNTY, NEW JERSEY  
 SCALE: 1"=200'  
 JANUARY 2008  
**JAMES A. MOTT, PE, PLS**  
 PROFESSIONAL ENGINEER & LAND SURVEYOR  
 NEW JERSEY LICENSE NO. 29918  
 3122 FIRE ROAD  
 EGG HARBOR TOWNSHIP, NJ 08234

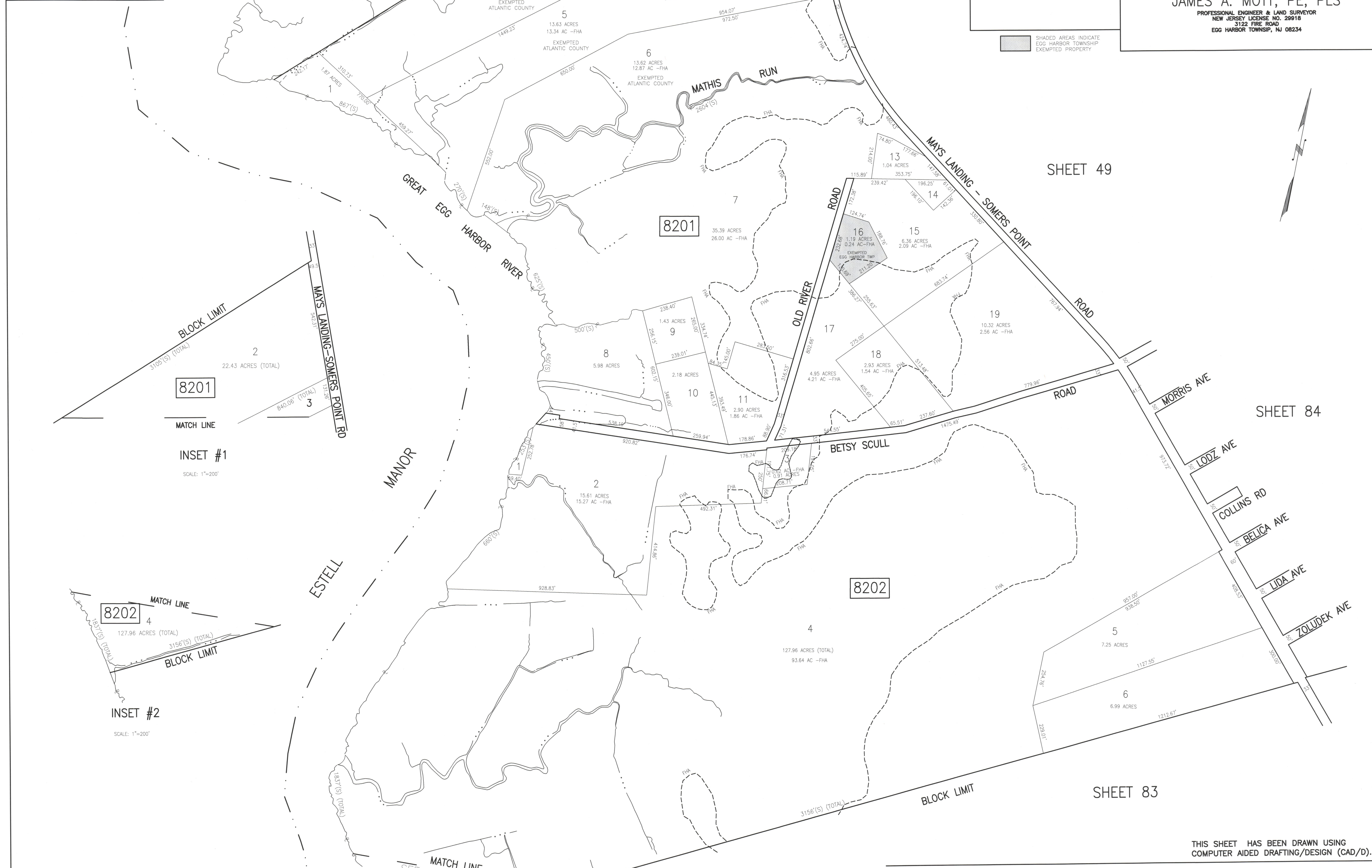

8201

8202

INSET #1

SCALE: 1"=200'

8202

INSET #2

SCALE: 1"=200'

MATCH LINE  
SEE INSET #2

THIS SHEET HAS BEEN DRAWN USING  
COMPUTER AIDED DRAFTING/DESIGN (CAD/D).