

## LEGEND

- COUNTY LINE
- MUNICIPAL BOUNDARY LINE
- ARTIFICIAL BLOCK LIMIT
- FORMER PROPERTY LINE
- STREAM & WATER LINES
- STREAM & WATER LINES (IF PROPERTY LINE)
- SHEET LIMIT LINE (ON KEY MAP)
- PIERHEAD LINE
- BULKHEAD LINE
- FLOOD HAZARD LINE
- BOUNDARIES OF SPECIAL TAXING DIST
- EASEMENT LINE
- BLOCK NUMBER (ON KEY MAP)

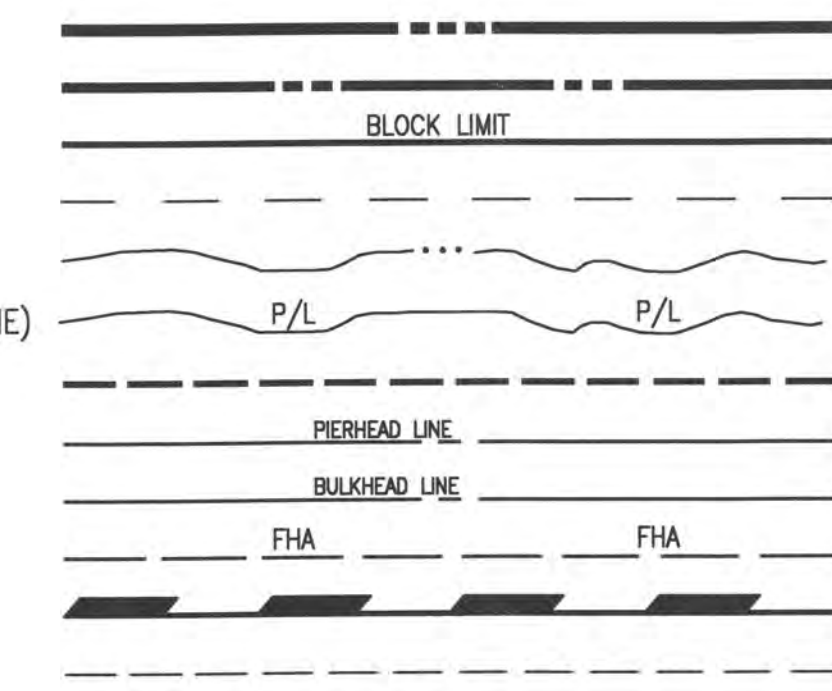

BLOCK NUMBER 538

TAX MAP SHEET NUMBER 24

LOT NUMBER 16

SCALED DISTANCE/ACREAGE 200'(S)

DEED DISTANCE/ACREAGE 200'(D)

CALCULATED DISTANCE 200'

REVISIONS			
DATE	BY	LIC. NO.	COMMENTS
12/17/09	JAM	29918	
9/15/10	JAM	29918	
7/12/10	JAM	29918	
1/15/16	JAM	29918	
10/17/16	JAM	29918	

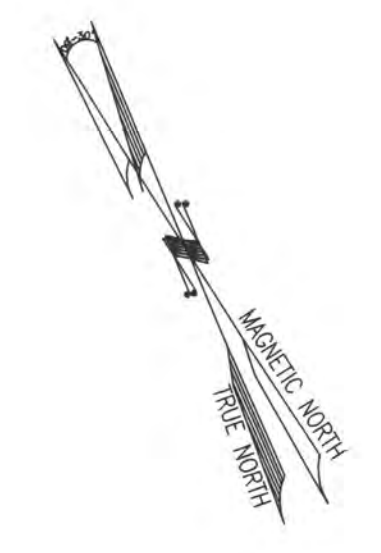

## KEY MAP I

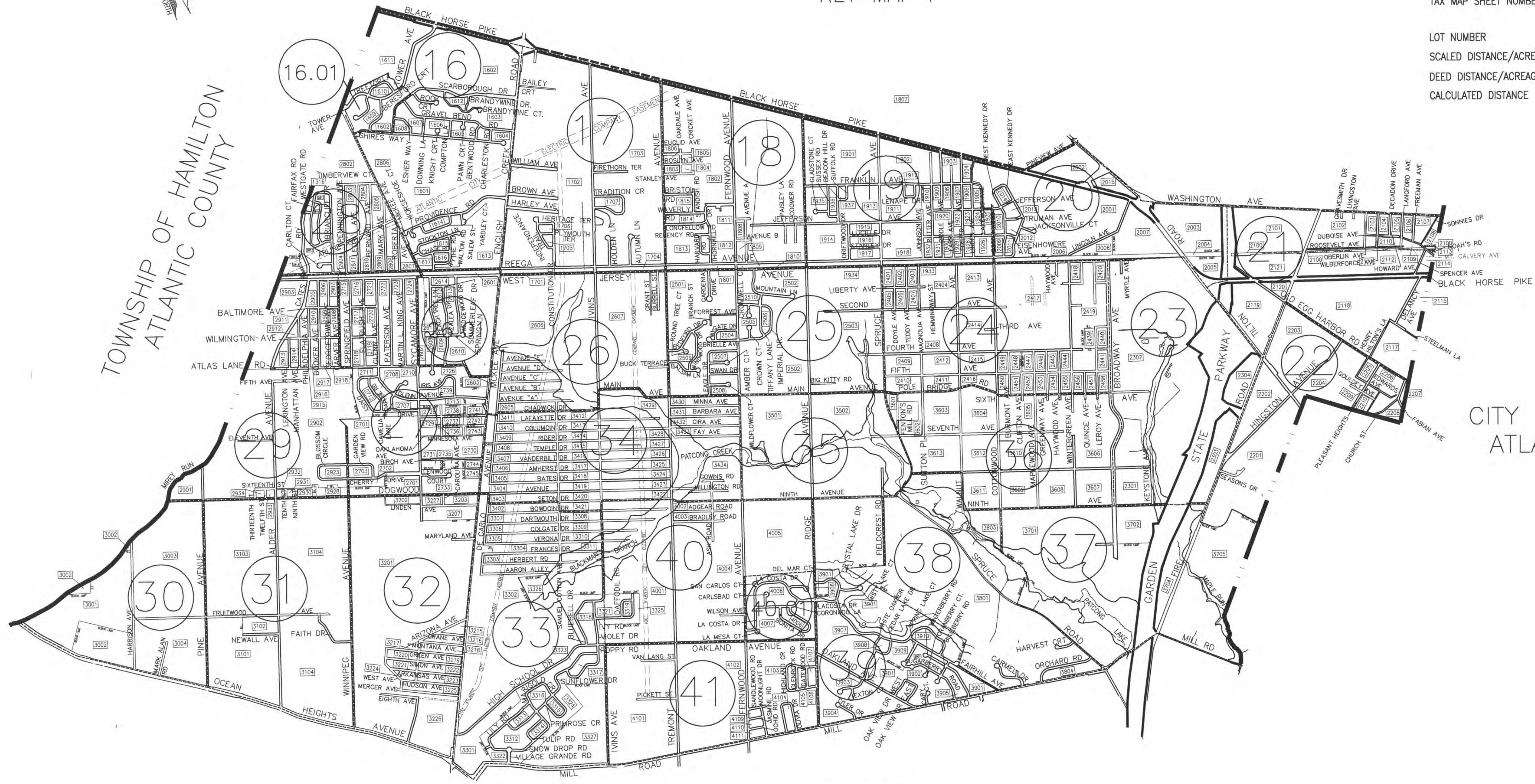

## KEY MAP III

THE AREAS, BOUNDARIES, AND DIMENSIONS SHOWN ON THIS MAP ARE DERIVED FROM GROUND SURVEYS, AERIAL SURVEYS AND RECORDED PLANS, MAPS, DEEDS, AND WILLS AND ARE TO BE USED FOR TAX ASSESSMENT PURPOSES ONLY.

TAX MAP  
 TOWNSHIP OF EGG HARBOR  
 ATLANTIC COUNTY, NEW JERSEY  
 SCALE: 1"=1500' JANUARY 2008  
 JAMES A. MOTT, PE, PLS  
 PROFESSIONAL ENGINEER & LAND SURVEYOR  
 NEW JERSEY LICENSE NO. 29918  
 3122 FIRE ROAD  
 EGG HARBOR TOWNSHIP, NJ 08234

THIS SHEET HAS BEEN DRAWN USING COMPUTER AIDED DRAFTING/DESIGN (CAD/D).