

REVISIONS				REVISIONS			
DATE	BY	LIC.NO	COMMENTS	DATE	BY	LIC.NO	COMMENTS
6/10/08	JAM	29918		1/7/12	JAM	29918	
11/7/08	JAM	29918		11/12/13	JAM	29918	
9/16/09	JAM	29918		12/16/13	JAM	29918	
6/16/10	JAM	29918		1/2/15	JAM	29918	
1/13/11	JAM	29918		1/28/16	JAM	29918	
6/2/11	JAM	29918					

SHEET 7

SHEET 8

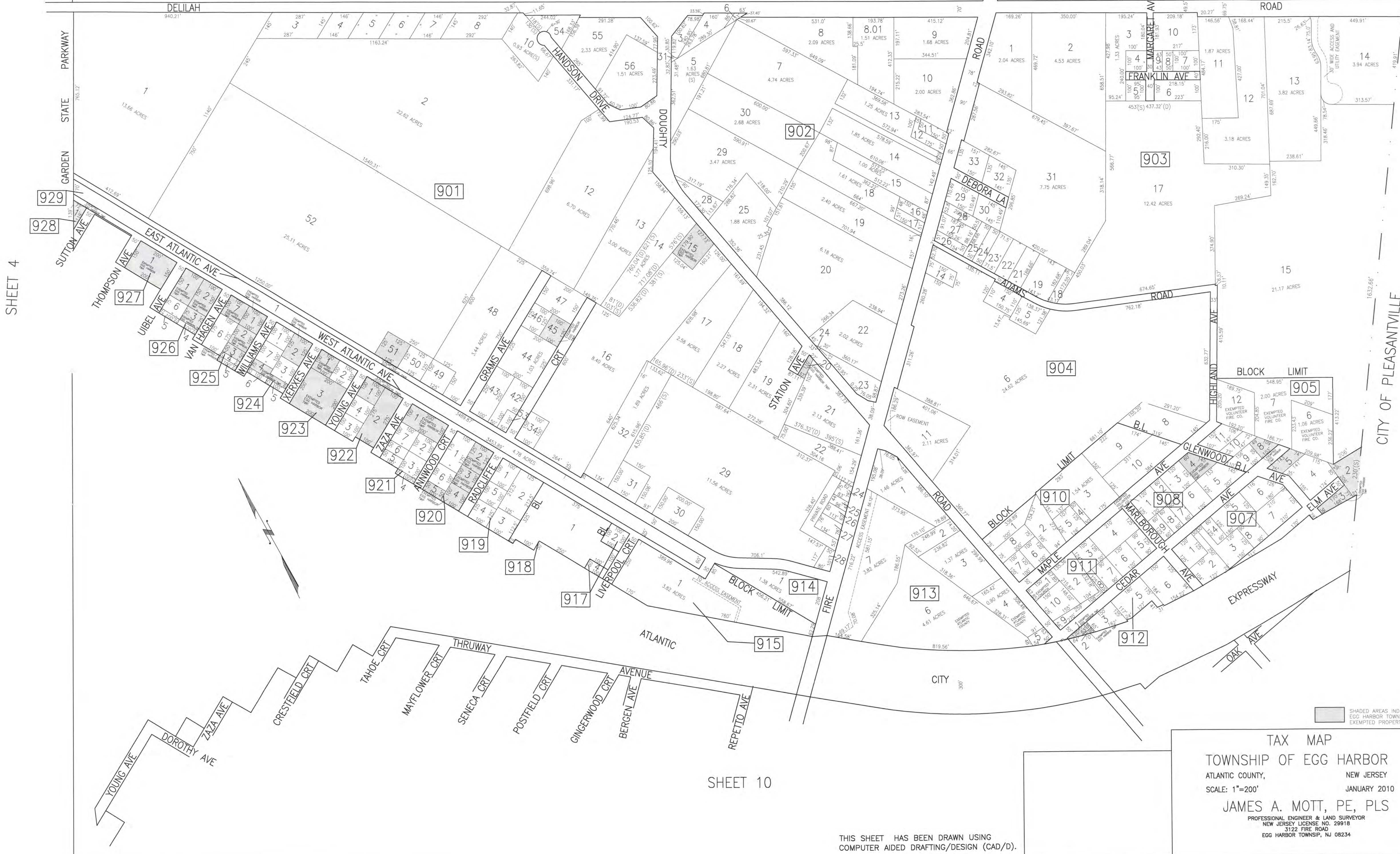

SHADED AREAS INDICATE
EGG HARBOR TOWNSHIP
EXEMPTED PROPERTY

TAX MAP
TOWNSHIP OF EGG HARBOR
ATLANTIC COUNTY, NEW JERSEY
SCALE: 1"=200'
JANUARY 2010
JAMES A. MOTT, PE, PLS
PROFESSIONAL ENGINEER & LAND SURVEYOR
NEW JERSEY LICENSE NO. 29918
3122 FIRE ROAD
EGG HARBOR TOWNSHIP, NJ 08234

THIS SHEET HAS BEEN DRAWN USING
COMPUTER AIDED DRAFTING/DESIGN (CAD/D).

9

9