

REVISIONS		
DATE	NAME	NO.

SHEET 29

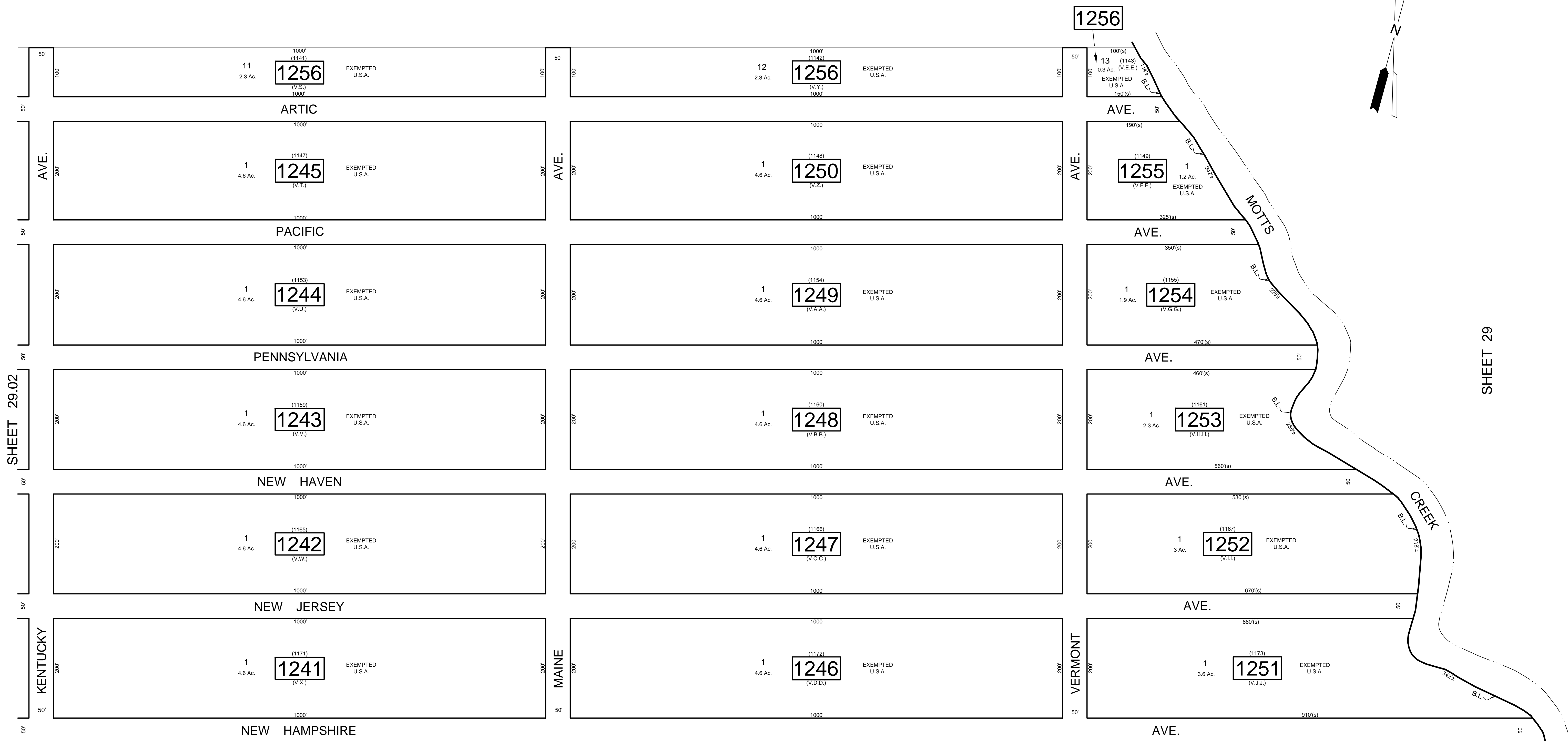

SHEET 29.02

SHEET 29

NOTE:  
 LETTER "V" INDICATES NUMBER ON MAP OF "ATLANTIC CITY VISTAS" BY ABSECON DEV. & FINANCE CO.  
 LETTERS "U.S.A." INDICATES UNITED STATES OF AMERICA OWNED PROPERTY.

SHEET 29

THIS SHEET HAS BEEN DRAWN USING COMPUTER AIDED DRAFTING / DESIGN (CAD/D) AND WAS DONE UNDER THE SUPERVISION OF SAMUEL S. PREVITERA, P.L.S., NEW JERSEY PROFESSIONAL LAND SURVEYOR LICENSE NO. 36976, AND DATED DECEMBER 31, 2006.

**TAX MAP**  
 TOWNSHIP OF GALLOWAY  
 ATLANTIC COUNTY, NEW JERSEY  
 SCALE: 1" = 100' JANUARY 2007  
 SAMUEL S. PREVITERA, P.L.S.  
 N.J. LIC. No. 38976  
 26 NORTH ROUTE 73, SUITE 200  
 CEDAR BROOK, N.J. 08018