

# KEY MAP 1

TOWNSHIP OF EGG HARBOR  
COUNTY OF ATLANTIC

CITY OF NORTHERFIELD  
COUNTY OF ATLANTIC

CITY OF ABSECON  
COUNTY OF ATLANTIC

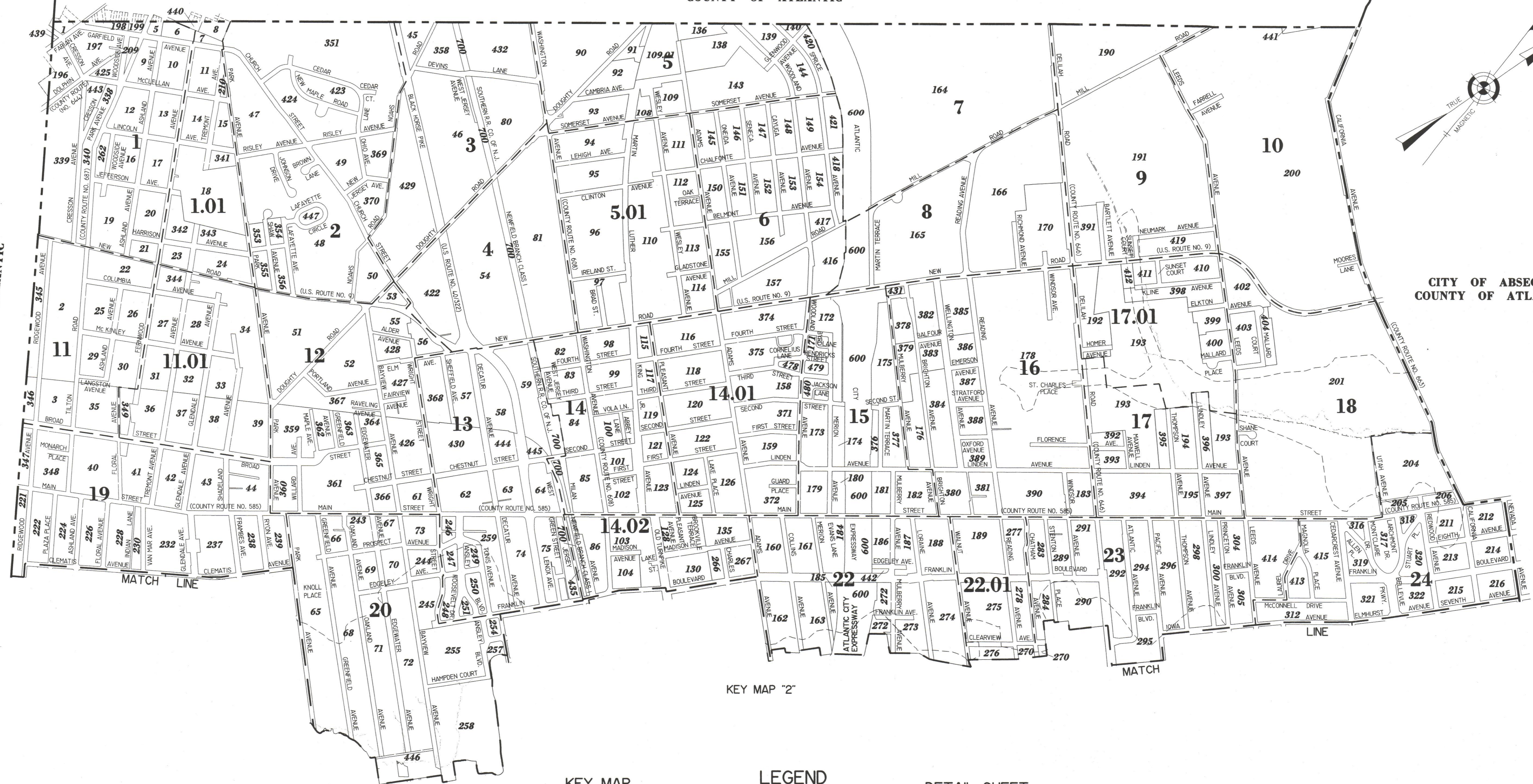

### KEY MAP

### LEGEND

### DETAIL SHEET

10	PLATE NUMBER
107	BLOCK NUMBER
	ARTIFICIAL-BLOCK-LIMIT-LINE
	MATCH LINE
	PLATE DELINEATION LINE
	KEY MAP DELINEATION LINE
	MUNICIPAL BOUNDARY LINE
	COUNTY BOUNDARY LINE
	WATERWAY LINES
	ASSESSMENT LINE
	TIDELANDS LINE
	FLOOD HAZARD AREA - F.H.A.
	PIERHEAD OR BULKHEAD LINE
	PIERHEAD OR BULKHEAD LINE (BLOCK LIMIT LINE)

1.01	NEW BLOCK NUMBERS
5	NEW LOT NUMBERS
	OLD BLOCK NUMBERS
4	OLD LOT NUMBERS
	ARTIFICIAL-BLOCK-LIMIT-LINE
	LOT-LINE
	OLD LOT LINE (PROPERTY LINE)
	WATERWAY LINES
	ASSESSMENT LINE
	TIDELANDS LINE
	FLOOD HAZARD AREA - F.H.A.
	PIERHEAD OR BULKHEAD LINE
	PIERHEAD OR BULKHEAD LINE (BLOCK LIMIT LINE)

NEW JERSEY DEPARTMENT OF THE TREASURY  
DIVISION OF TAXATION  
PROPERTY ADMINISTRATION  
APPROVED AS A TAX MAP PURSUANT TO THE AUTHORITY OF  
N.J.S.A. 54:1-19 & 54:9-1  
FOR THE DIRECTOR, DIVISION OF TAXATION  
*Thomas C. DiDonato* C.T.A.  
THOMAS C. DI DONATO, CHIEF, LOCAL SAFETY, FIELD ASSISTANCE  
*Scott C. DiDonato* C.T.A.  
SCOTT C. DI DONATO, SUPERVISING FIELD REPRESENTATIVE  
DATE: OCT 16 2007 SERIAL NO. 914

## KEY MAP 1 CITY OF PLEASANTVILLE

ATLANTIC COUNTY NEW JERSEY  
SCALE: 1" = 600' DATE: 6-16-2003

CRAIG F. REMINGTON LAND SURVEYOR LIC. NO. 23924

REMINGTON, VERNICK & WALBERG ENGINEERS  
845 N. MAIN STREET, PLEASANTVILLE, N.J. 08232  
(609) 645-7100 FAX (609) 645-7076  
WEB SITE ADDRESS: WWW.RVE.COM

# KEY MAP 1