

SHEET 14

SHEET 14.01

SHEET 13

SHEET 22

SHEET 21

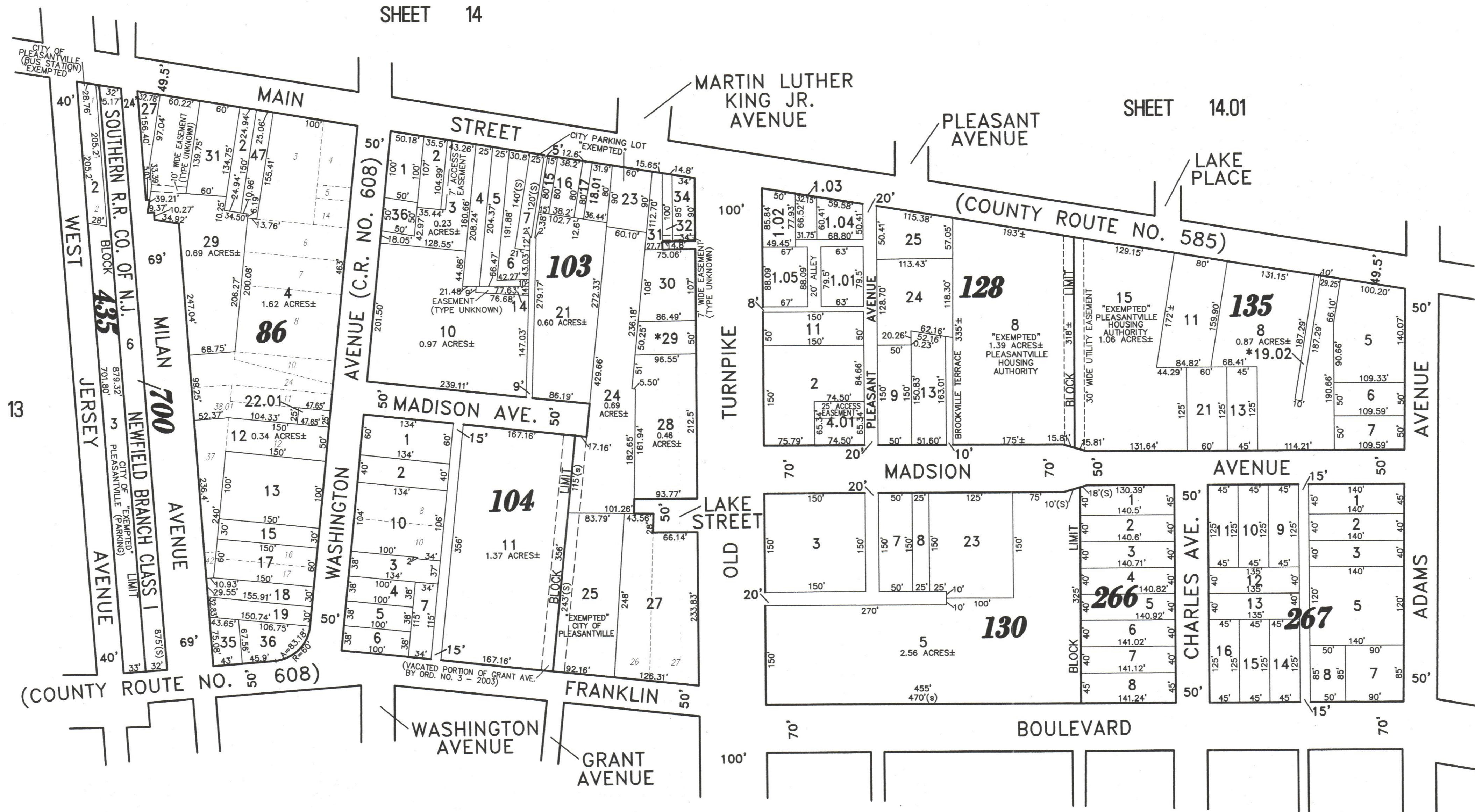

*NOTE: "EXEMPTED" CITY OF PLEASANTVILLE - TEMPORARY PROPERTY FORECLOSURE

Official stamp from New Jersey Department of the Treasury, Division of Taxation, dated OCT 16 2007.

TAX MAP CITY OF PLEASANTVILLE

ATLANTIC COUNTY NEW JERSEY SCALE: 1" = 100' DATE: 6-17-2003

CRAIG F. REMINGTON LAND SURVEYOR LIC. NO. 23924



REMINGTON, VERNICK & WALBERG ENGINEERS 845 N. MAIN STREET, PLEASANTVILLE, N.J. 08232

DESIGNED BY REMINGTON AND VERNICK ENGINEERS - 2-21-2007 - 01197431