

HOMER AVENUE

ST. CHARLES PLACE

(COUNTY ROUTE NO. 646)

DELILAH ROAD

WINDSOR AVENUE

WINDSOR AVENUE

FLORENCE AVENUE

COUNTY ROUTE NO. 585

STENTON PLACE

CHATHAM AVENUE

READING AVENUE

SHEET 22.01

SHEET 22

NOTE: "EXEMPTED" CITY OF PLEASANTVILLE - TEMPORARY PROPERTY FORECLOSURE

**TAX MAP**  
**CITY OF PLEASANTVILLE**  
 ATLANTIC COUNTY NEW JERSEY  
 SCALE: 1" = 100' DATE: 6-17-2003  
**CRAIG F. REMINGTON LAND SURVEYOR LIC. NO. 23924**  
**REMINGTON, VERNICK & WALBERG ENGINEERS**  
 845 N. MAIN STREET, PLEASANTVILLE, N.J. 08232  
 (609) 645-700, FAX (609) 645-7076  
 WEB SITE ADDRESS: WWW.RVWE.COM

NEW JERSEY DEPARTMENT OF THE TREASURY  
 DIVISION OF TAXATION  
 PROPERTY ADMINISTRATION  
 APPROVED AS A TAX MAP PURSUANT TO THE AUTHORITY OF  
 N.J.S.A. 54:1-18 & 54:20-1  
 FOR THE DIRECTOR, DIVISION OF TAXATION  
 THOMAS C. FRELIC, CHIEF, LOCAL PROPERTY, FIELD ASSISTANCE  
 DATE: OCT 1 6 2007 SERIAL NO. 914

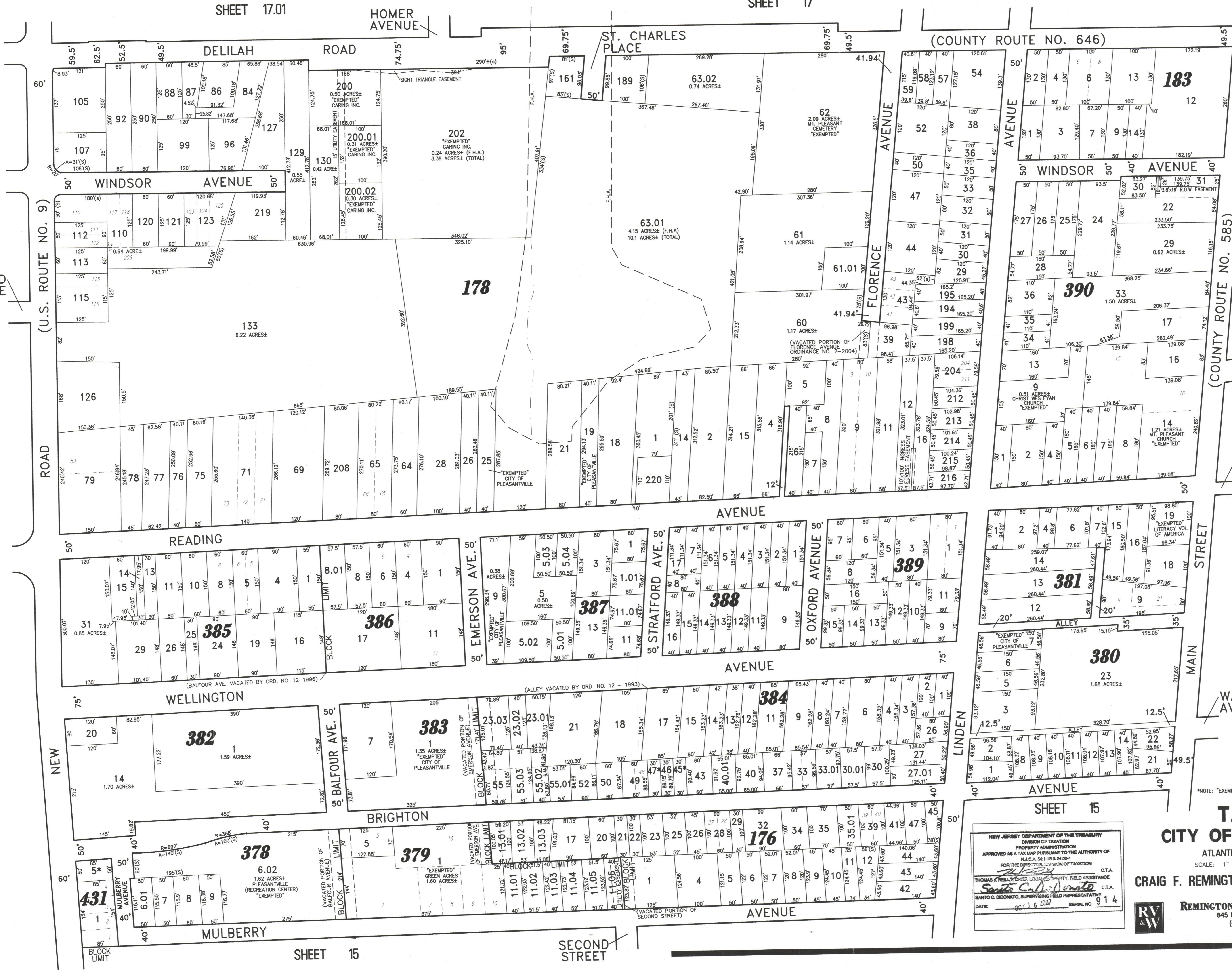
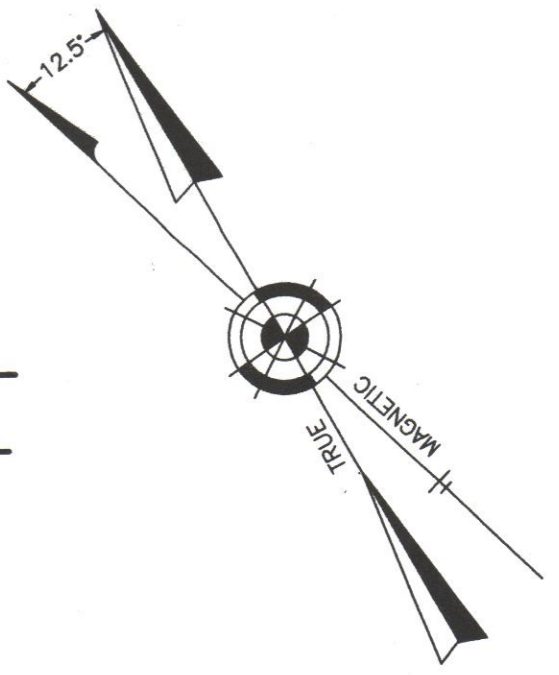

RICHMOND AVENUE

(U.S. ROUTE NO. 9)

ROAD

SHEET 8

SHEET 15

SECOND STREET