

TOWNSHIP OF EGG HARBOR
COUNTY OF ATLANTIC

CITY OF NORTFIELD
COUNTY OF ATLANTIC

CITY OF ABSECON
COUNTY OF ATLANTIC

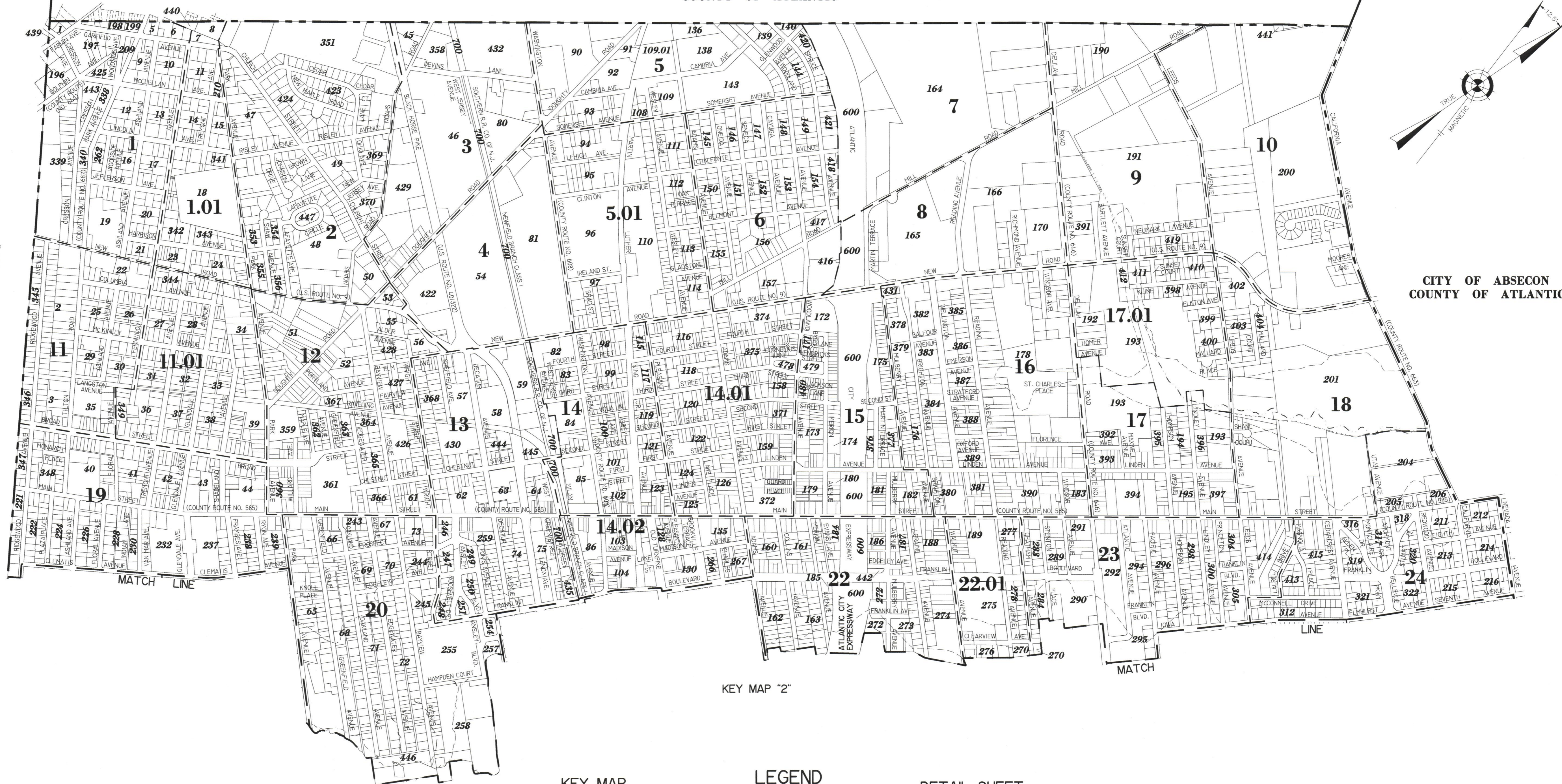

KEY MAP "2"

KEY MAP

- 10** PLATE NUMBER
- 107** BLOCK NUMBER
- MATCH LINE** ARTIFICIAL-BLOCK-LIMIT-LINE
- MATCH LINE** MATCH LINE
- PLATE DELINEATION LINE** PLATE DELINEATION LINE
- MUNICIPAL BOUNDARY LINE** MUNICIPAL BOUNDARY LINE
- COUNTY BOUNDARY LINE** COUNTY BOUNDARY LINE
- WATERWAY LINES** WATERWAY LINES
- ASSESSMENT LINE** ASSESSMENT LINE
- TIDELANDS LINE** TIDELANDS LINE
- F.H.A.** FLOOD HAZARD AREA - F.H.A.
- PIERHEAD LINE** PIERHEAD OR BULKHEAD LINE
- BULKHEAD LINE** PIERHEAD OR BULKHEAD LINE (BLOCK LIMIT LINE)

LEGEND

- 1.01** NEW BLOCK NUMBERS
- 5** NEW LOT NUMBERS
- (C-108)** OLD BLOCK NUMBERS
- 4** OLD LOT NUMBERS
- ARTIFICIAL-BLOCK-LIMIT-LINE** ARTIFICIAL-BLOCK-LIMIT-LINE
- LOT-LINE** LOT-LINE
- OLD LOT LINE (PROPERTY LINE)** OLD LOT LINE (PROPERTY LINE)
- WATERWAY LINES** WATERWAY LINES
- ASSESSMENT LINE** ASSESSMENT LINE
- TIDELANDS LINE** TIDELANDS LINE
- F.H.A.** FLOOD HAZARD AREA - F.H.A.
- PIERHEAD LINE** PIERHEAD OR BULKHEAD LINE
- BULKHEAD LINE** PIERHEAD OR BULKHEAD LINE (BLOCK LIMIT LINE)

DETAIL SHEET

"THIS TAX MAP PLATE HAS BEEN DIGITALLY DRAWN USING COMPUTER-AIDED DRAFTING/DESIGN (CAD) & COORDINATE GEOMETRY (COCO). IT IS BASED ON THE ORIGINAL DIGITALLY DRAWN TAX MAP PLATE BEARING THE OFFICIAL NEW JERSEY DIVISION TAXATION APPROVAL STAMP WITH APPROVAL DATE 10-16-2007 SERIAL NUMBER 914 AND SIGNATURES OF SIGNERS' THOMAS J. REILLY, CHIEF, LOCAL PROPERTY, FIELD ASSISTANCE; SANTO C. DIDONATO, SUPERVISING FIELD REPRESENTATIVE. THE ORIGINAL DIGITALLY DRAWN TAX MAP PLATE WITH THE OFFICIAL APPROVAL STAMP IS ON FILE WITH REMINGTON, VERNICK & WALBERG ENGINEERS."

TAX MAP CITY OF PLEASANTVILLE

ATLANTIC COUNTY NEW JERSEY
SCALE: 1" = 600' DATE: 6-16-2003

CRAIG F. REMINGTON LAND SURVEYOR LIC. NO. 23924

REMINGTON, VERNICK & WALBERG ENGINEERS
24 GA 28048700
845 N. MAIN STREET, PLEASANTVILLE, N.J. 08232
(609) 645-7100, FAX (609) 645-7076
WEB SITE ADDRESS: WWW.RVW.COM

REVISIONS		
5-01-2009	CRAIG F. REMINGTON	23924
7-22-2011	CRAIG F. REMINGTON	23924
6-14-2017	CHARLES E. ADAMSON	42627