

See Sheet 1

REVISED TO DEC. 1, 1994 BY R & V - W/O NO. 94-04

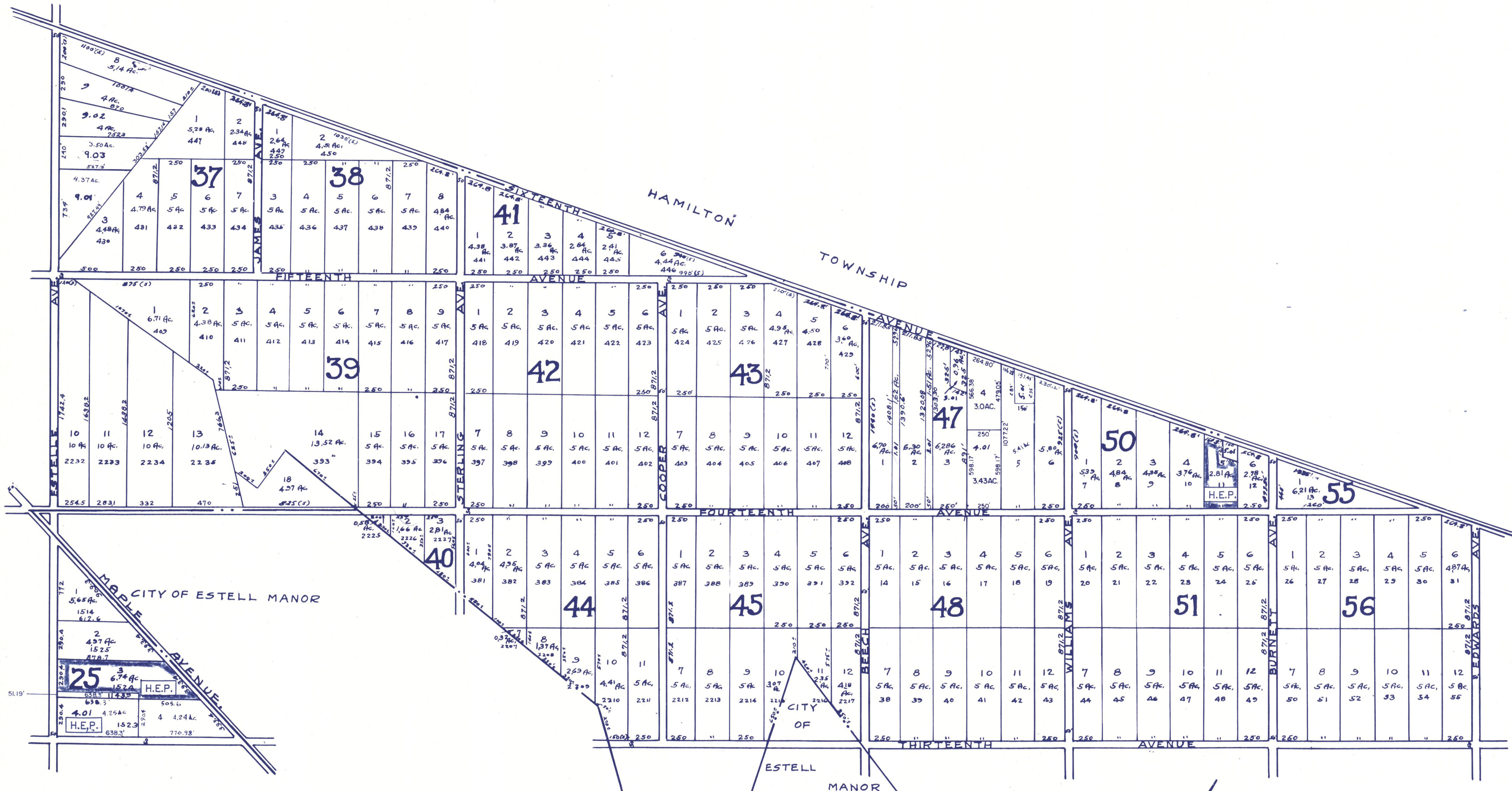

See Sheet 5

lots Numbered 2232 to 2235
 1514, 1523, 1524, 1525 D.L. Risley's Map Tract No. 17.
 All other numbers A.G. Vautrinot Map, Walker Tract.

See Sheet 4

NOTE:
 H.E.P. IS IN ACCORDANCE WITH THE WEYMOUTH TOWNSHIP
 HOMESTEAD EXCHANGE PROGRAM (13-9.21). DEVELOPABLE
 LOTS, AND THE SHADED LOTS ARE THE RESTRICTED LOTS.

TAX MAP
WEYMOUTH TOWNSHIP, N.J.
 SCALE 1" = 400'
 REVISED 1968
 John Adams Twp. Engineer
 Revised 1984 by RONALD J. PRICE, N.J.L.S. (13901)