

REVISIONS		
DATE	NAME	NO.

NOTE:
 THIS SHEET HAS BEEN DRAWN USING COMPUTER AIDED DRAFTING/DESIGN (CAD/D) AND COORDINATE GEOMETRY (COGO).

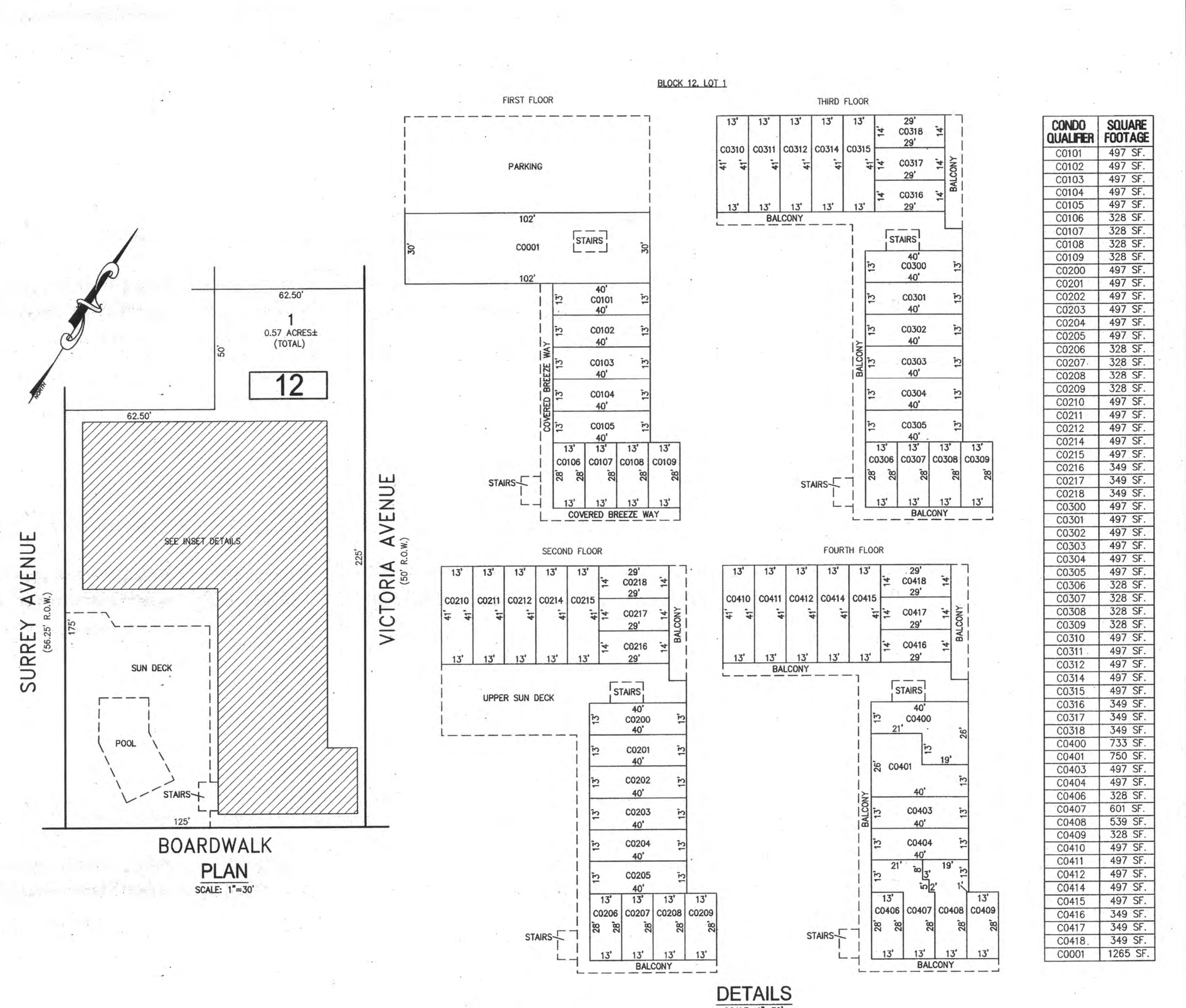
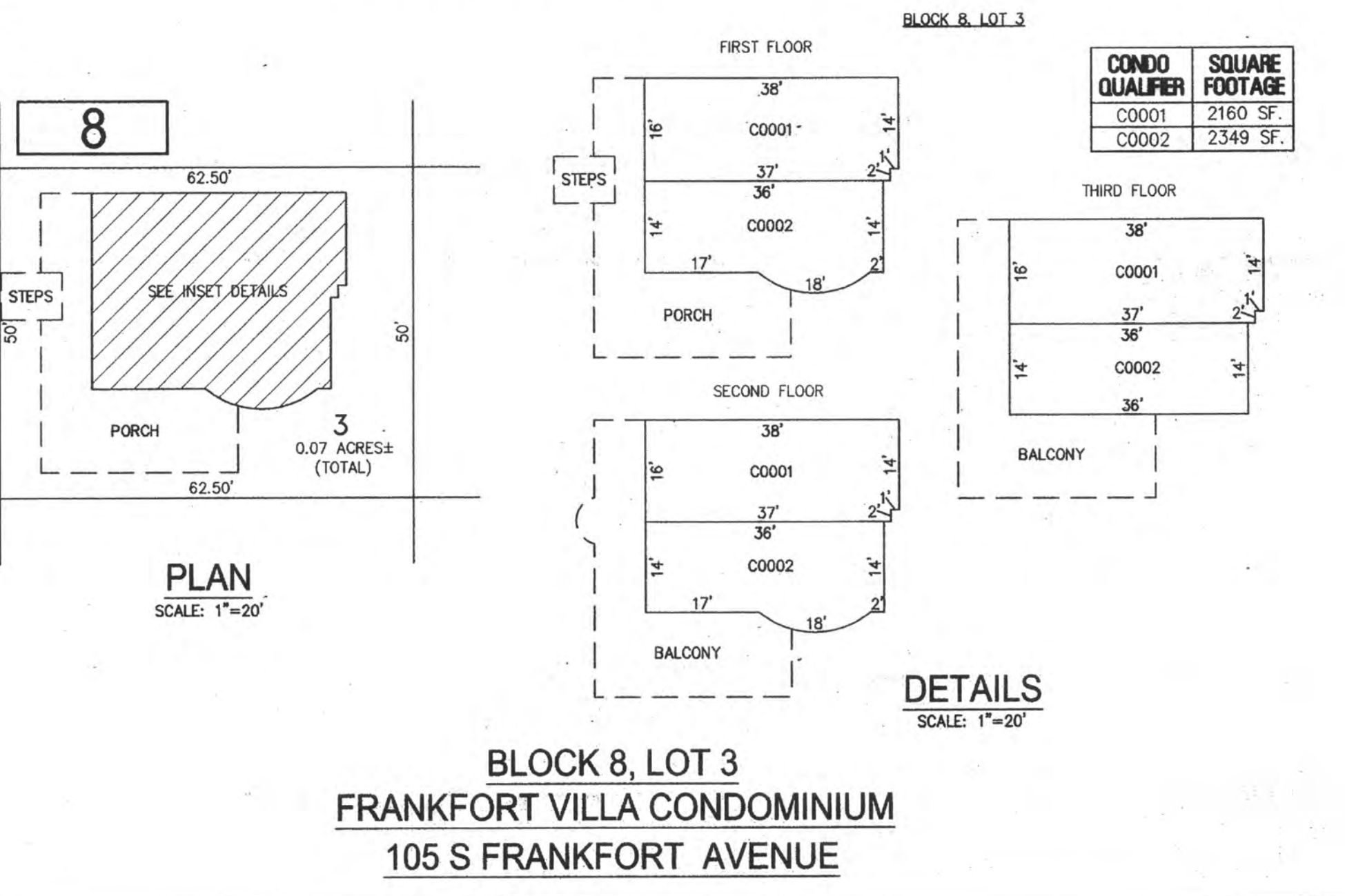
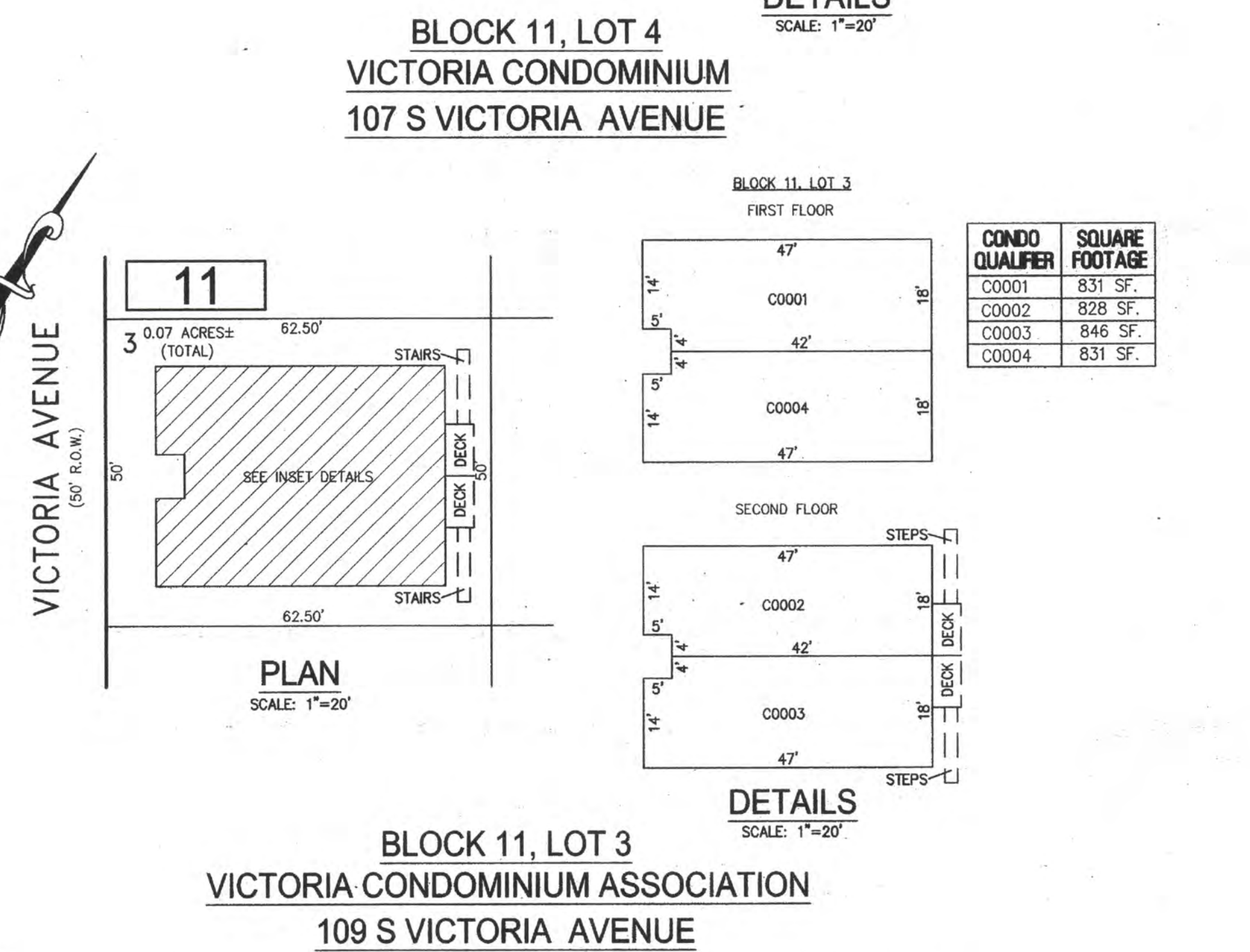
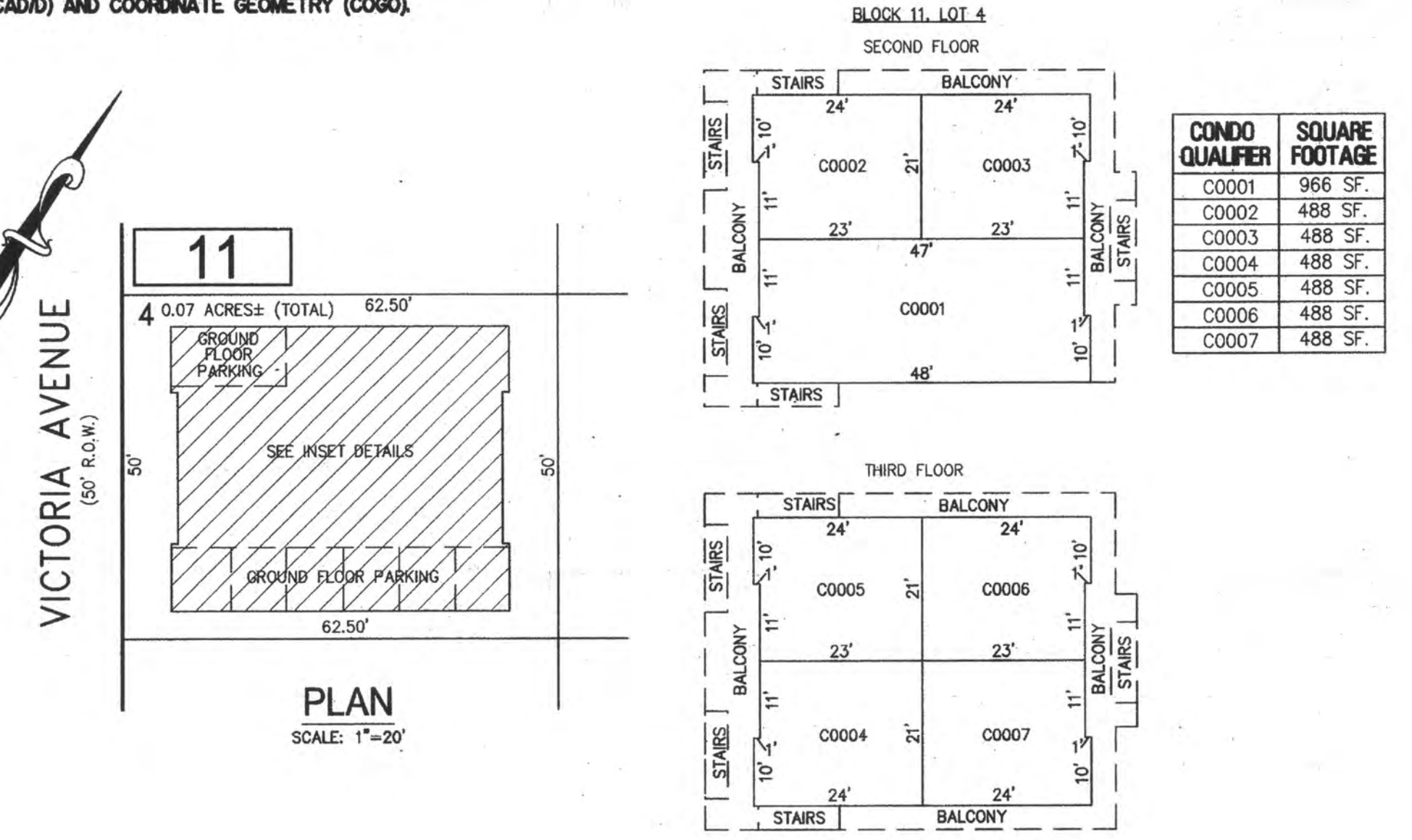

BLOCK 8, LOT 3
 BLOCK 11, LOT 3
 BLOCK 11, LOT 4
 BLOCK 12, LOT 1
 SEE SHEET 2

NEW JERSEY DEPARTMENT OF THE TREASURY
 DIVISION OF TAXATION
 APPROVED AS A TAX MAP PURSUANT TO THE AUTHORITY OF
 N.J.S.A. 54:1-15 AND N.J.S.A. 56:5-4
 FOR THE DIRECTOR, DIVISION OF TAXATION
Shelly Miller, CPA
 Shelly Miller, CPA, Chief Property Administrator
Shelly Miller, CPA
 Shelly Miller, CPA, Principal Property Representative
 DATE JUL 20 2016 SERIAL NO. 1070

TAX MAP
CITY OF VENTNOR
 ATLANTIC COUNTY NEW JERSEY
 SCALE: NOTED DATE: 2-19-2015
CHARLES E. ADAMSON NJ PROFESSIONAL LAND SURVEYOR LIC. NO. 42627
 24 GA 28048700
REMINGTON, VERNICK & WALBERG ENGINEERS
 845 N. MAIN STREET, PLEASANTVILLE, N.J. 08232
 (609) 645-7100, FAX (609) 645-7076
 WEB SITE ADDRESS: WWW.RVWE.COM
 TO SHOW CONDITIONS AS OF 7-20-2016