

REVISIONS		
DATE	NAME	NO.

NOTE:
 THIS SHEET HAS BEEN DRAWN USING COMPUTER AIDED DRAFTING/DESIGN (CAD/D) AND COORDINATE GEOMETRY (COGO).

**CITY OF ATLANTIC CITY
 COUNTY OF ATLANTIC**

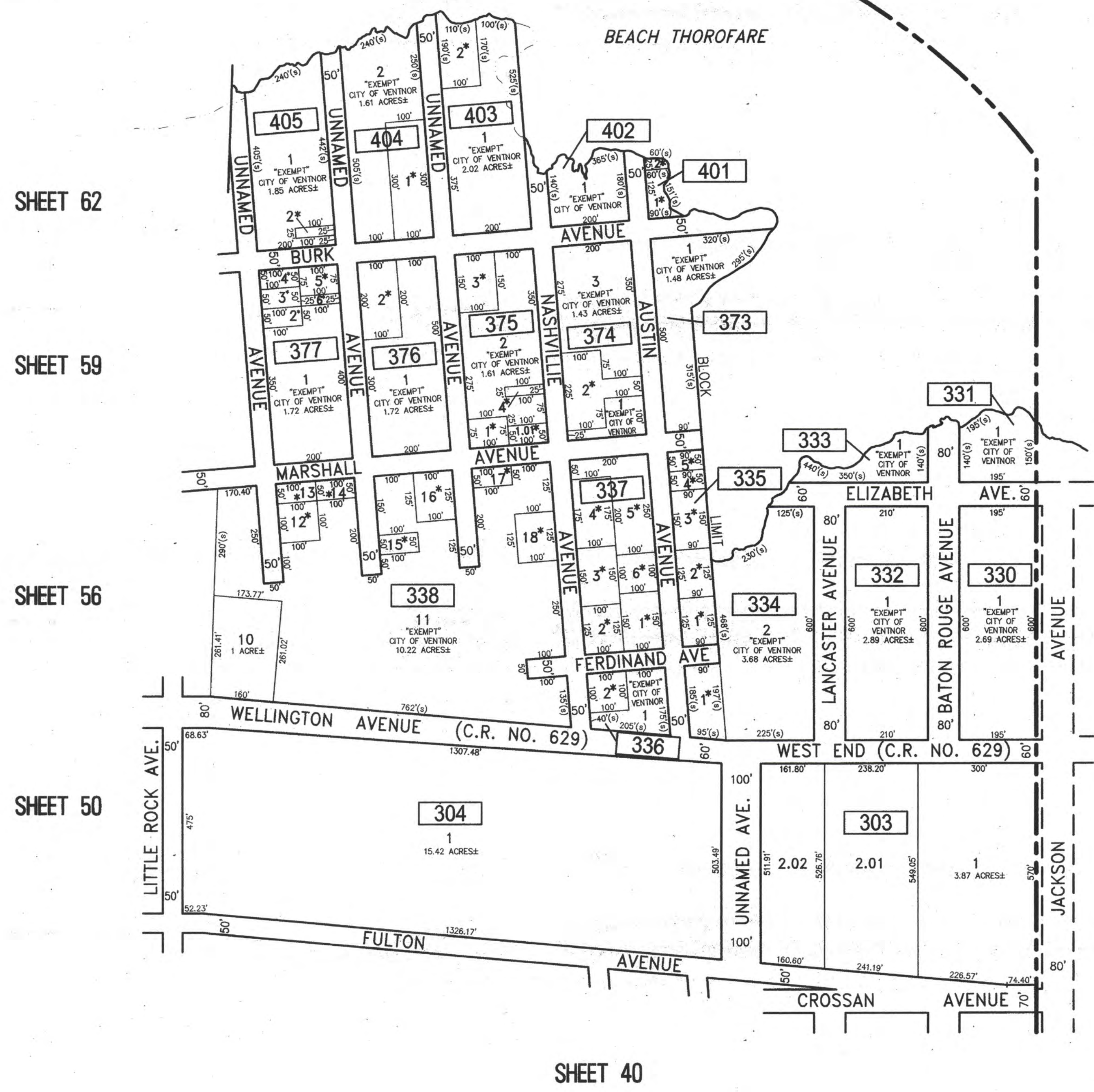
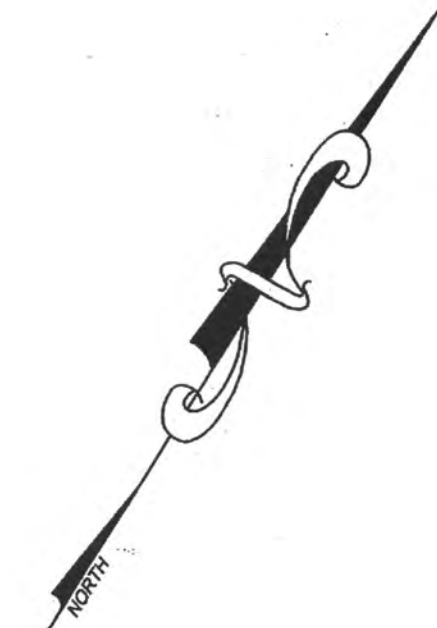

**CITY OF ATLANTIC CITY
 COUNTY OF ATLANTIC**

LOT NO* "EXEMPT" - CITY OF VENTNOR

NEW JERSEY DEPARTMENT OF THE TREASURY
 DIVISION OF TAXATION
 APPROVED AS A TAX MAP PURSUANT TO THE AUTHORITY OF
 N.J.S.A. 54:1-4 AND N.J.S.A. 54:1-5
 FOR THE DIRECTOR, DIVISION OF TAXATION
Charles Miller CTA
Sp. Rep. City of Ventnor
 Date JUL 20 2016 SERIAL NO. 1070

**TAX MAP
 CITY OF VENTNOR**
 ATLANTIC COUNTY NEW JERSEY
 SCALE: 1" = 200' DATE: 2-19-2015
CHARLES E. ADAMSON NJ PROFESSIONAL LAND SURVEYOR LIC. NO. 42627
REMINGTON, VERNICK & WALBERG ENGINEERS
 845 N. MAIN STREET, PLEASANTVILLE, NJ 08232
 (609) 645-7800, FAX (609) 645-7076
 WEB SITE ADDRESS: WWW.RVW.COM
 TO SHOW CONDITIONS AS OF 7-20-2016