

REVISIONS		
DATE	NAME	NO.

NOTE:
THIS SHEET HAS BEEN DRAWN USING COMPUTER AIDED DRAFTING/DESIGN (CAD/D) AND COORDINATE GEOMETRY (COGO).

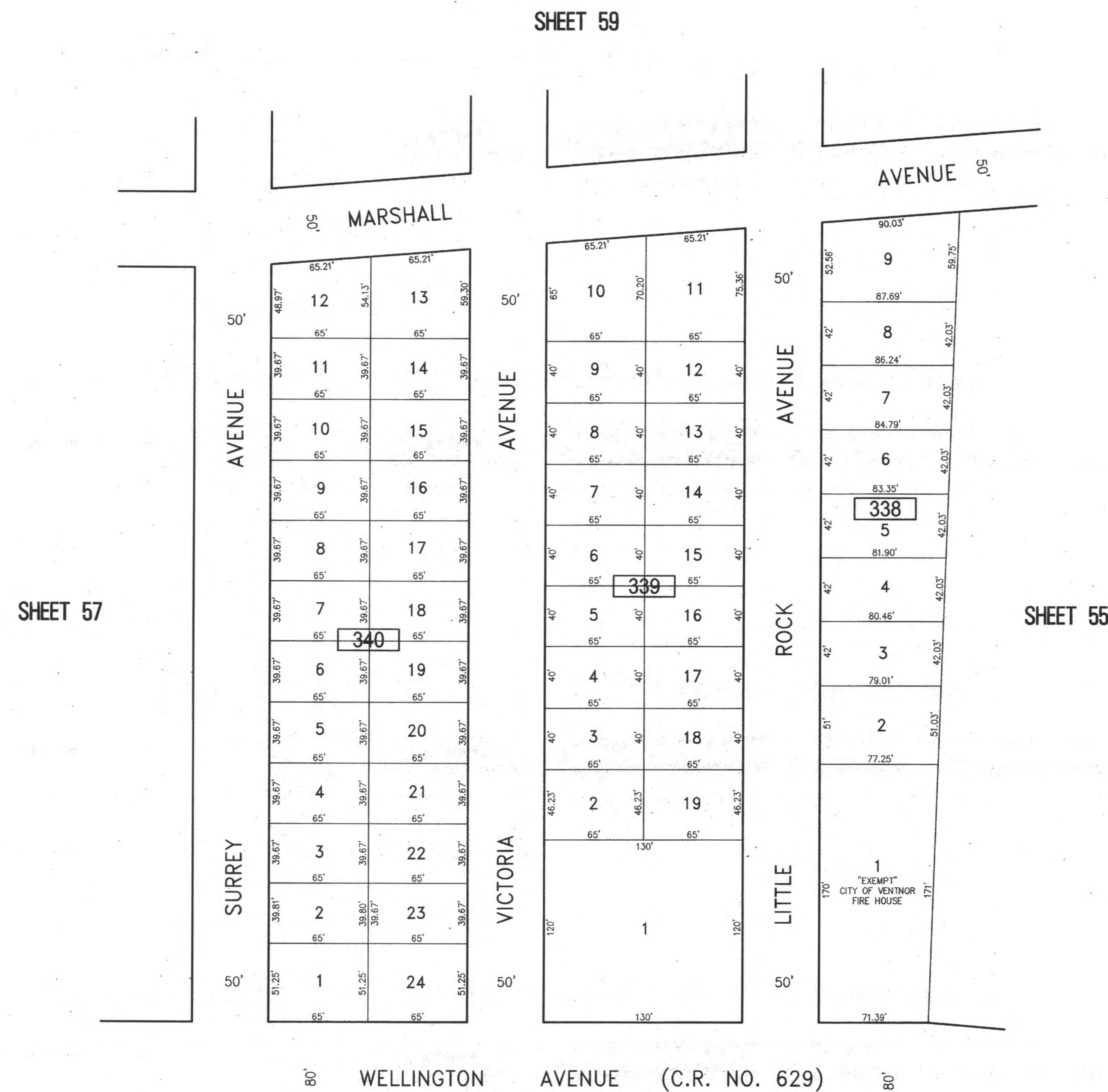

SHEET 57

SHEET 59

SHEET 55

SHEET 50

<p>NEW JERSEY DEPARTMENT OF THE TREASURY DIVISION OF TAXATION APPROVED AS A TAX MAP PURSUANT TO THE AUTHORITY OF N.J.S.A. 55:118 AND N.J.S.A. 55:20-4 FOR THE DIRECTOR, DIVISION OF TAXATION <i>John P. Miller, CTA</i> John P. Miller, CTA, Chief Property Administration <i>Charles E. Adamson, CTA</i> Charles E. Adamson, CTA, Professional Land Surveyor DATE: JUL 20 2016 SERIAL NO. 1070</p>	<p>TAX MAP CITY OF VENTNOR ATLANTIC COUNTY NEW JERSEY SCALE: 1" = 50' DATE: 2-19-2015 CHARLES E. ADAMSON NJ PROFESSIONAL LAND SURVEYOR LIC. NO. 42827 REMINGTON, VERNICK & WALBERG ENGINEERS 24 GA 28048700 845 N. MAIN STREET, PLEASANTVILLE, NJ 08232 (609) 645-780, FAX (609) 645-7076 WEB SITE ADDRESS WWW.RVW.COM TO SHOW CONDITIONS AS OF 7-20-2016</p>
---	--