

SHEET 108

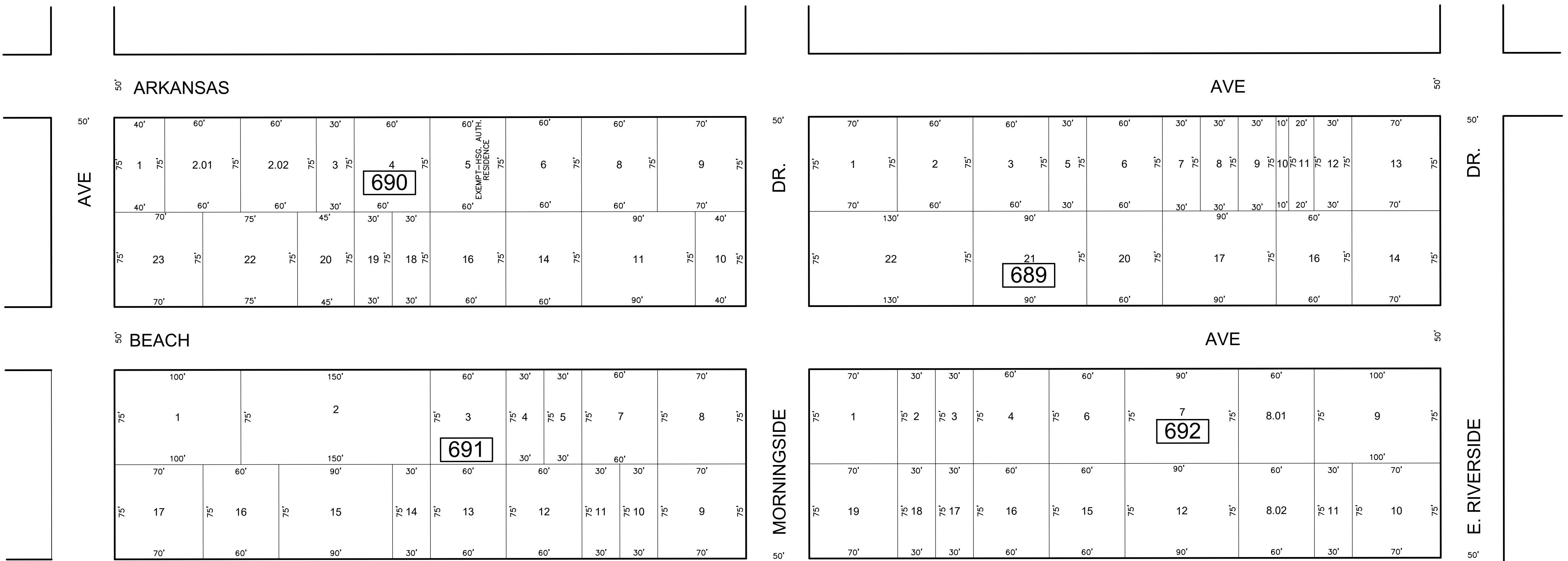

SHEET 110

COLUMBIA AVE

MISSISSIPPI AVE

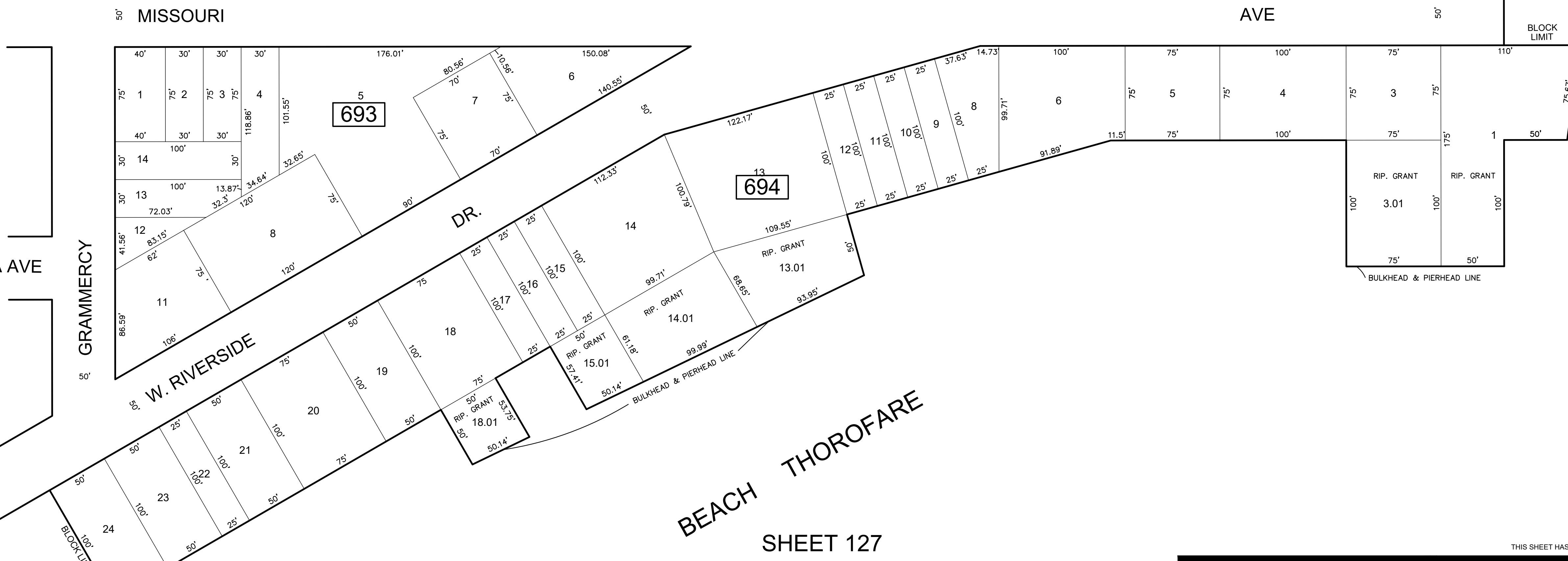

PENROSE CANAL

SHEET 105

SHEET 127

THIS SHEET HAS BEEN DRAWN USING COMPUTER AIDED DRAFTING/DESIGN (CADD)

THIS MAP HAS BEEN GIVEN A FORMAL CERTIFICATION BY THE DIVISION OF TAXATION ON NOVEMBER 25, 1997, SIGNED BY WILLIAM H. BLACK, CTA AND ASSIGNED SERIAL NUMBER 778

REVISIONS				
DATE	BY	LIC. NO.	BLOCK	LOT
09/2013	CHARLES A. ATKINSON-ARH	33994	689	14
07/2015	CHARLES A. ATKINSON-ARH	33994	692	8
05/2017	ED CLAY - ARH	34842	691	6-7

TAX MAP  
CITY OF ATLANTIC CITY

ATLANTIC COUNTY, NEW JERSEY  
SCALE: 1" = 50'

JOSEPH M DOLAN, PLS, PP

MUNICIPAL LAND SURVEYOR  
NEW JERSEY LICENSE NO. 23930  
OFFICE OF THE CITY ENGINEER  
603 CITY HALL  
ATLANTIC CITY, NEW JERSEY 08401

TO SHOW CONDITIONS AS OF MAY 2019

COA# 24GA27973300