

3726 SOUTH BOULEVARD
CONDOMINIUM

367

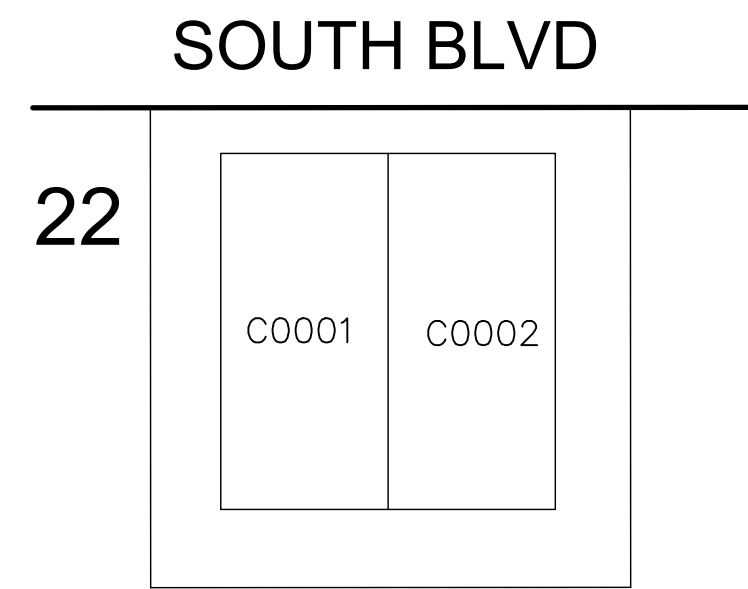

0.06 Ac± TOTAL
SCALE: 1"=20'

QUAL	UNIT TYPE	FLOOR	SQ.FT
C0001		1	1276
C0002		1	1276

3920 SOUTH BOULEVARD
CONDOMINIUM

367

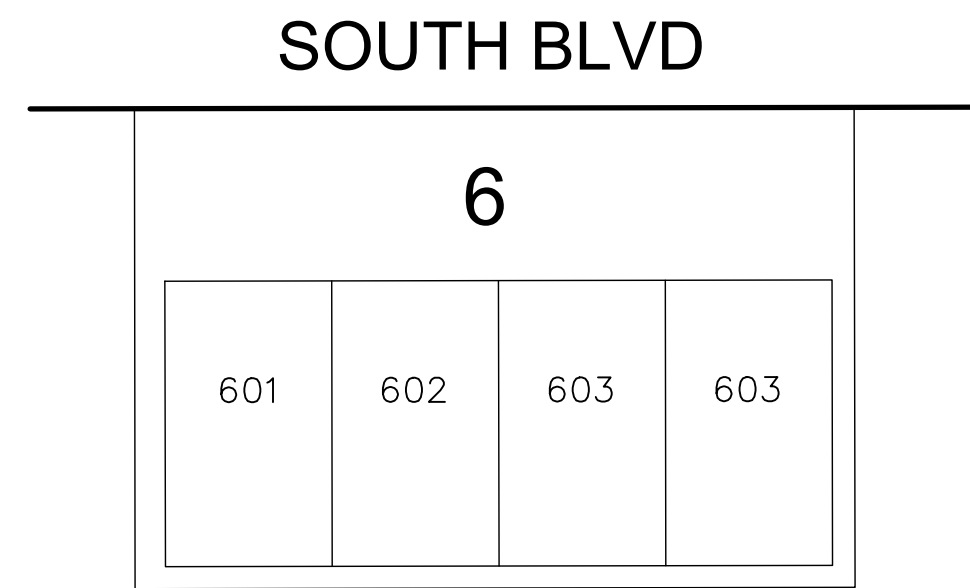

0.09 Ac± TOTAL
SCALE: 1"=20'

UNIT	UNIT TYPE	FLOOR	SQ.FT
601		1	805
602		1	805
603		1	805
604		1	805

REVISIONS				
DATE	BY	LIC.NO	BLOCK	LOT

THIS MAP HAS BEEN GIVEN A
FORMAL CERTIFICATION BY THE
DIVISION OF TAXATION ON
NOVEMBER 25, 1997, SIGNED BY
WILLIAM H. BLACK, CTA AND
ASSIGNED SERIAL NUMBER 778

TAX MAP
CITY OF ATLANTIC CITY
ATLANTIC COUNTY, NEW JERSEY
NOT TO SCALE DATE: AUG 1995
JOSEPH M DOLAN, PLS, PP
MUNICIPAL LAND SURVEYOR
NEW JERSEY LICENSE NO. 23930
OFFICE OF THE CITY ENGINEER
603 CITY HALL
ATLANTIC CITY, NEW JERSEY 08401

TO SHOW CONDITIONS AS OF MAY 2019
COA# 24GA27973300