

"HAMPTON COURT"
CONDOMINIUMS
BLOCK 259 LOT 13

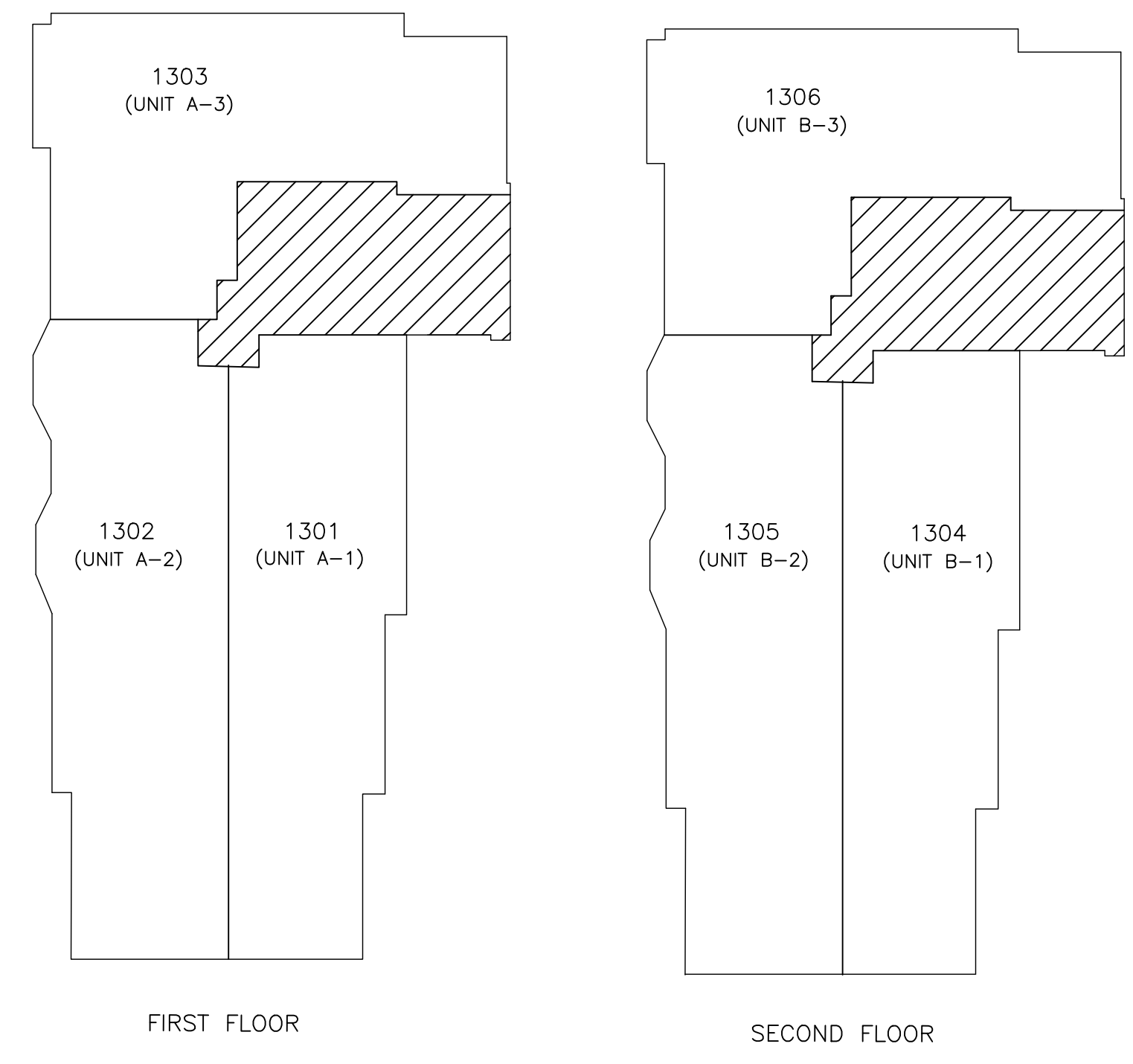

FIRST FLOOR
SECOND FLOOR

COMMON AREA

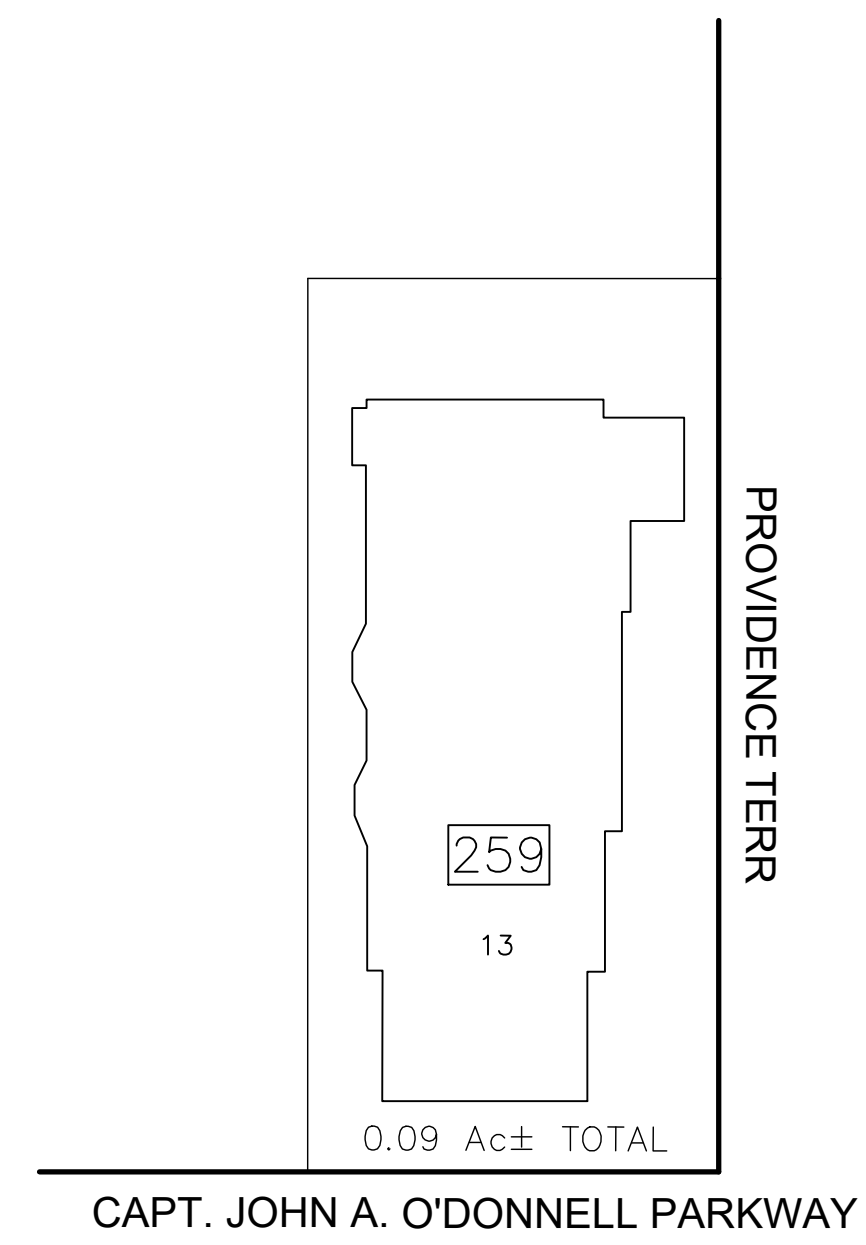

CAPT. JOHN A. O'DONNELL PARKWAY

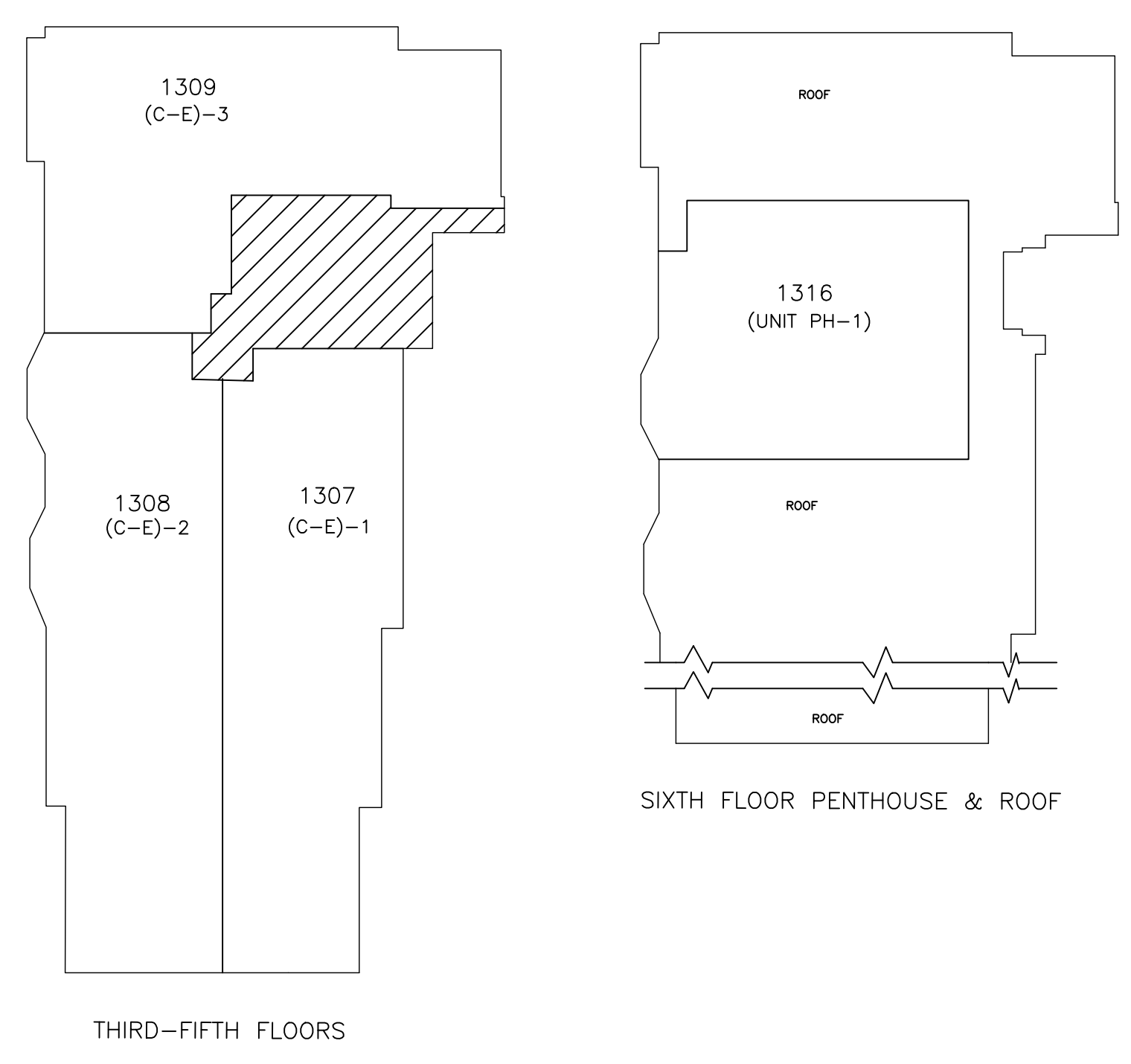

THIRD-FIFTH FLOORS
SIXTH FLOOR PENTHOUSE & ROOF

QUAL	UNIT TYPE	FLOOR	SQ.FT
C0101		1	704
C0102		1	704
C0103		1	641
C0201		2	838
C0202		2	641
C0203		2	641
C0301		3	838
C0302		3	1196
C0303		3	641
C0401		4	838
C0402		4	704
C0403		4	641
C0501		5	838
C0502		5	1196
C0503		5	641
C9001		6	383

REVISIONS				
DATE	BY	LIC.NO	BLOCK	LOT

THIS MAP HAS BEEN GIVEN A FORMAL CERTIFICATION BY THE DIVISION OF TAXATION ON NOVEMBER 25, 1997, SIGNED BY WILLIAM H. BLACK, CTA AND ASSIGNED SERIAL NUMBER 778

TAX MAP
CITY OF ATLANTIC CITY
ATLANTIC COUNTY, NEW JERSEY
NOT TO SCALE
DATE: AUG 1995
JOSEPH M DOLAN, PLS, PP
MUNICIPAL LAND SURVEYOR
NEW JERSEY LICENSE NO. 23930
OFFICE OF THE CITY ENGINEER
603 CITY HALL
ATLANTIC CITY, NEW JERSEY 08401
TO SHOW CONDITIONS AS OF MAY 2019
COA# 24GA27973300