

REVISIONS			
DATE	BY	LIC. No.	COMMENTS
1/1/18	MATTHEW F. DORAN	26273	VARIOUS

SHEET 48

CONDO LIST

BLOCK	LOT	UNIT	SQ. FT.	REMARKS
4700	128.01	A	1108	1 ST FLOOR
4700	128.02	B	1108	2 ND FLOOR
4901	4.01	A	1131	SIDE BY SIDE
4901	4.02	B	1131	SIDE BY SIDE
4901	5.01	A	1008	1ST FLOOR
4901	5.02	B	1008	2ND FLOOR
4901	19.01	A	1092	1ST FLOOR
4901	19.02	B	1092	2ND FLOOR
4901	26.01	A	1164	1ST FLOOR
4901	26.02	B	1164	2ND FLOOR
4901	34.01	A	1260	1ST FLOOR
4901	34.02	B	1270	2ND FLOOR
4901	36.01	A	1276	1ST FLOOR
4901	36.02	B	1276	2ND FLOOR
4901	37.01	A	1276	1ST FLOOR
4901	37.02	B	1276	2ND FLOOR
4901	39.01	A	1332	1ST FLOOR
4901	39.02	B	1332	2ND FLOOR
4901	44.01	A	1164	1ST FLOOR
4901	44.02	B	1164	2ND FLOOR
4901	45.01	A	1164	1ST FLOOR
4901	45.02	B	1164	2ND FLOOR
4901	49.01	A	1296	1ST FLOOR
4901	49.02	B	1296	2ND FLOOR
4901	50.01	A	1164	1ST FLOOR
4901	50.02	B	1164	2ND FLOOR
4902	1.01	A	1120	1ST FLOOR
4902	1.02	B	1182	2ND FLOOR
4902	3.01	A	1120	1ST FLOOR
4902	3.02	B	1120	2ND FLOOR
4902	9.01	A	1008	1ST FLOOR
4902	9.02	B	1008	2ND FLOOR
4902	10.01	A	1092	1ST FLOOR
4902	10.02	B	1092	2ND FLOOR
4902	15.01	A	1008	1ST FLOOR
4902	15.02	B	1008	2ND FLOOR
4902	21.01	A	1008	1ST FLOOR
4902	21.02	B	1008	2ND FLOOR
4902	29.01	A	1008	1ST FLOOR
4902	29.02	B	1008	2ND FLOOR
4902	30.01	A	1008	1ST FLOOR
4902	30.02	B	1008	2ND FLOOR
4902	31.01	A	1776	SW SIDE
4902	31.02	B	1776	NE SIDE
4902	34.01	A	1036	1ST FLOOR
4902	34.02	B	1036	2ND FLOOR

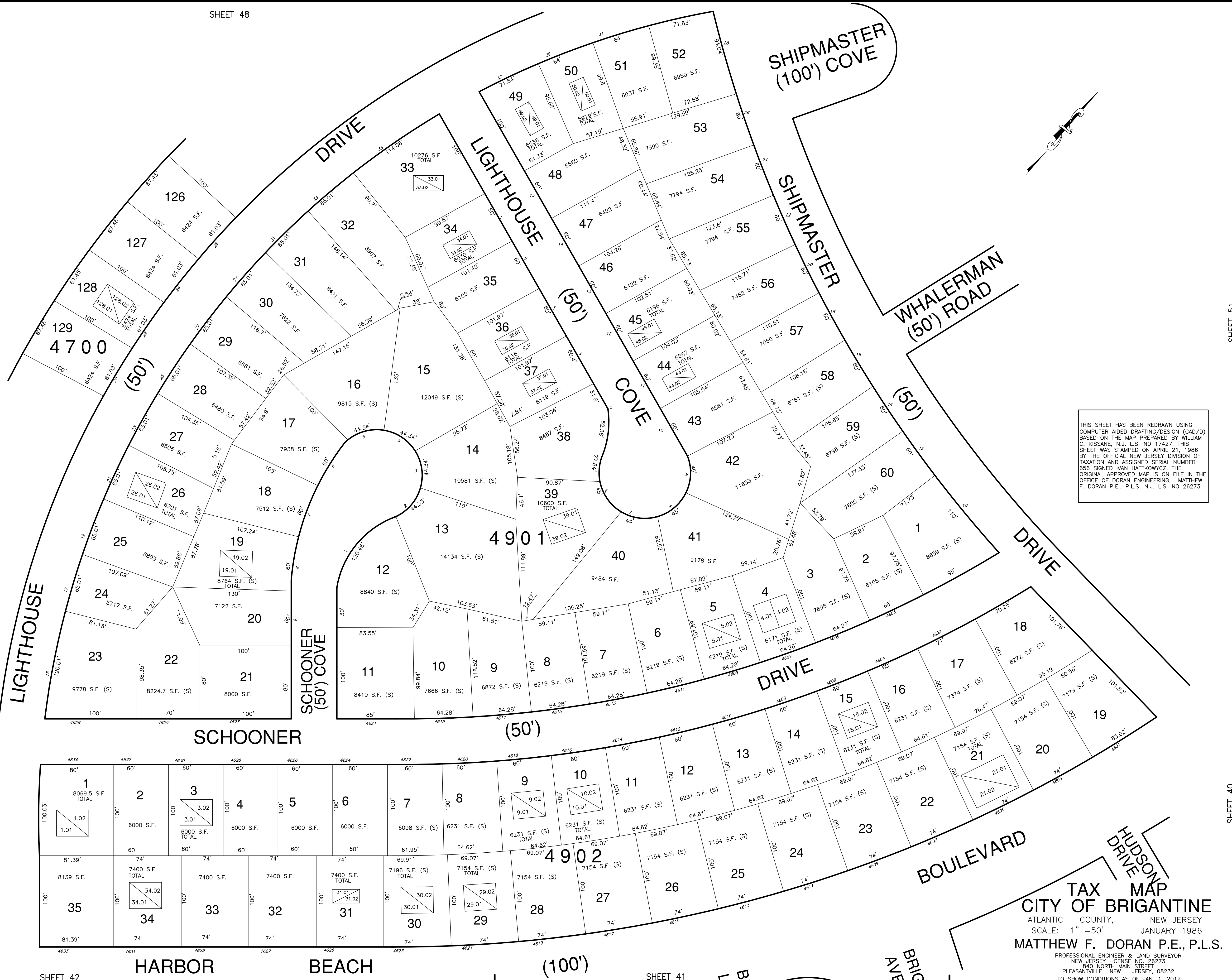

THIS SHEET HAS BEEN REDRAWN USING COMPUTER AIDED DRAFTING/DESIGN (CAD/D) BASED ON THE MAP PREPARED BY WILLIAM C. KISSANE, N.J. L.S. NO 17427. THIS SHEET WAS STAMPED ON APRIL 21, 1986 BY THE OFFICIAL NEW JERSEY DIVISION OF TAXATION AND ASSIGNED SERIAL NUMBER 656. SIGNED IVAN HAFKOWYCZ, THE ORIGINAL APPROVED MAP IS ON FILE IN THE OFFICE OF DORAN ENGINEERING, MATTHEW F. DORAN P.E., P.L.S. N.J. L.S. NO 26273.

TAX MAP
CITY OF BRIGANTINE
 ATLANTIC COUNTY, NEW JERSEY
 SCALE: 1" = 50'
 JANUARY 1986
MATTHEW F. DORAN P.E., P.L.S.
 PROFESSIONAL ENGINEER & LAND SURVEYOR
 NEW JERSEY LICENSE NO. 26273
 840 NORTH MAIN STREET
 PLEASANTVILLE, NEW JERSEY, 08232
 TO SHOW CONDITIONS AS OF JAN. 1, 2012.

SHEET 47

SHEET 42

HARBOR BEACH

BEACH

(100')

SHEET 41

BEACON LANE

BRIGANTINE AVE (100')

SHEET 51

SHEET 40