

REVISIONS  
WPHA 2-16-93  
WPHA 9-13-93

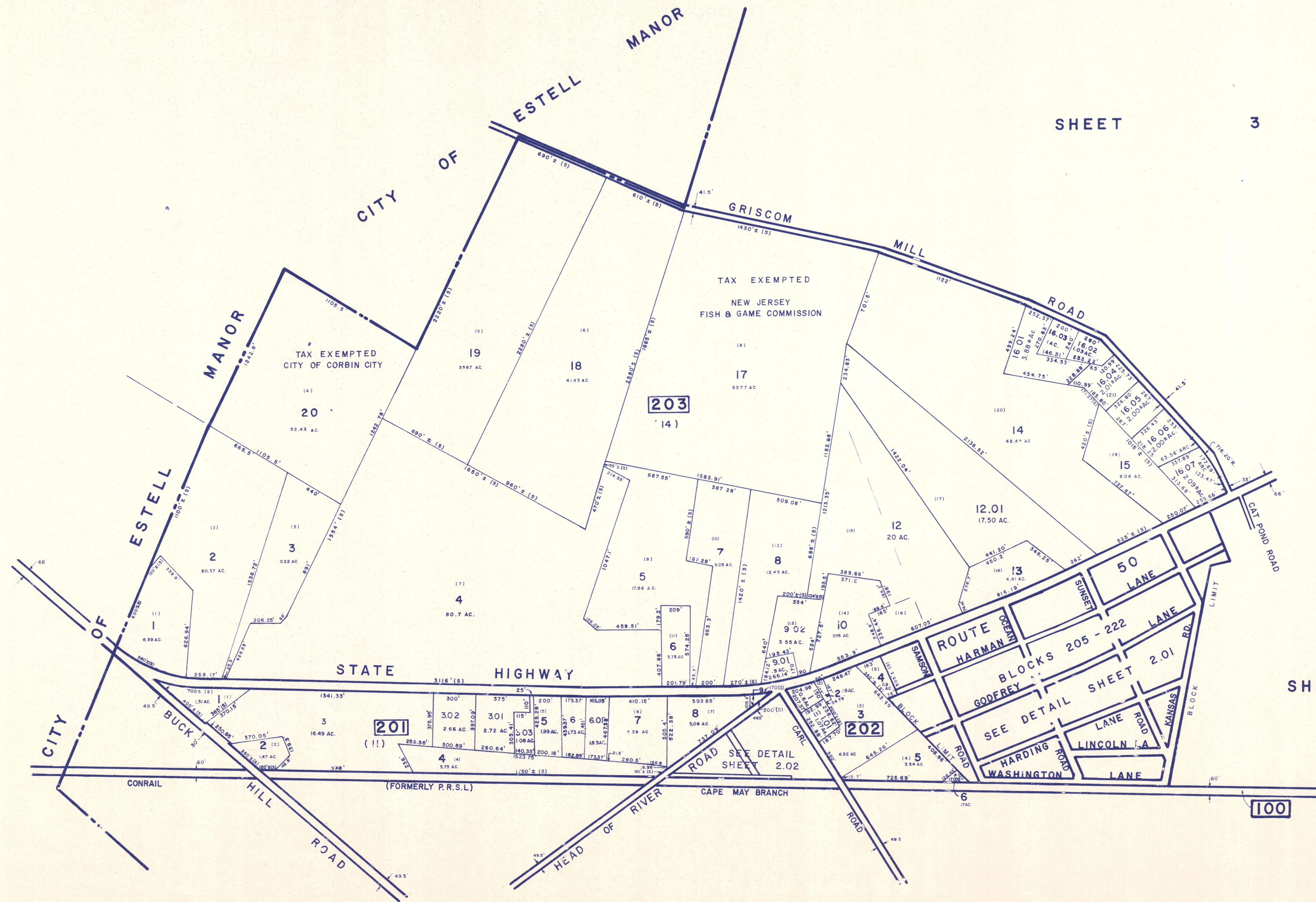

SHEET 3

SHEET 4

SHEET 1

NEW JERSEY DEPARTMENT OF THE TREASURY  
DIVISION OF TAXATION  
PROPERTY AND PUBLIC UTILITIES  
APPROVED AS A TAX MAP PURSUANT TO  
PROVISIONS OF CHAPTER 175, LAWS OF 1924  
FOR THE DIRECTOR, DIVISION OF TAXATION

*J. H. DeVane*  
P.E. & L.S.  
CHIEF

FEB 11 1976  
SERIAL NO. 553

**TAX MAP**  
**CITY OF CORBIN CITY**  
ATLANTIC COUNTY, NEW JERSEY  
SCALE: 1" = 400' JANUARY, 1975

CHRIS R. REHMANN  
PROFESSIONAL ENGINEER & LAND SURVEYOR  
NEW JERSEY LICENSE NO. 17119  
850 WHITE HORSE PIKE  
HAMMONTON, NEW JERSEY

WPHA 4-10-87  
REVISIONS