

REVISIONS			
DATE	BY	LIC. NO.	COMMENTS
1/22/2010	JAM	29918	
6/16/10	JAM	29918	
2/15/12	JAM	29918	
11/27/13	JAM	29918	
7/26/17	JAM	29918	
7/12/18	JAM	29918	
1/16/2020	JAM	29918	
12/8/2021	JAM	29918	

SHEET 5

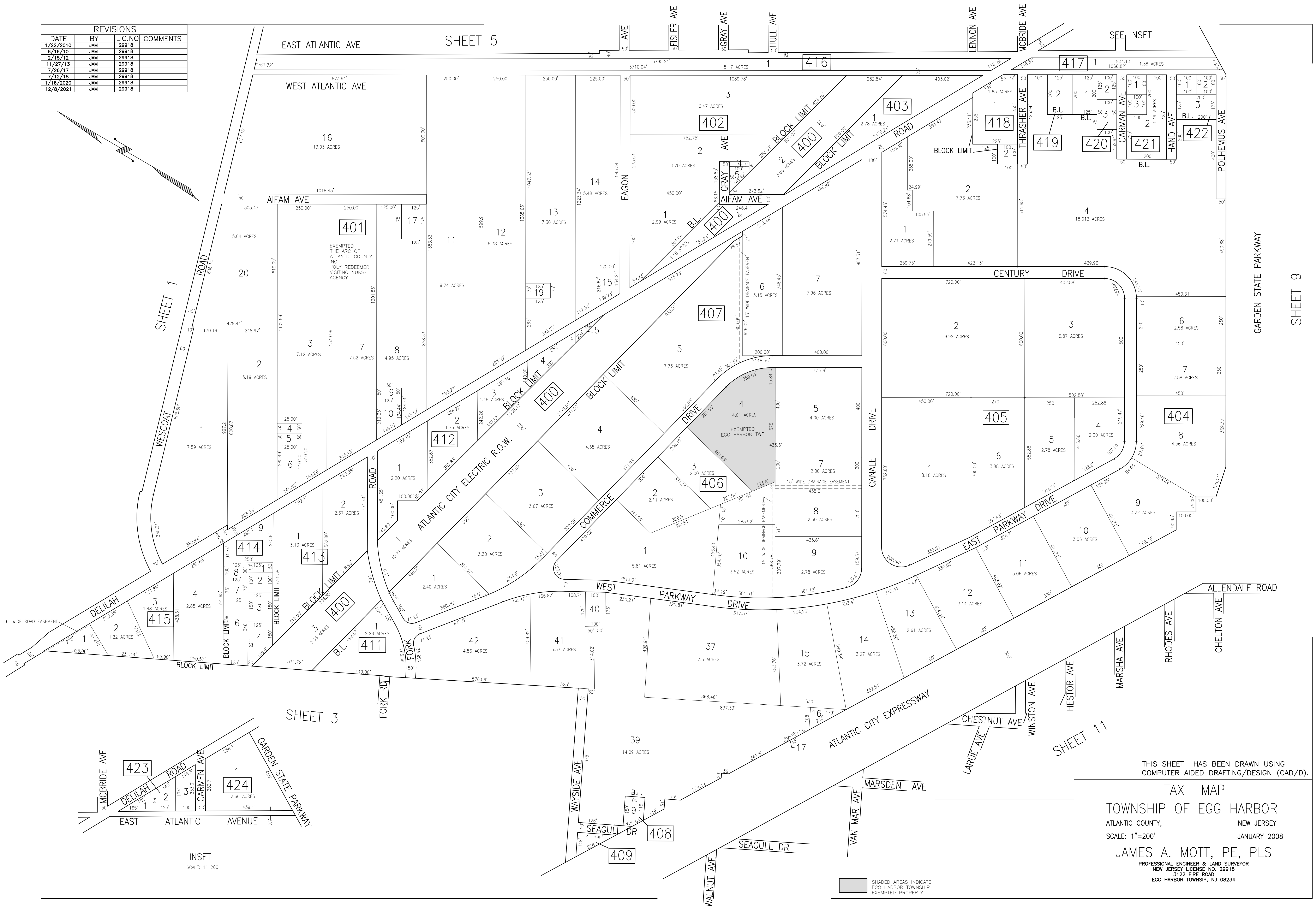

SHEET 1

SHEET 3

SHEET 11

SHEET 9

SEE INSET



INSET
SCALE: 1"=200'

THIS SHEET HAS BEEN DRAWN USING
COMPUTER AIDED DRAFTING/DESIGN (CAD/D).

TAX MAP
 TOWNSHIP OF EGG HARBOR
 ATLANTIC COUNTY, NEW JERSEY
 SCALE: 1"=200'
 JANUARY 2008
 JAMES A. MOTT, PE, PLS
 PROFESSIONAL ENGINEER & LAND SURVEYOR
 NEW JERSEY LICENSE NO. 29918
 3122 FIRE ROAD
 EGG HARBOR TOWNSHIP, NJ 08234

SHADED AREAS INDICATE
EGG HARBOR TOWNSHIP
EXEMPTED PROPERTY