

REVISIONS			
DATE	BY	LIC. NO.	COMMENTS
6/16/10	JAM	29918	
1/2/15	JAM	29918	
7/27/16	JAM	29918	
2/28/17	JAM	29918	
10/22/18	JAM	29918	

SHEET 36

SHEET 24

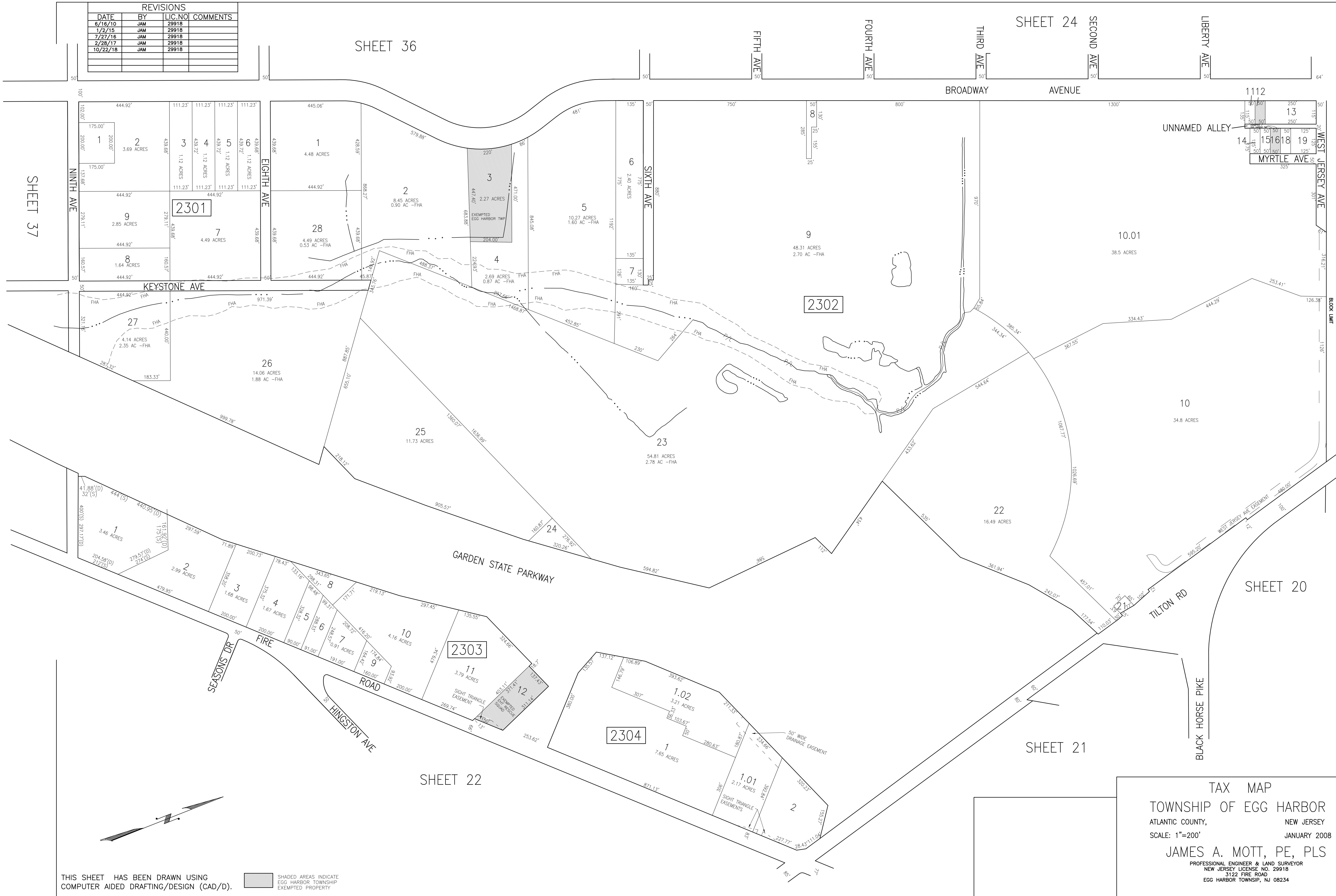

SHEET 37

SHEET 20

SHEET 20

SHEET 21

SHEET 22

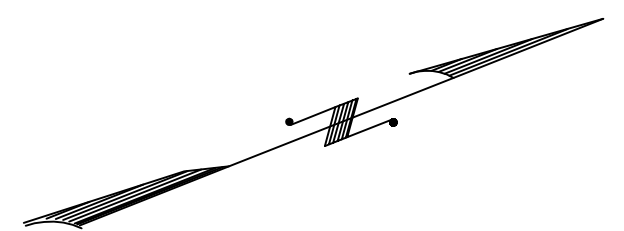

THIS SHEET HAS BEEN DRAWN USING
COMPUTER AIDED DRAFTING/DESIGN (CAD/D).

SHADED AREAS INDICATE
EGG HARBOR TOWNSHIP
EXEMPTED PROPERTY

TAX MAP
TOWNSHIP OF EGG HARBOR
ATLANTIC COUNTY, NEW JERSEY
SCALE: 1"=200' JANUARY 2008
JAMES A. MOTT, PE, PLS
PROFESSIONAL ENGINEER & LAND SURVEYOR
NEW JERSEY LICENSE NO. 29918
3122 FIRE ROAD
EGG HARBOR TOWNSHIP, NJ 08234