

REVISIONS				REVISIONS			
DATE	BY	LIC.NO	COMMENTS	DATE	BY	LIC.NO	COMMENTS
6/10/08	JAM	29918		3/24/2021	JAM	29918	EHT WC: 3-21
11/7/08	JAM	29918					
9/11/09	JAM	29918					
6/17/10	JAM	29918					
12/16/13	JAM	29918					
12/26/14	JAM	29918					
7/27/17	JAM	29918					
9/20/18	JAM	29918					

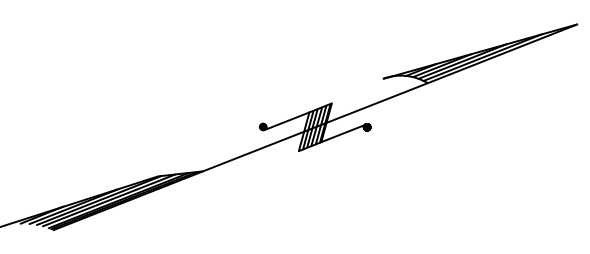
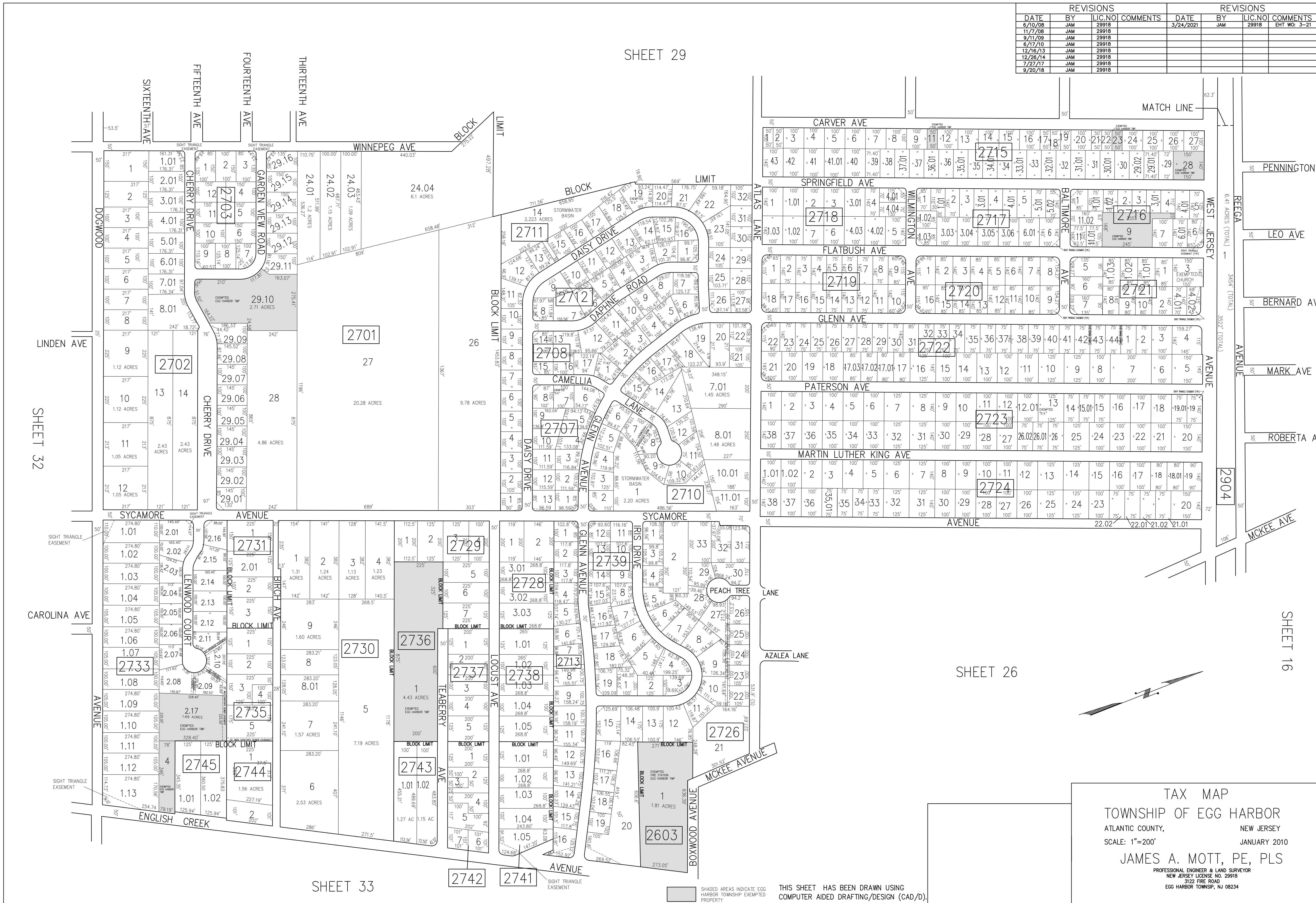

TAX MAP  
 TOWNSHIP OF EGG HARBOR  
 ATLANTIC COUNTY, NEW JERSEY  
 SCALE: 1"=200' JANUARY 2010  
 JAMES A. MOTT, PE, PLS  
 PROFESSIONAL ENGINEER & LAND SURVEYOR  
 NEW JERSEY LICENSE NO. 29918  
 3122 FIRE ROAD  
 EGG HARBOR TOWNSHIP, NJ 08234

THIS SHEET HAS BEEN DRAWN USING  
 COMPUTER AIDED DRAFTING/DESIGN (CAD/D).

SHADED AREAS INDICATE EGG  
 HARBOR TOWNSHIP EXEMPTED  
 PROPERTY

SHEET 32

SHEET 33

SHEET 16