

REVISIONS			
DATE	BY	LIC. NO.	COMMENTS
6/10/08	JAM	29918	
3/10/09	JAM	29918	
11/2/09	JAM	29918	
6/21/10	JAM	29918	
3/12/12	JAM	29918	
10/24/17	JAM	29918	
3/2/2022	JAM	29918	WO: 23-21

SHEET 41

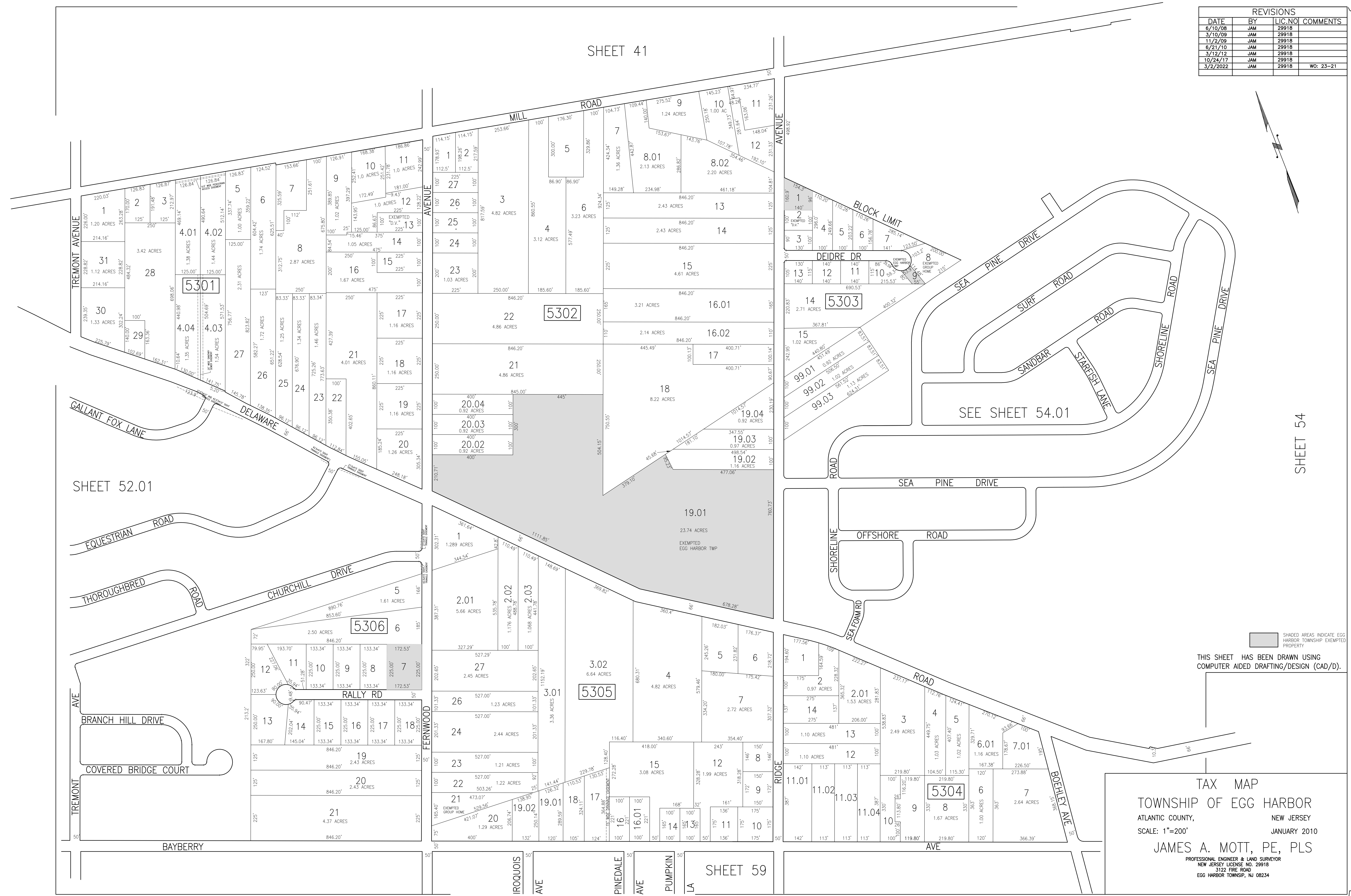
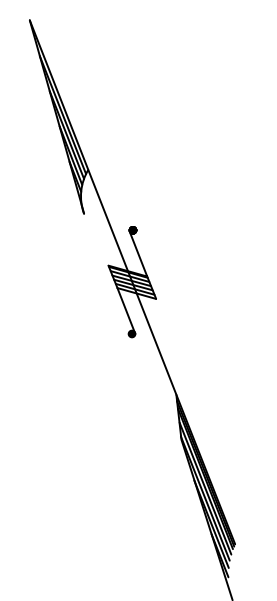

SHEET 52.01

SHEET 54

SHADED AREAS INDICATE EGG HARBOR TOWNSHIP EXEMPTED PROPERTY

THIS SHEET HAS BEEN DRAWN USING COMPUTER AIDED DRAFTING/DESIGN (CAD/D).

TAX MAP
 TOWNSHIP OF EGG HARBOR
 ATLANTIC COUNTY, NEW JERSEY
 SCALE: 1"=200'
 JANUARY 2010
 JAMES A. MOTT, PE, PLS
 PROFESSIONAL ENGINEER & LAND SURVEYOR
 NEW JERSEY LICENSE NO. 29918
 3122 FIRE ROAD
 EGG HARBOR TOWNSHIP, NJ 08234