

REVISIONS			
DATE	BY	LIC. NO	COMMENTS
2/25/08	JAM	29918	
9/11/09	JAM	29918	
5/5/10	JAM	29918	
6/17/10	JAM	29918	
8/2/10	JAM	29918	
12/16/13	JAM	29918	
7/13/18	JAM	29918	

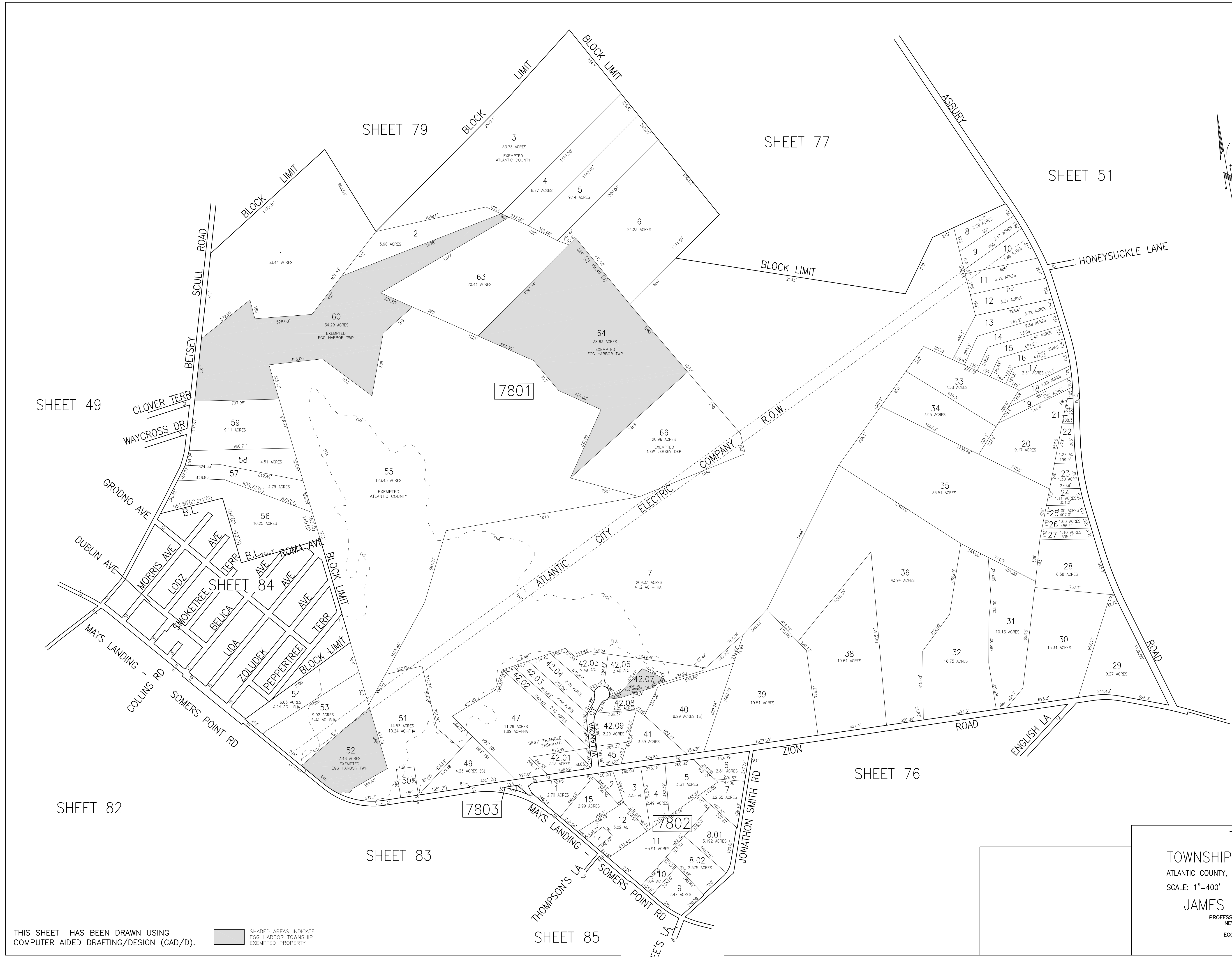

THIS SHEET HAS BEEN DRAWN USING COMPUTER AIDED DRAFTING/DESIGN (CAD/D). SHADED AREAS INDICATE EGG HARBOR TOWNSHIP EXEMPTED PROPERTY

TAX MAP
TOWNSHIP OF EGG HARBOR
ATLANTIC COUNTY, NEW JERSEY
SCALE: 1"=400' JANUARY 2010
JAMES A. MOTT, PE, PLS
PROFESSIONAL ENGINEER & LAND SURVEYOR
NEW JERSEY LICENSE NO. 29918
3122 FIRE ROAD
EGG HARBOR TOWNSHIP, NJ 08234