

REVISIONS			
DATE	BY	LIC. NO.	COMMENTS
3/11/10	JAM	29918	
6/17/10	JAM	29918	
7/27/17	JAM	29918	

THIS SHEET HAS BEEN DRAWN USING
COMPUTER AIDED DRAFTING/DESIGN (CAD/D).

SHADED AREAS INDICATE
EGG HARBOR TOWNSHIP
EXEMPTED PROPERTY

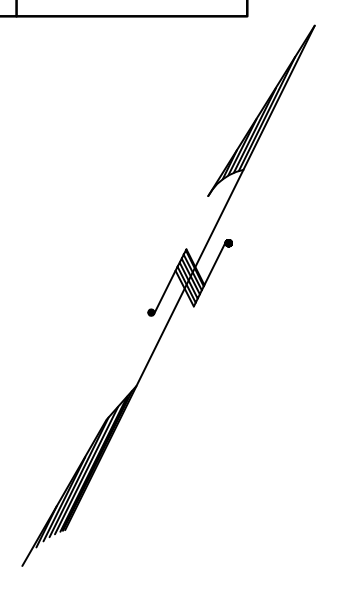

BETSEY SKULL ROAD
MATCH LINE
INSET
SCALE: 1"=200'

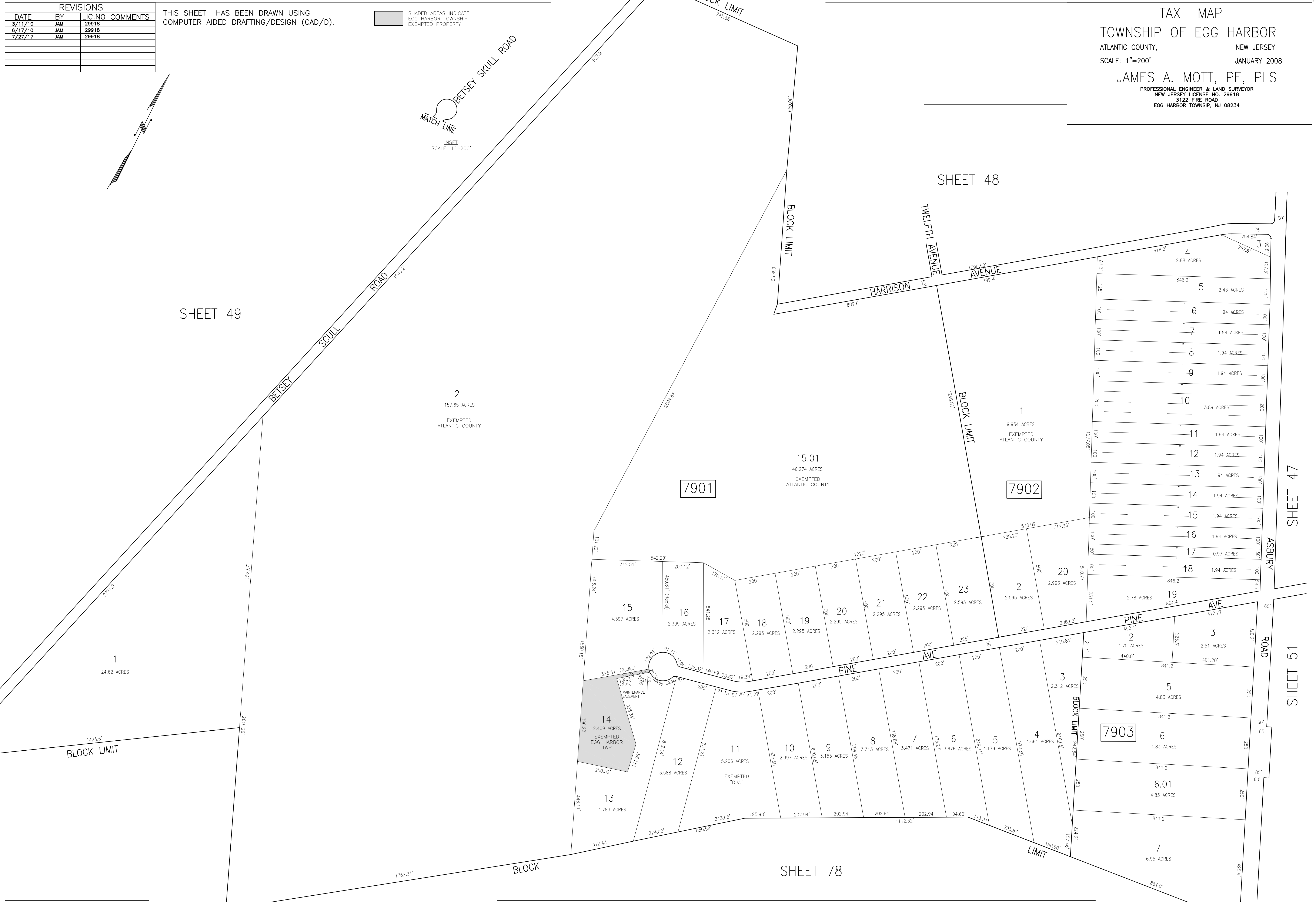

TAX MAP
TOWNSHIP OF EGG HARBOR
ATLANTIC COUNTY, NEW JERSEY
SCALE: 1"=200'
JANUARY 2008
JAMES A. MOTT, PE, PLS
PROFESSIONAL ENGINEER & LAND SURVEYOR
NEW JERSEY LICENSE NO. 29918
3122 FIRE ROAD
EGG HARBOR TOWNSHIP, NJ 08234

SHEET 49

SHEET 48

SHEET 47

SHEET 51

\\NTP\GIS\GIS\GDP\PROJECTS\TAX MAPS\2017\2017TAXMAP\BLOCK2017_408-54.PLM (DSC0089)