

REVISIONS			
DATE	BY	LIC. NO.	COMMENTS
6/18/10	JAM	2991B	
1/14/16	JAM	2991B	
10/24/17	JAM	2991B	
1/17/2020	JAM	2991B	

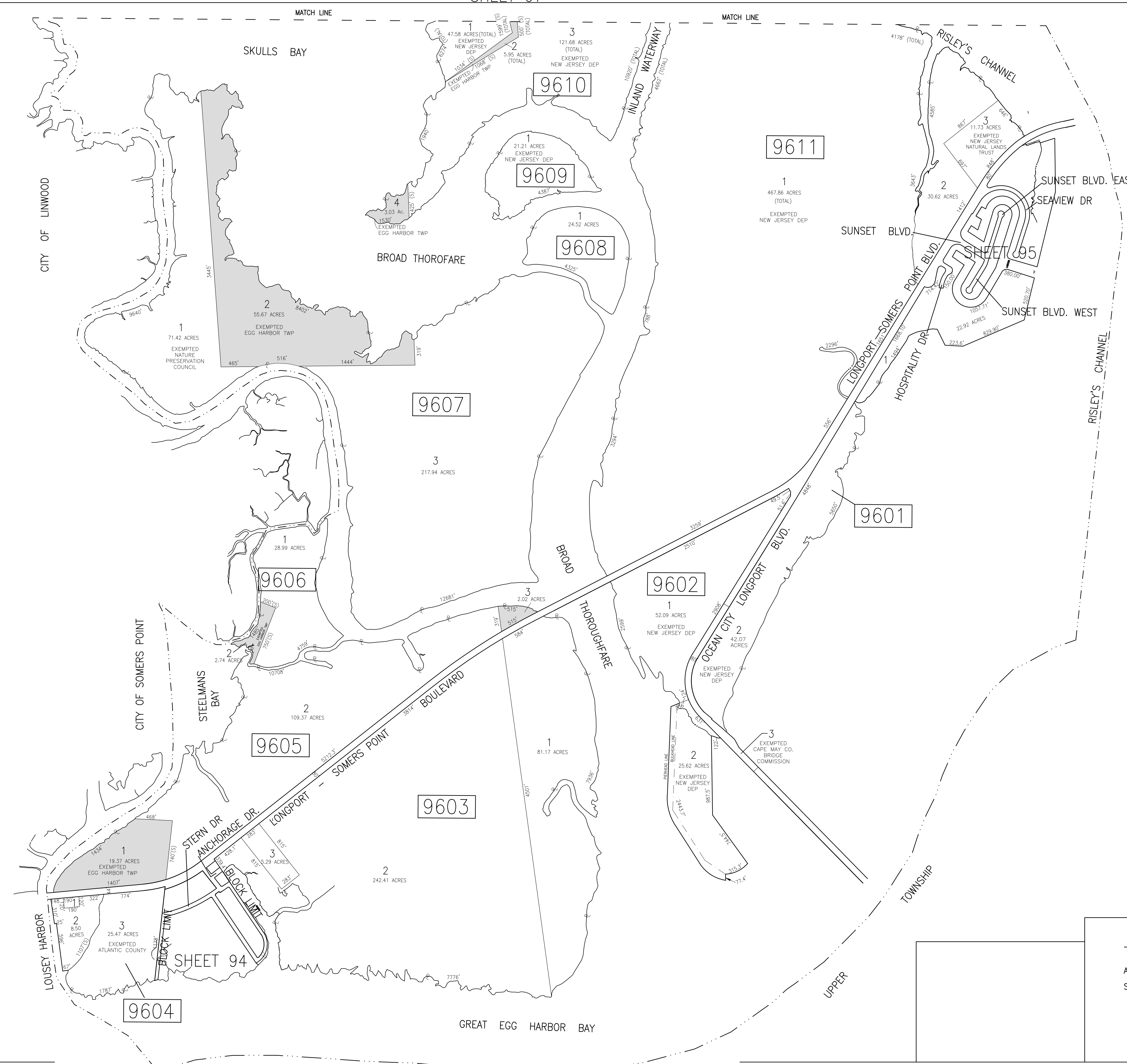
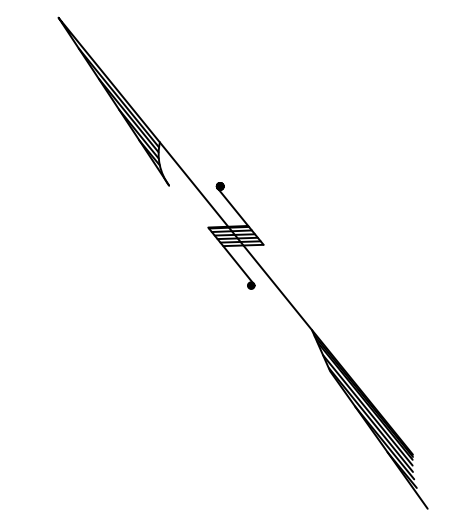

BORO OF LONGPORT

SHADED AREAS INDICATE
 EGG HARBOR TOWNSHIP
 EXEMPTED PROPERTY

THIS SHEET HAS BEEN DRAWN USING
COMPUTER AIDED DRAFTING/DESIGN (CAD/D).

TAX MAP
TOWNSHIP OF EGG HARBOR
 ATLANTIC COUNTY, NEW JERSEY
 SCALE: 1"=600' JANUARY 2008
JAMES A. MOTT, PE, PLS
 PROFESSIONAL ENGINEER & LAND SURVEYOR
 NEW JERSEY LICENSE NO. 2991B
 3122 FIRE ROAD
 EGG HARBOR TOWNSHIP, NJ 08234