

REVISIONS		
DATE	NAME	NUMBER
12/9/88	DOUGLAS R. LONG	PE & LS 16341
12/12/90	IRA J. MILOVSKY	PE & LS 27053
9/23/93	JOHN R. WALKER	PE & LS 10294
1/14/94	JOHN R. WALKER	PE & LS 10294
4/13/95	JOHN R. WALKER	PE & LS 10294
12-30-04	MICHAEL FRALINGER	PE & LS 29350
12-30-05	MICHAEL FRALINGER	PE & LS 29350

INDEX OF SHEETS

SHEET NUMBER	BLOCK NUMBERS
1	1,2,3,4,5,6,7,8
2	9,10,11,12,13,14,15
3	16,17,18,19,24,02 26,26.01,26.02
3.01	18.01,19.01
4	20,21,22,23 27,28,29
14	61,61.01,61.02,62 63,63.01,63.02
15	61.01,64,65

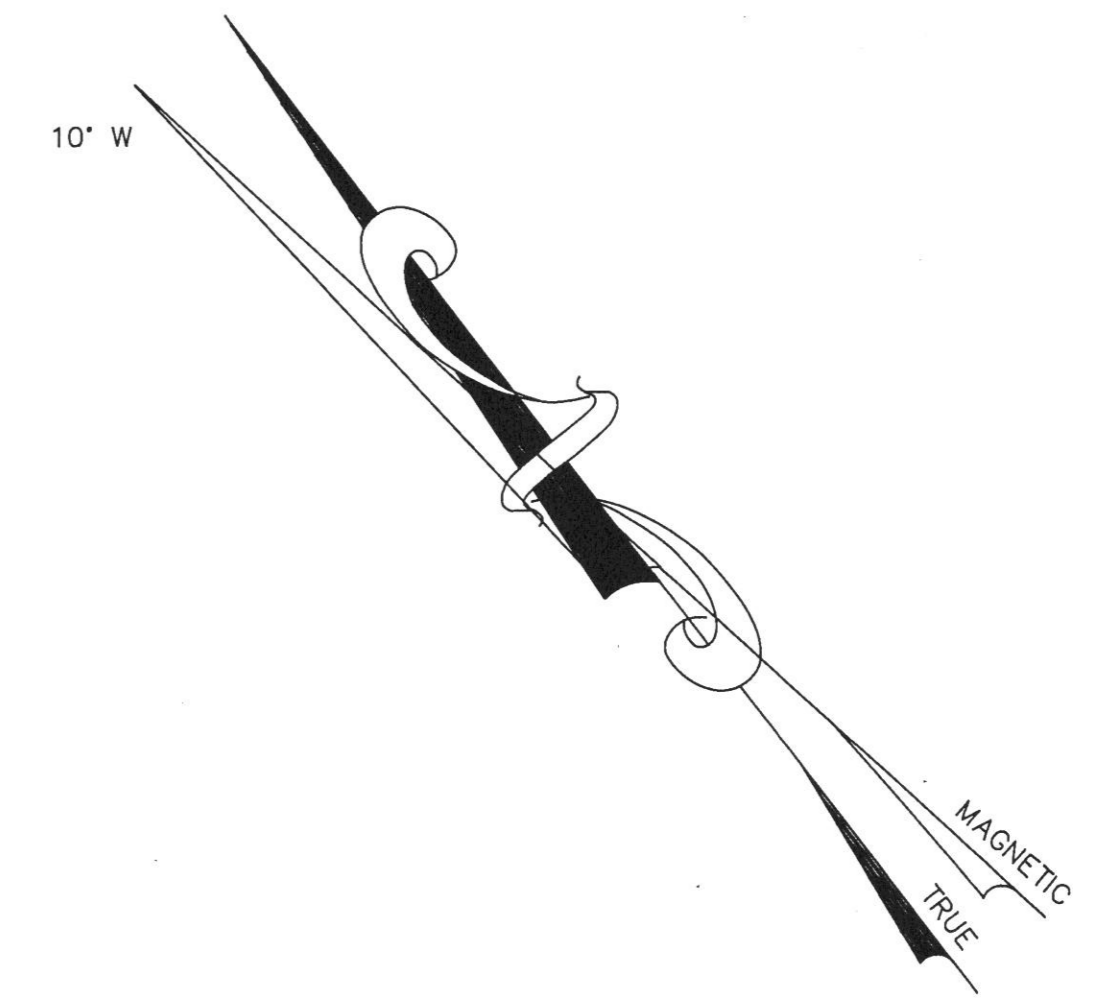
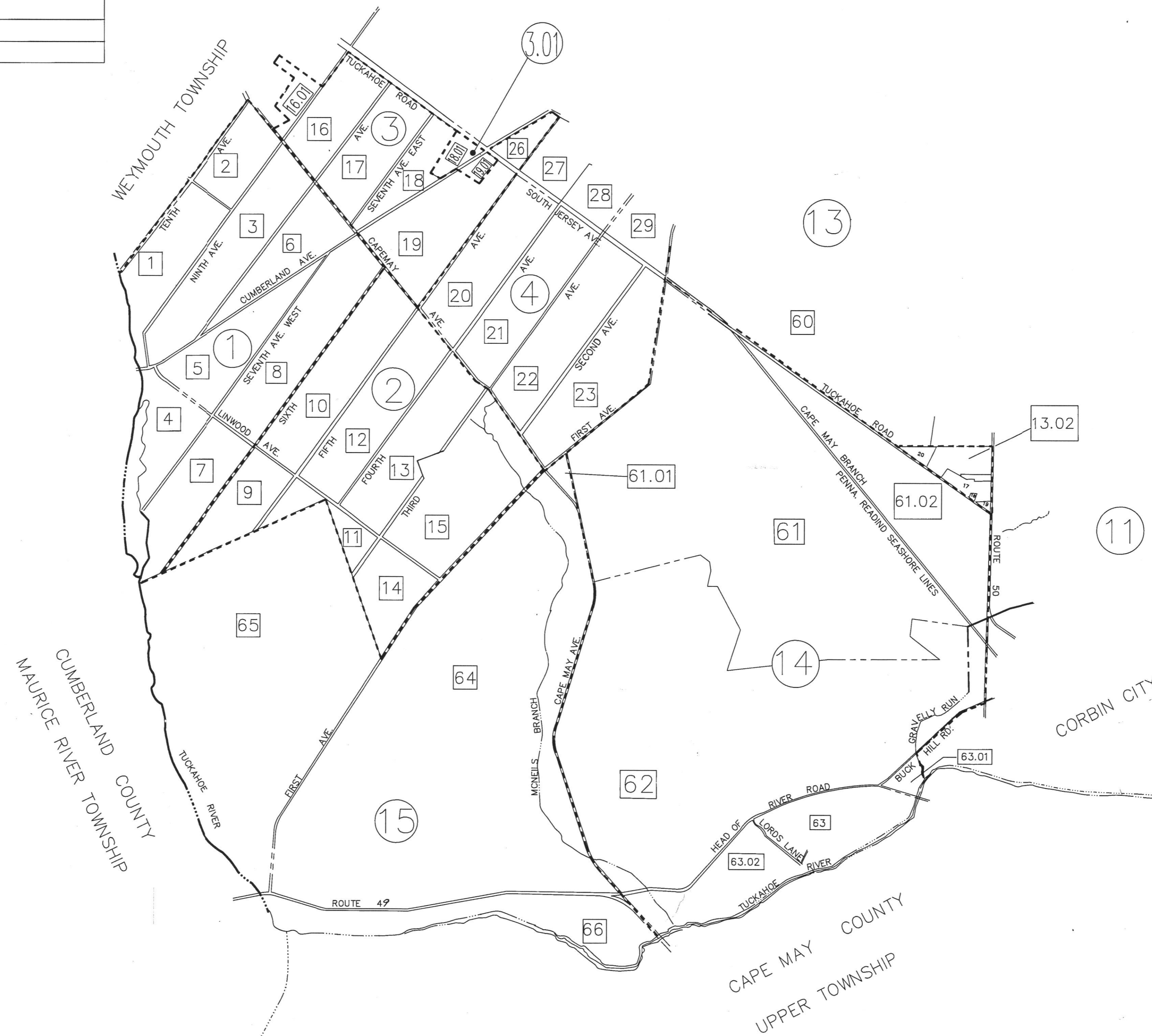

LEGEND

- 2 DETAIL SHEET NUMBER
- 2 BLOCK NUMBER
- SHEET LIMIT
- BLOCK LIMIT

NOTE:  
THE AREAS, BOUNDARIES AND DIMENSIONS, SHOWN ON THIS TAX MAP, ARE DERIVED FROM GROUND SURVEYS, AERIAL SURVEYS, AND RECORDED PLANS, MAPS, DEEDS, WILLS, AND ARE TO BE USED FOR ASSESSMENT PURPOSES ONLY.

1. TO SHOW CONDITIONS AS OF APRIL 1989
2. I HEREBY CERTIFY THAT THIS MAP AND ANY REQUIRED SURVEY HAS BEEN MADE UNDER MY IMMEDIATE SUPERVISION, AND COMPLIES WITH THE LAWS OF THE STATE OF NEW JERSEY.

DOUGLAS R. LONG, P.E. & L.S.  
NEW JERSEY 16341

DEPARTMENT OF TREASURY  
LOCAL PROPERTY BRANCH  
APPROVED AS A TAX MAP PURSUANT TO THE PROVISIONS OF CHAPTER 175, LAWS OF 1913, ETC. FOR THE DIRECTOR, DIVISION OF TAXATION  
By: *W. A. Hafferty* P.E. & L.S.  
LIC. # 15434  
DATE DEC 19 1989

**TAX MAP**  
**CITY OF ESTELL MANOR**  
ATLANTIC COUNTY, NEW JERSEY  
SCALE: 1"=1000' APRIL 1989  
**DOUGLAS R. LONG, P.E. & L.S.**  
LONG ENGINEERING & SURVEYING CO.  
591 N. Black Horse Pike Williamstown N.J. 08094