

REVISIONS

DATE	NAME	NUMBER
12/9/88	DOUGLAS R. LONG	PE + LS 16341
12/12/90	IRA J. MILOVSKY	PE & LS 27053
9/23/93	JOHN R. WALKER	PE & LS 10294
1/14/94	JOHN R. WALKER	PE & LS 10294
4/13/95	JOHN R. WALKER	PE & LS 10294

INDEX OF SHEETS

SHEET NUMBER	BLOCK NUMBERS
8	42,43,51
9	51,52,53,54
10	54,55
11	56

KEY MAP 0.02

NOTE:

THE AREAS, BOUNDARIES AND DIMENSIONS, SHOWN ON THIS TAX MAP, ARE DERIVED FROM GROUND SURVEYS, AERIAL SURVEYS, AND RECORDED PLANS, MAPS, DEEDS, WILLS, AND ARE TO BE USED FOR ASSESSMENT PURPOSES ONLY.

LEGEND

- 2 DETAIL SHEET NUMBER
- 2 BLOCK NUMBER
- SHEET LIMIT
- _____ BLOCK LIMIT

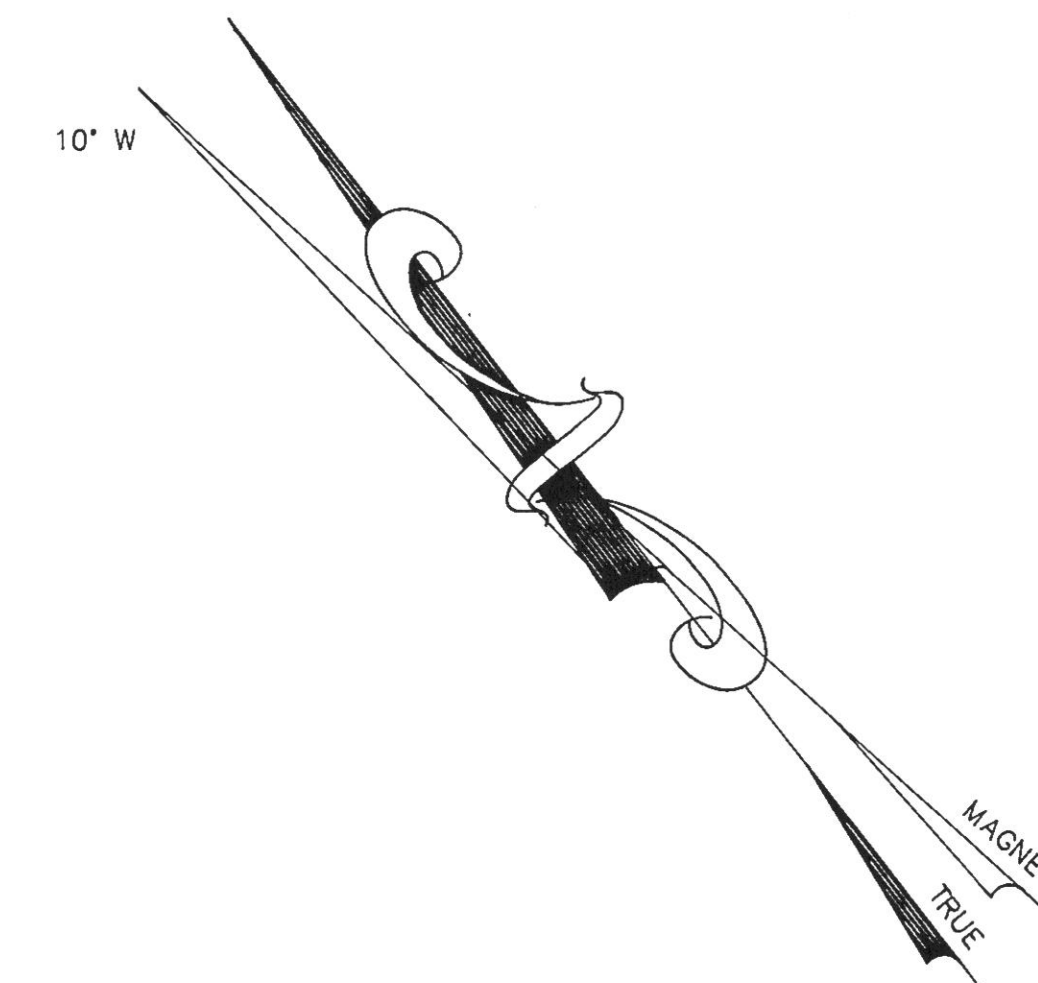
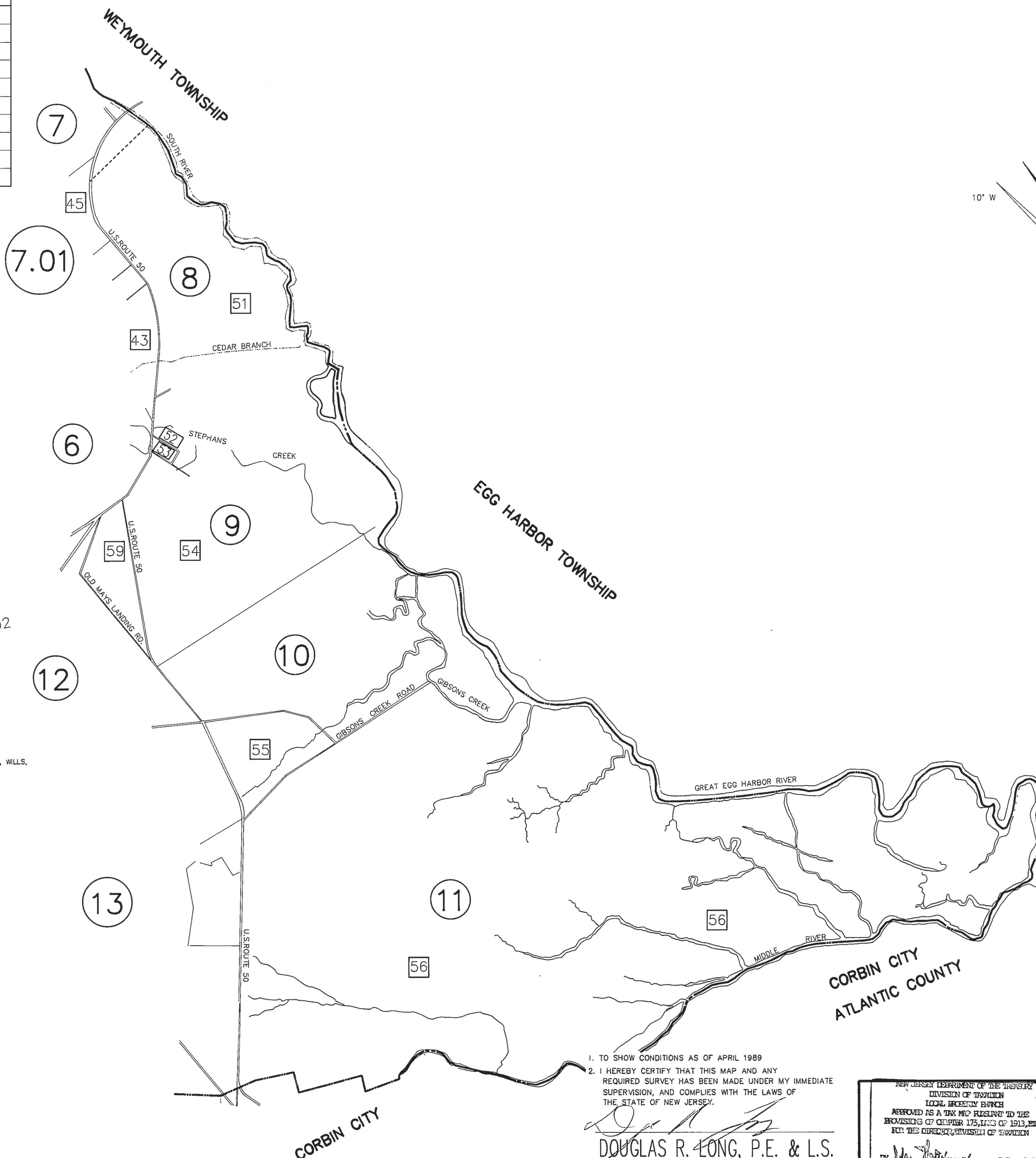

1. TO SHOW CONDITIONS AS OF APRIL 1989
 2. I HEREBY CERTIFY THAT THIS MAP AND ANY REQUIRED SURVEY HAS BEEN MADE UNDER MY IMMEDIATE SUPERVISION, AND COMPLIES WITH THE LAWS OF THE STATE OF NEW JERSEY.

Douglas R. Long
DOUGLAS R. LONG, P.E. & L.S.
 NEW JERSEY 16341

NEW JERSEY DEPARTMENT OF THE TREASURY
 DIVISION OF TAXATION
 LOCAL GOVERNMENT BRANCH
 APPROVED AS A TAX MAP PURSUANT TO THE PROVISIONS OF CHAPTER 175, L.I.C. OF 1913, ETC. FOR THE DIRECTOR, DIVISION OF TAXATION

Walter J. ... P.E. & L.S.
 L.I.C. # 15330 CIVIL ENGINEERING SECTION

EXPIRES 14 APRIL 1989 SERIAL NO. 700

TAX MAP
CITY OF ESTELL MANOR
 ATLANTIC COUNTY, NEW JERSEY
 SCALE: 1"=1000' APRIL 1989

DOUGLAS R. LONG, P.E. & L.S.
 LONG ENGINEERING & SURVEYING CO.
 591 N. Black Horse Pike Williamstown N.J. 08094