

REVISIONS		
DATE	NAME	NO.

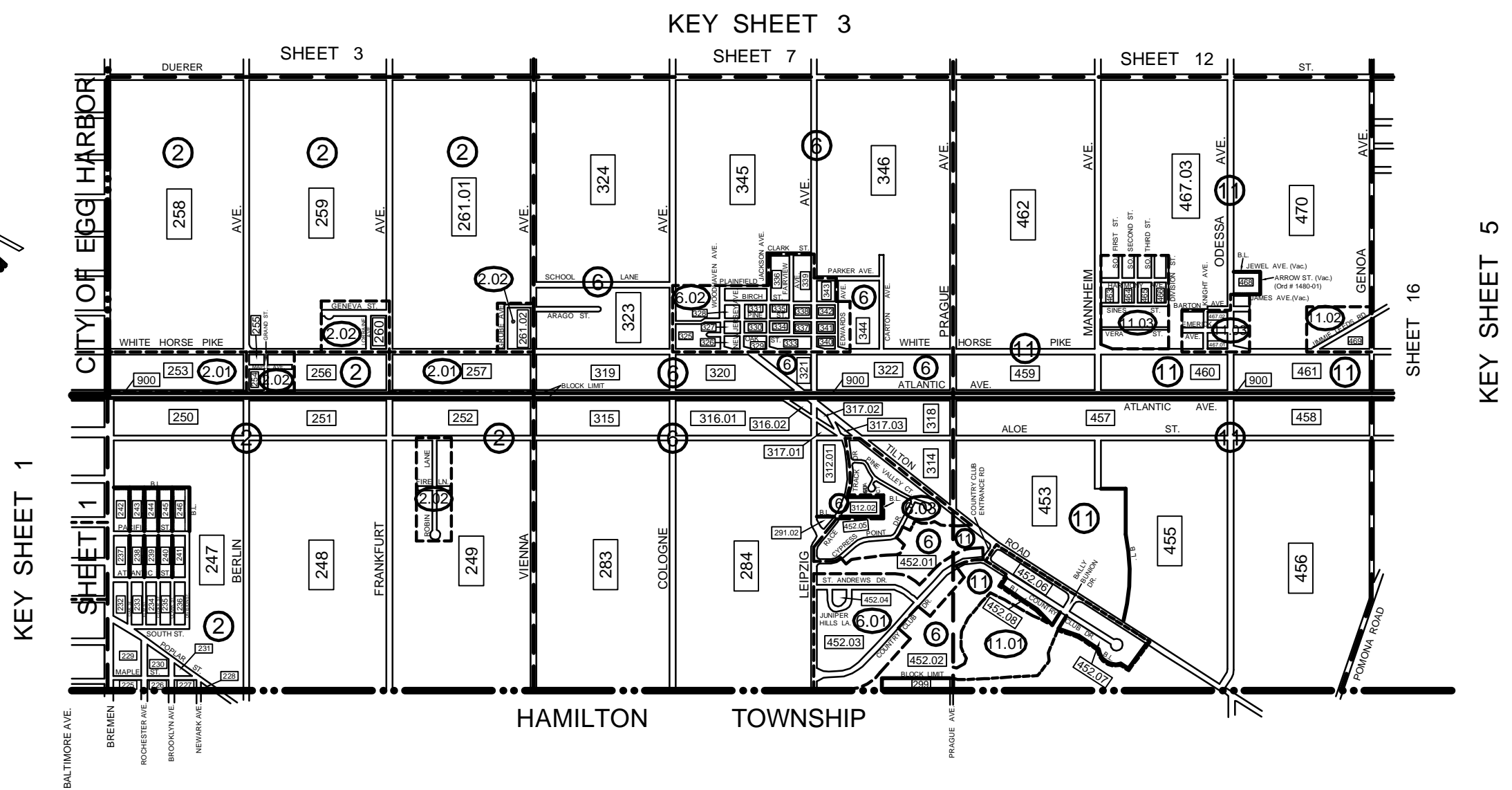
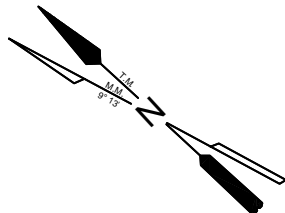

CERTIFICATION:  
 " I hereby certify that this map has been made under my immediate supervision and complies with the laws of the State of New Jersey."  
*Samuel S. Previtera*  
 SAMUEL S. PREVITERA, P.L.S. N.J. LIC. No. 38976

THIS SHEET HAS BEEN DRAWN USING COMPUTER AIDED DRAFTING / DESIGN (CAD/D) AND WAS DONE UNDER THE SUPERVISION OF SAMUEL S. PREVITERA, P.L.S., NEW JERSEY PROFESSIONAL LAND SURVEYOR LICENSE NO. 38976, AND DATED DECEMBER 31, 2006.

**TAX MAP**  
 TOWNSHIP OF GALLOWAY  
 ATLANTIC COUNTY, NEW JERSEY  
 SCALE: 1" = 1000' JANUARY 2007  
 SAMUEL S. PREVITERA, P.L.S.  
 N.J. LIC. No. 38976  
 26 NORTH ROUTE 73, SUITE 200  
 CEDAR BROOK, N.J. 08018  
 TO SHOW CONDITIONS AS OF JANUARY 1, 2007