

REVISIONS		
DATE	NAME	NO.
Aug. 2008	Dixon Assoc.	1

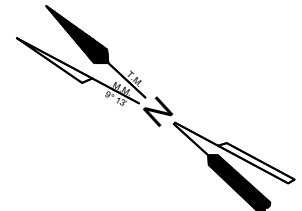
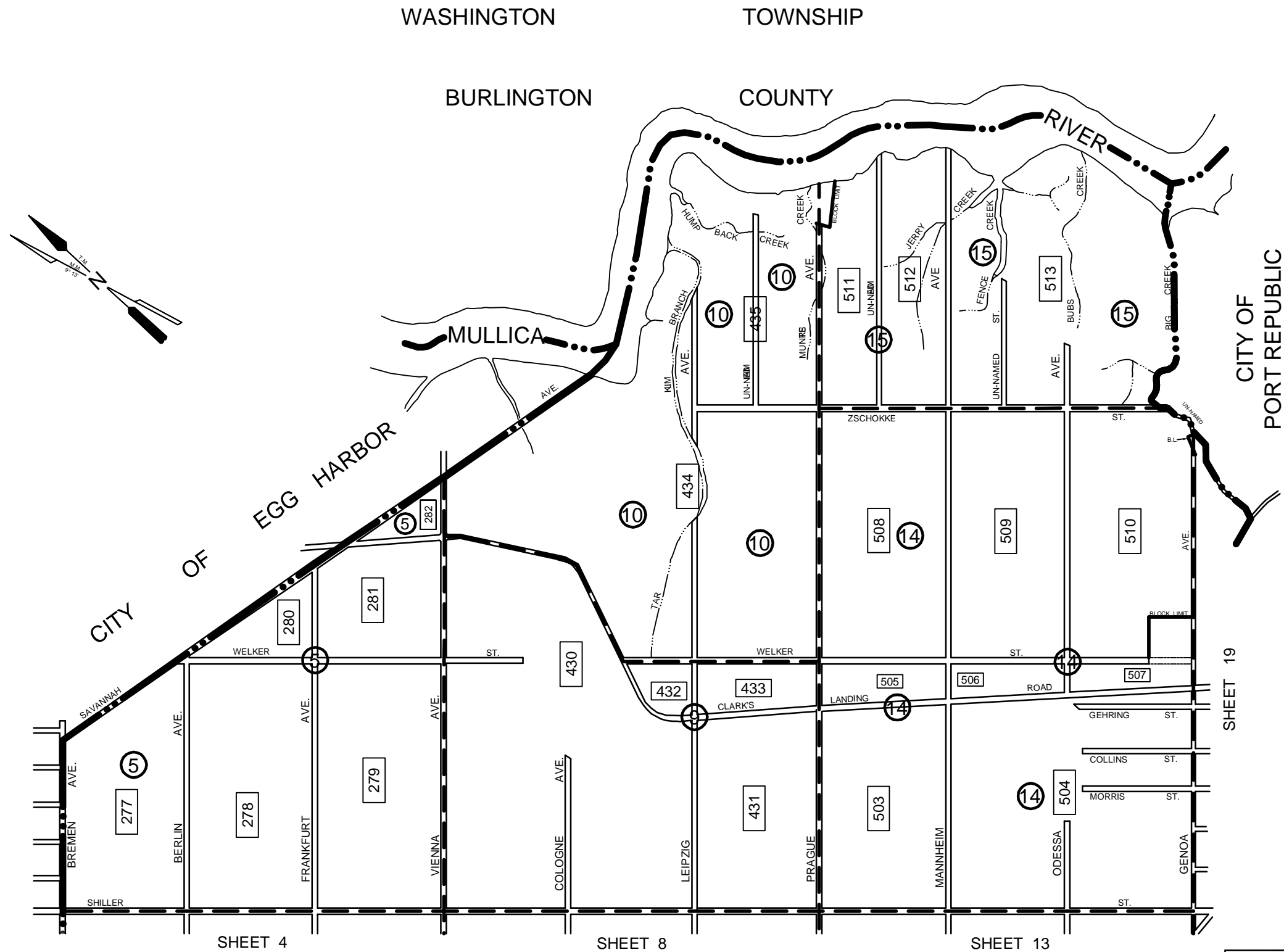

CERTIFICATION:

" I hereby certify that this map has been made under my immediate supervision and complies with the laws of the State of New Jersey."

Samuel S. Previtera
 SAMUEL S. PREVITERA, P.L.S. N.J. LIC. No. 38976

KEY SHEET 3

THIS SHEET HAS BEEN DRAWN USING COMPUTER AIDED DRAFTING / DESIGN (CADD) AND WAS DONE UNDER THE SUPERVISION OF SAMUEL S. PREVITERA, P.L.S., NEW JERSEY PROFESSIONAL LAND SURVEYOR LICENSE NO. 38976, AND DATED DECEMBER 31, 2006.

TAX MAP
TOWNSHIP OF GALLOWAY
 ATLANTIC COUNTY, NEW JERSEY
 SCALE: 1" = 1000' JANUARY 2007
SAMUEL S. PREVITERA, P.L.S.
 N.J. LIC. No. 38976
 26 NORTH ROUTE 73, SUITE 200
 CEDAR BROOK, N.J. 08018
 TO SHOW CONDITIONS AS OF JANUARY 1, 2007