

MATCH SHEET 42

MATCH SHEET 43

MATCH SHEET 44

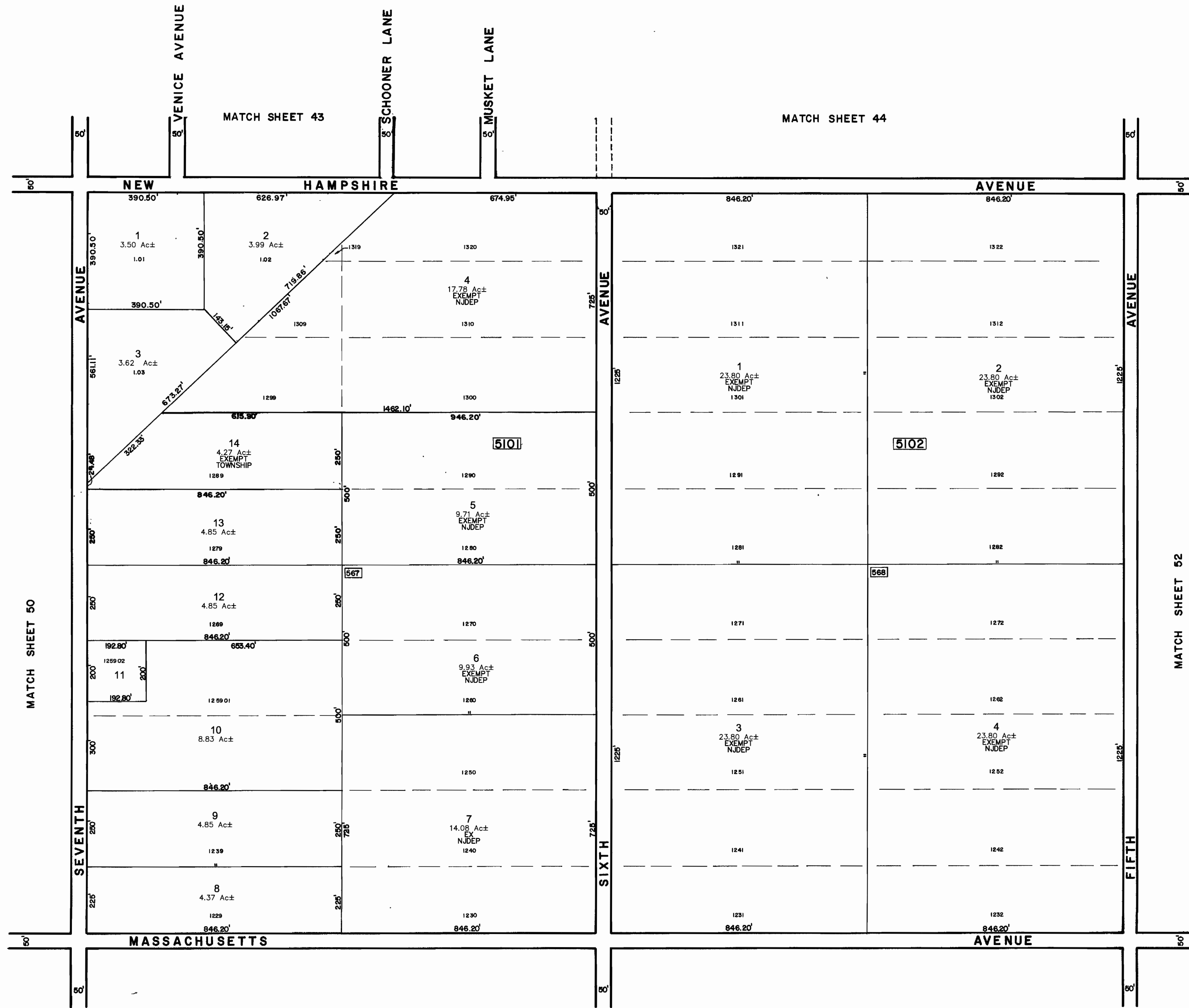

MATCH SHEET 50

MATCH SHEET 52

MATCH SHEET 59

\* THIS MAP IS A SCANNED COPY OF THE ORIGINAL MAP PREPARED BY CHRIS R. REHMANN DATED 1983. THE ORIGINAL APPROVED MAP IS ON FILE IN THE ENGINEERS OFFICE.

REVISIONS				
DATE	BY	LIC.NO	BLOCK	LOT
8/2012	ED CLAY	34842	5101	13

THIS MAP WAS FORMALLY CERTIFIED BY THE DIVISION OF TAXATION ON MARCH 14, 1984, SIGNED BY IVAN HAFTKOWITCZ AND ASSIGNED SERIAL NUMBER 630

**TAX MAP**  
**TOWNSHIP OF MULLICA**  
 ATLANTIC COUNTY NEW JERSEY  
 SCALE: 1" = 200' DATE: NOVEMBER 1983  
**CHRIS R. REHMANN**  
 PROFESSIONAL ENGINEER LAND SURVEYOR  
 NEW JERSEY LICENSE NO. 17119  
 850 SO. WHITE HORSE PIKE  
 HAMMONTON, NEW JERSEY 08037  
 COA# 24GA27973300  
 TO SHOW CONDITIONS AS OF FEBRUARY 1, 2017