

MATCH SHEET 112

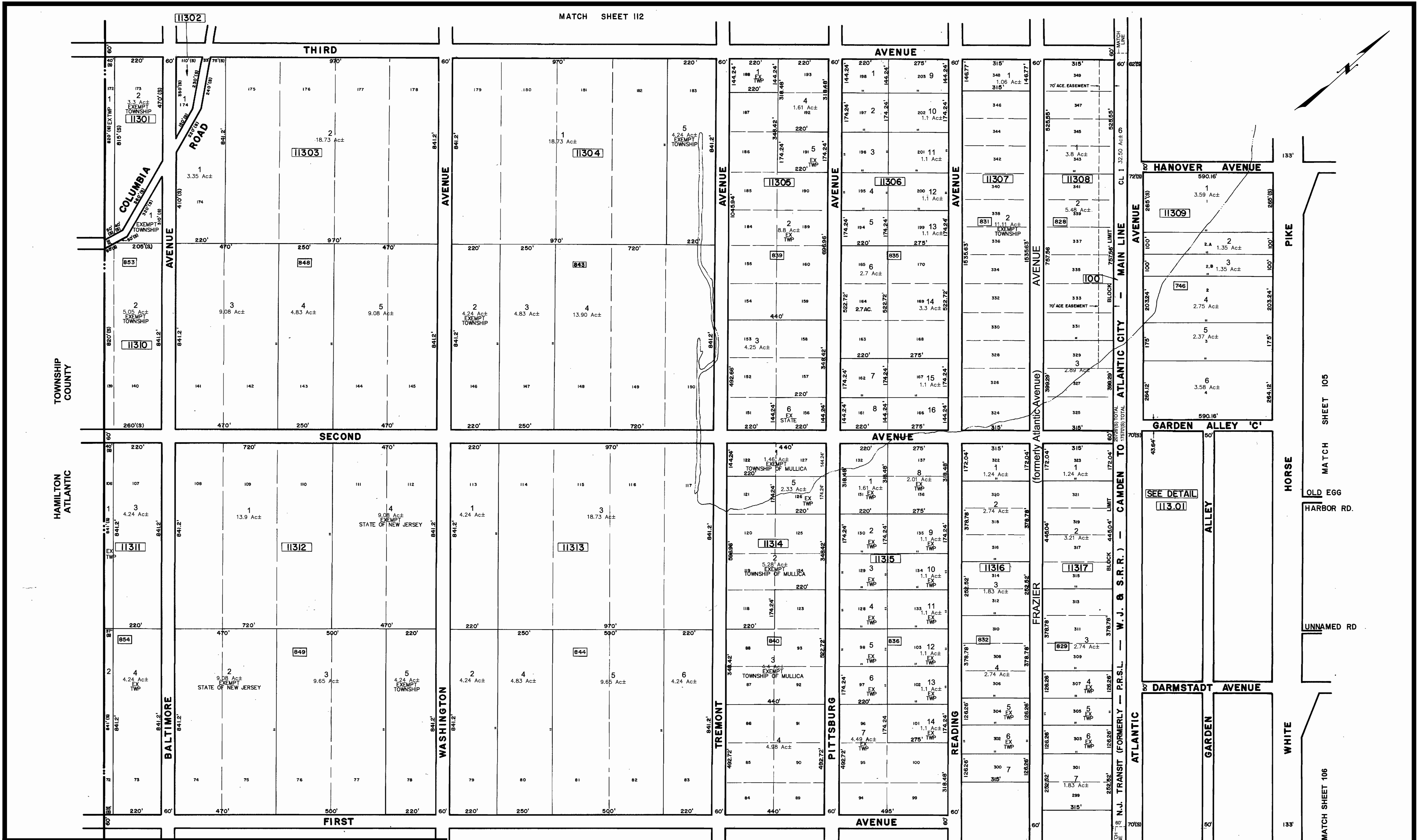

**TAX MAP
TOWNSHIP OF MULLICA**

ATLANTIC COUNTY NEW JERSEY
SCALE: 1" = 200' DATE: NOVEMBER 1983

CHRIS R. REHMANN

PROFESSIONAL ENGINEER LAND SURVEYOR
NEW JERSEY LICENSE NO. 17119
850 SO. WHITE HORSE PIKE
HAMMONTON, NEW JERSEY 08037
CO.# 24G427973300

TO SHOW CONDITIONS AS OF FEBRUARY 1, 2017

THIS MAP WAS FORMALLY
CERTIFIED BY THE
DIVISION OF TAXATION ON
MARCH 14, 1984, SIGNED
BY IVAN HAFTKOWITZ AND
ASSIGNED SERIAL NUMBER 630

REVISIONS

| DATE | BY | LIC. NO. | BLOCK | LOT |
|---------|---------|----------|-----------------------------|-----|
| 7/1991 | R.V. | | | |
| 02/2017 | ED CLAY | 34842 | Atlantic Ave to Frazier Ave | |

MATCH SHEET 114

* THIS MAP IS A SCANNED COPY OF THE ORIGINAL MAP PREPARED BY CHRIS R. REHMANN DATED 1983. THE ORIGINAL APPROVED MAP IS ON FILE IN THE ENGINEERS' OFFICE.